

State of Oregon
Department of Forestry / Department of Revenue
Notification number: 2007-771-55547 [77123151] 07 Mohawk/McKenzie Roadspray3

Attached is the processed information from the Notification of Operation and/or Application for Permits.
Please review this information and retain for future reference.

[X] - Notice is given to the State Forester that an operation will be conducted on the lands described herein (ORS 527.670).

[X] - A permit to operate power driven machinery is issued for the lands described herein (ORS 477.625)

Written plan received 5-23-07.

I. WHERE TIMBER HARVESTING IS PART OF THE PROPOSED OPERATION:

A. NOTICE TO TIMBER OWNER: Party owning the harvested timber at the point it is first measured is shown in the section marked TIMBER OWNER and is responsible for payment of Oregon timber taxes.

B. NOTICE TO LAND OWNER: Party shown in the section marked LAND OWNER is responsible for reforestation of the site if so required.

District: **South Cascade**
Office: **Eastern Lane**

County: **Lane**
WOSTOT:

Received by ODF on May 24, 2007 at 1000

15 DAY WAITING PERIOD REQUIRED

II. WRITTEN PLANS:

[X] - A WRITTEN PLAN may be required before certain activities can commence on the Operation.

A WRITTEN PLAN may be required for the situations indicated by an [X] below. A WRITTEN PLAN must be submitted or a WRITTEN WAIVER must be obtained from the State Forester before any portion of the operation may commence.

- [] - Within 100 feet of a large lake or Type F or Type D stream. [OAR 629-605-170(1)(a)]
- [] - Within 300 feet of a wildlife resource site listed in the 1984 ODF/ODFW Cooperative Agreement. [OAR 629-605-170(1)(b)]
- [] - Within 300 feet of any resource identified in the Divisions 645 or 665 of the administrative rules. [OAR 629-605-170(1)(c)]
- [] - Within 300 feet of a state or federally listed threatened or endangered wildlife resource site. [OAR 629-605-170(1)(d)]

Please contact the Oregon Department of Forestry forester named on the Unit Information sheet for further information on requirements that may be necessary to meet before any activity/operation begins.

Signed by Jeff Yost - representing the Land owner.

******* NOTICE *******

The State Forester has determined that the following items requiring your attention are located within or adjacent to your operation area:

[] - Concerns [] - Resources [X] - Water

See Unit Information on subsequent pages for details.

Operator:

Weyerhaeuser Company
PO Box 275
Springfield, OR 97477
Phone: (541) 741-5211

Land owner:

Weyerhaeuser Company
PO Box 275
Springfield, OR 97477
Phone: (541) 741-5211

Timber owner:

Phone:

Marvin D. Brown
State Forester

Lena Tucker
District Forester

(Subscriber)

Unit: 1

Status: Active

Stewardship Forester: Tim Meehan

Phone number: (541) 726-3588

Start date: 6/11/2007 End date: 12/31/2007

Site conditions: Lake or Stream within 100 ft
 Slope of 0% to 35%
 No mass soil movement

FP = L

FPA = M

Acres: Feet: 52800

Estimated harvest: MBF

Activity: Herbicide Application

Methods: Ground

Brand name: Milestone XM, Accord Conc., Garlon 4

Carrier: Water

Additives: Hasten, Competitor, Induce, R-11

App rate: None

Other information: Garlon 3A/XRT, Escort XP, Chopper, LV6

Sc	Twp	Rge	Government lot	n e	n w	s e	s w	n e	n w	s e	s w	n e	n w	s e	s w	n e	n w	s e	s w	Harv tax	Reg use
20	16S	01W										X	X	X	X	X	X	X	X		EL1
20	16S	01W										X	X	X	X	X	X	X	X		EL1
13	17S	01W		X	X	X	X														EL1
13	17S	01W		X	X	X	X														EL1
25	17S	01W		X		X	X					X		X	X	X	X	X	X		EL1
25	17S	01W		X		X	X					X		X	X	X	X	X	X		EL1
26	17S	01W														X	X		X		EL1
26	17S	01W														X			X		EL1

Water Concern Information

Description	Classification	Rule
Cartwright Creek Trib	F str-sm N str-sm WP may be required	
Cartwright Creek Trib	F str-sm N str-sm WP may be required	
Lane Creek Trib	N str-sm	
Lane Creek Trib	N str-sm	
Taylor Creek/Trib	F str-med N str-med-sm WP may be required	
Taylor Creek/Trib	F str-med N str-med-sm WP may be required	
McKenzie River Trib	N str-sm	
McKenzie River Trib	N str-sm	

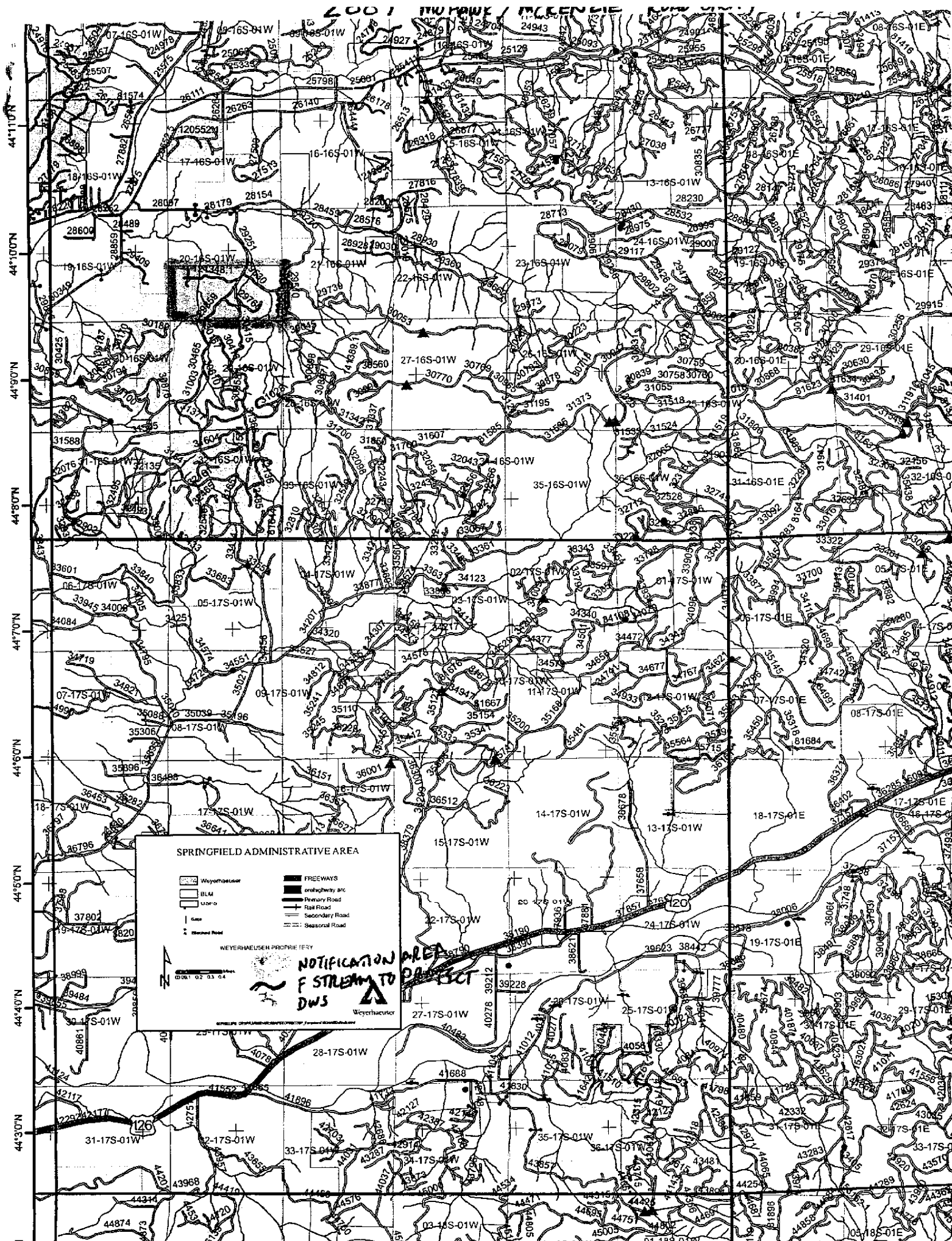

SPRINGFIELD ADMINISTRATIVE AREA

WEYERHAEUSER PROPERTY

NOTIFICATION OF STREAM TO DWS

SPRINGFIELD OVERLAYS AND SUPPORTS THE FOLLOWING: Forest, Wetlands, etc.



PO Box 275
Springfield OR 97477
Tel (541) 746-2511

Rec'd 5-18-07

WRITTEN PLAN OF OPERATION FOR 2007 SPRINGFIELD ROADSIDE HERBICIDE APPLICATION

Weyerhaeuser Company is planning roadside/road surface spray applications targeting broadleaf and/or herbaceous vegetation near protected resources on portions of the Springfield Operating Area hi-lighted on the map submitted to ODF. This letter is our submission of a written plan of operation for activities within 100 feet of protected resources. Chemical will not be mixed or loaded within 100 feet of protected resources.

No herbicide will be directly applied within 10 feet of the high water mark of any protected resource defined as F or D stream, lakes, significant wetlands and other areas of standing open water greater than one-quarter acre at the time of application. Protected resource status will also be given to "unknown streams" shown on map. All application will be done in compliance with the Oregon Forest Practices Rules and label instructions.

Landowner will identify the above-protected resources with crew foreman prior to application by means of aerial photos, maps and/or ground visits to provide operator with adequate information to properly treat the area.

Operation name 2007 MOHAWK/MCKENZIE ROAD SPRAY #3
Notification #(s) 127 - PENDING

Sincerely,

Jeff Yost, Forester
Springfield Area

5/23/07

Operator

Date

Forest Practices Forester

Date