

State of Oregon
Department of Forestry / Department of Revenue
Notification number: 2007-781-50397 [78127285]

Attached is the processed information from the Notification of Operation and/or Application for Permits.

Please review this information and retain for future reference.

[X] - Notice is given to the State Forester that an operation will be conducted on the lands described herein (ORS 527.670).

n; historic site

I. WHERE TIMBER HARVESTING IS PART OF THE PROPOSED OPERATION:

A. NOTICE TO TIMBER OWNER: Party owning the harvested timber at the point it is first measured is shown in the section marked TIMBER OWNER and is responsible for payment of Oregon timber taxes.

B. NOTICE TO LAND OWNER: Party shown in the section marked LAND OWNER is responsible for reforestation of the site if so required.

II. WRITTEN PLANS:

[X] - A WRITTEN PLAN may be required before certain activities can commence on the Operation.

A WRITTEN PLAN may be required for the situations indicated by an [X] below. A WRITTEN PLAN must be submitted or a WRITTEN WAIVER must be obtained from the State Forester before any portion of the operation may commence.

[X] - Within 100 feet of a large lake or Type F or Type D stream.
[OAR 629-605-170(1)(a)]

[] - Within 300 feet of a wildlife resource site listed in the 1984 ODF/ODFW Cooperative Agreement. [OAR 629-605-170(1)(b)]

[] - Within 300 feet of any resource identified in the Divisions 645 or 665 of the administrative rules. [OAR 629-605-170(1)(c)]

[] - Within 300 feet of a state or federally listed threatened or endangered wildlife resource site. [OAR 629-605-170(1)(d)]

Please contact the Oregon Department of Forestry forester named on the Unit Information sheet for further information on requirements that may be necessary to meet before any activity/operation begins.

Signed by **Brett Wisely** - representing the Operator.

District: **Western Lane**
Office: **Veneta**

County: **Lane**
WOSTOT:

Received by ODF on April 3, 2007 at 1518

15 DAY WAITING PERIOD REQUIRED

**** Waiver Requested ****

******* NOTICE *******

The State Forester has determined that the following items requiring your attention are located within or adjacent to your operation area:

[X] - Concerns **[X]** - Resources **[X]** - Water

See Unit Information on subsequent pages for details.

Operator:

Menasha Forest Management Service
29772 Clear Lake Road
Eugene, OR 97404

Phone: (541) 688-1900

Land owner:

Rosboro Lumber Company, LLC
P. O. Box 20
Springfield, OR 97477

Phone: 746-8411

Timber owner:

Phone:

Marvin D. Brown
State Forester

Rick Rogers
District Forester

(Subscriber)

Unit: 1

Status: Active

Stewardship Forester: Jim Hall

Phone number: (541) 997-8713

Start date: 4/16/2007

End date: 12/31/2007

Site conditions: No Protected Waters within 100 ft

FP = L

Slope of 0% to 35%

No mass soil movement

FPA = L

Acres: 130

Feet:

Estimated harvest: MBF

Activity: Herbicide Application

Methods: Ground

Brand name: Triclopyr Ester; Arsenal; Oil

Carrier: None

Additives: None

App rate: None

Sc	Twp	Rge	Government lot	N E				N W				S W				S E				Harv tax	Reg use
				n	n	s	s	n	n	s	s	n	n	s	s	n	n	s	s		
25	16S	09W												X							SL2
26	16S	09W																	X		SL2
35	16S	09W		X			X														SL2
36	16S	09W						X	X												SL2

Water Concern Information

Description

Classification

Rule

Deadwood Creek Tribs

Unknown class

Unit: 2

Status: Active

Stewardship Forester: Jim Hall / Ole Buch Phone number: (541) 997-8713

Start date: 4/16/2007 End date: 12/31/2007

Site conditions: No Protected Waters within 100 ft
 Slope of 0% to 35%
 No mass soil movement

FP = L

FPA = L

Acres: 2240

Feet:

Estimated harvest: MBF

Activity: Herbicide Application

Methods: Ground

Brand name: See Unit 1

Carrier: None

Additives: None

App rate: None

Sc	Twp	Rge	Government lot	N E				N W				S W				S E				Harv tax	Reg use
				n	n	s	s	n	n	s	s	n	n	s	s	n	n	s	s		
06	17S	08W				X	X			X	X	X	X	X	X	X	X	X	X		WT1
07	17S	08W		X	X	X	X	X	X	X	X	X	X	X	X	X	X	X	X		WT1
08	17S	08W		X	X	X	X	X	X	X	X										WT1
18	17S	08W								X											WT1
01	17S	09W														X		X	X		WT1
11	17S	09W					X		X	X		X	X		X	X	X	X	X		WT1
13	17S	09W		X	X																WT1
14	17S	09W		X	X			X	X												WT1
12	17S	09W		X	X	X	X	X	X	X	X	X	X	X	X	X	X	X	X		WT1

Special Concerns

Code Description

Comment

SH Scenic Highway

Water Concern Information

Description

Classification

Rule

Lake Creek

F str-lg-dom use Mand written plan

170a

Hollo Creek

F str-med-sm Mand written plan

170a

Almosie Cr. MF, UK - Johnston Cr. SF, SN, UK
 Protected Resources Information

Code Description

Comment

Rule

MUR Marbled Murrelet Nest Site

NSO Northern Spotted Owl Site

210

Unit: 3Status: **Active**Stewardship Forester: **Jim Hall**Phone number: **(541) 997-8713**Start date: **4/16/2007**End date: **12/31/2007**

Site conditions: **No Protected Waters within 100 ft**
Slope of 0% to 35%
No mass soil movement

FP = L

FPA = L

Acres: **240**

Feet:

Estimated harvest: MBF

Activity: **Herbicide Application**Methods: **Ground**Brand name: **See Unit 1**Carrier: **None**Additives: **None**App rate: **None**

Sc	Twp	Rge	Government lot	N E				N W				S W				S E				Harv tax	Reg use
				n	n	s	s	n	n	s	s	n	n	s	s	n	n	s	s		
				e	w	w	e	e	w	w	e	e	w	w	e	e	w	w	e		
13	17S	09W										X	X	X	X			X	X		WT1

Water Concern Information

Description	Classification	Rule
-------------	----------------	------

Lake Creek Tribs	Unknown class	
------------------	---------------	--

Protected Resources Information

Code	Description	Comment	Rule
------	-------------	---------	------

NSO	Northern Spotted Owl Site	May require written plan	210
-----	---------------------------	--------------------------	-----

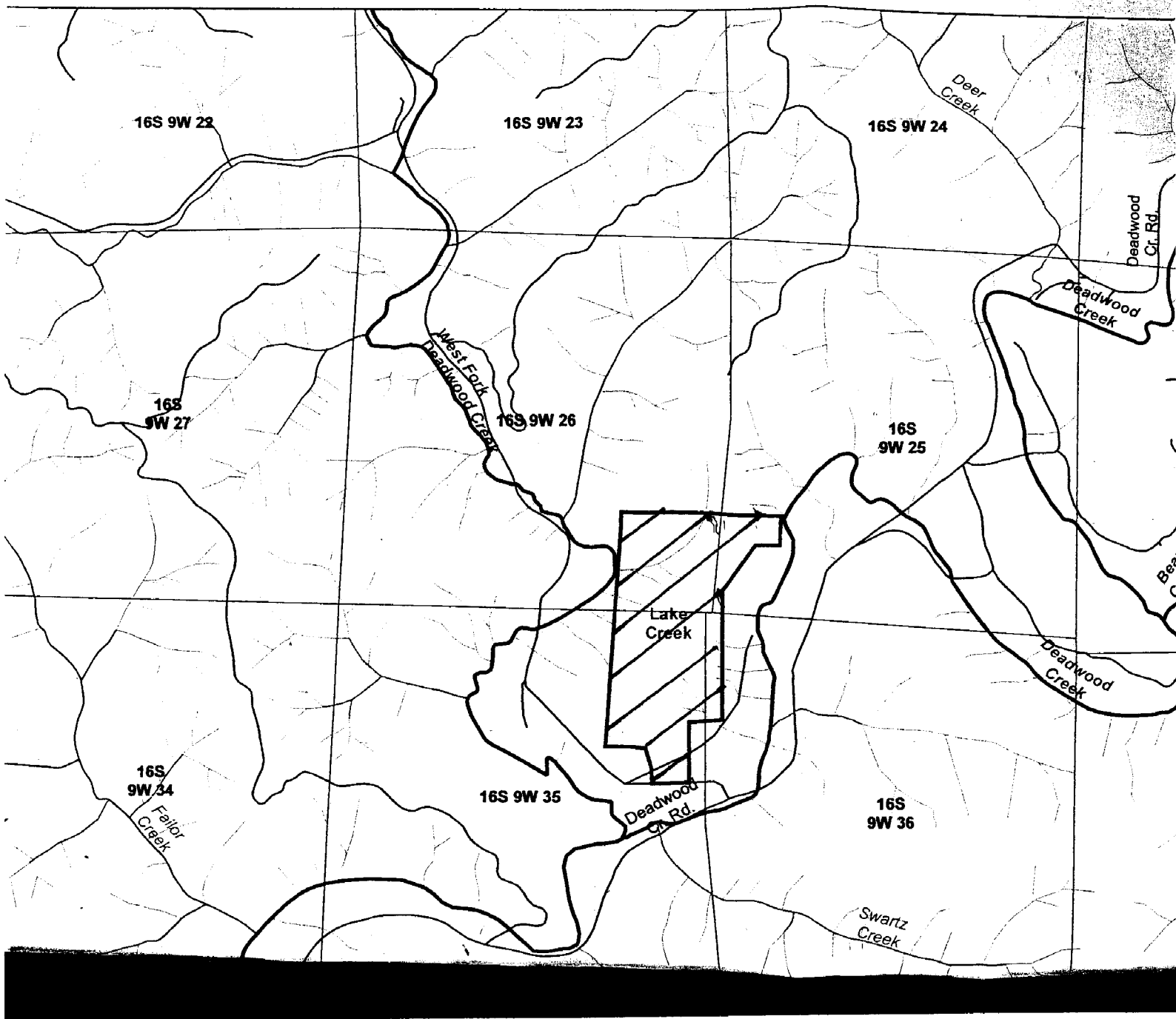

 - UNIT 1

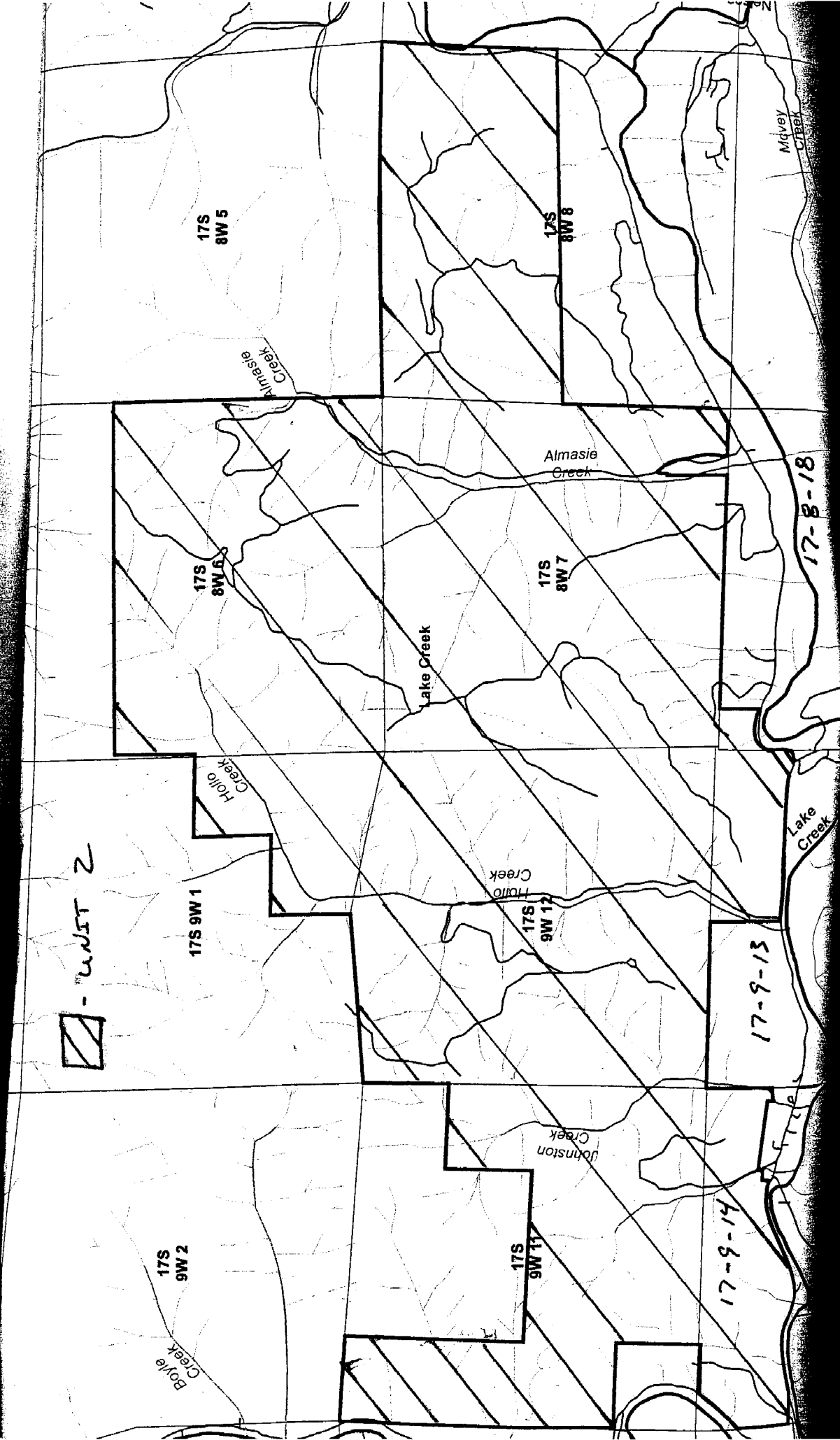

UNIT 2

17S
9W 2
Boyle
Creek

17S 9W 1

17S
8W 6

17S
8W 5

Hollis
Creek

Almasie
Creek

Lake
Creek

17S
9W 11

17S
9W 12
Hollis
Creek

Johnston
Creek

17S
8W 7

Almasie
Creek

17S
8W 8

17-8-14

17-8-13

17-8-18

Mcvey
Creek

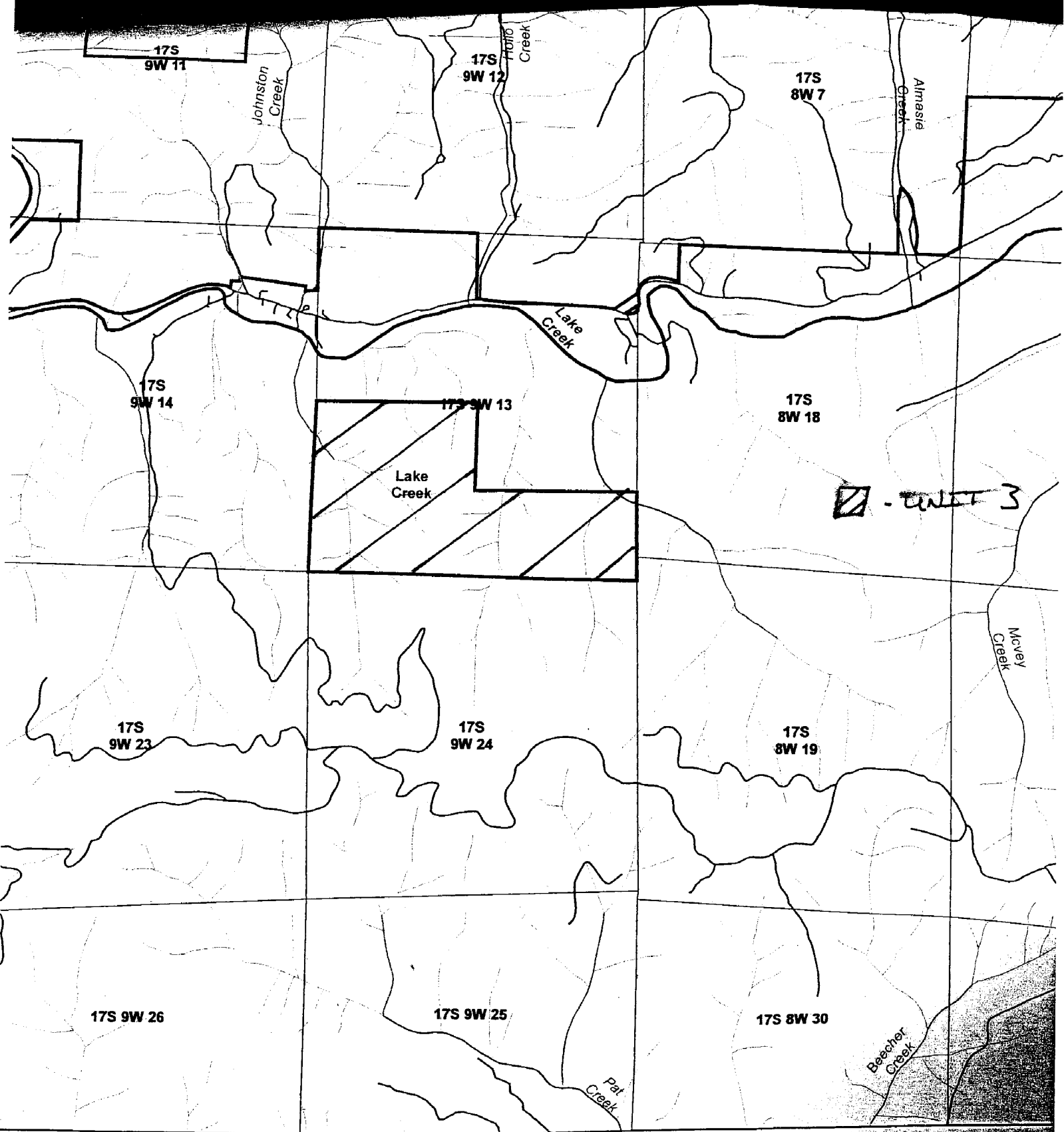

Utilities
PIPELINES
POWERLINES

Scale 1:24,000

0 1,250 2,500 5,000 7,500 10,000 Feet