

State of Oregon
Department of Forestry / Department of Revenue
Notification number: 2008-771-55208 [77123881] Swearingen

Attached is the processed information from the Notification of Operation and/or Application for Permits.
Please review this information and retain for future reference.

- Notice is given to the State Forester that an operation will be conducted on the lands described herein (ORS 527.670).
- A permit to operate power driven machinery is issued for the lands described herein (ORS 477.625)

I. WHERE TIMBER HARVESTING IS PART OF THE PROPOSED OPERATION:

A. NOTICE TO TIMBER OWNER: Party owning the harvested timber at the point it is first measured is shown in the section marked TIMBER OWNER and is responsible for payment of Oregon timber taxes.

B. NOTICE TO LAND OWNER: Party shown in the section marked LAND OWNER is responsible for reforestation of the site if so required.

District: **South Cascade**
Office: **Eastern Lane**

County: **Lane**
WOSTOT:

Received by ODF on March 6, 2008 by fax

15 DAY WAITING PERIOD REQUIRED

II. WRITTEN PLANS:

- A WRITTEN PLAN may be required before certain activities can commence on the Operation.

A WRITTEN PLAN may be required for the situations indicated by an below. A WRITTEN PLAN must be submitted or a WRITTEN WAIVER must be obtained from the State Forester before any portion of the operation may commence.

- Within 100 feet of a large lake or Type F or Type D stream. [OAR 629-605-170(1)(a)]
- Within 300 feet of a wildlife resource site listed in the 1984 ODF/ODFW Cooperative Agreement. [OAR 629-605-170(1)(b)]
- Within 300 feet of any resource identified in the Divisions 645 or 665 of the administrative rules. [OAR 629-605-170(1)(c)]
- Within 300 feet of a state or federally listed threatened or endangered wildlife resource site. [OAR 629-605-170(1)(d)]

Please contact the Oregon Department of Forestry forester named on the Unit Information sheet for further information on requirements that may be necessary to meet before any activity/operation begins.

signed by Bryan Nelson - representing the Land owner.

******* NOTICE *******

The State Forester has determined that the following items requiring your attention are located within or adjacent to your operation area:

- Concerns - Resources - Water

See Unit Information on subsequent pages for details.

Operator:

Western Helicopter Services, Inc.
P.O. Box 369
Newberg, OR 97132
Phone: (503) 538-9469

Land owner:

Lone Rock Timber Co.
P.O. Box 1127
Roseburg, OR 97470
Phone: (541) 673-0141

Timber owner:

Phone:

Marvin D. Brown
State Forester

Lena Tucker
District Forester

Unit: 1

Status: Active

Stewardship Forester: Tim Meehan

Phone number: (541) 726-3588

Start date: 3/19/2008

End date: 12/31/2008

Site conditions: Lake or Stream within 100 ft
 Slope of 35% to 65%
 No mass soil movement

FP = L

FPA = M

Acres: 233

Feet:

Estimated harvest: MBF

Activity: Herbicide Application

Methods: Aerial

Brand name: 2# Velpar DF, 16 Tahoe

Carrier: Water

Additives: None

App rate: None

Sc	Twp	Rge	Government lot	N E				N W				S W				S E				Harv tax	Reg use	
				n	n	s	s	n	n	s	s	n	n	s	s	n	n	s	s			
13	17S	02W				X				X	X	X						X				EL1
13	17S	02W				X				X	X	X						X				EL1
14	17S	02W						X			X	X					X	X	X	X		EL1
14	17S	02W						X			X	X					X	X	X	X		EL1
22	17S	02W		X	X	X																EL1
22	17S	02W		X	X	X																EL1

Water Concern Information

Description	Classification	Rule
Camp Creek Trib	F str-sm N str-sm WP	may be required
Camp Creek Trib	F str-sm N str-sm WP	may be required

Lone Rock Timberlands Management Co.
 Roseburg, Or.
 Swearingen
 T 17S, R 2W, Sec. 14

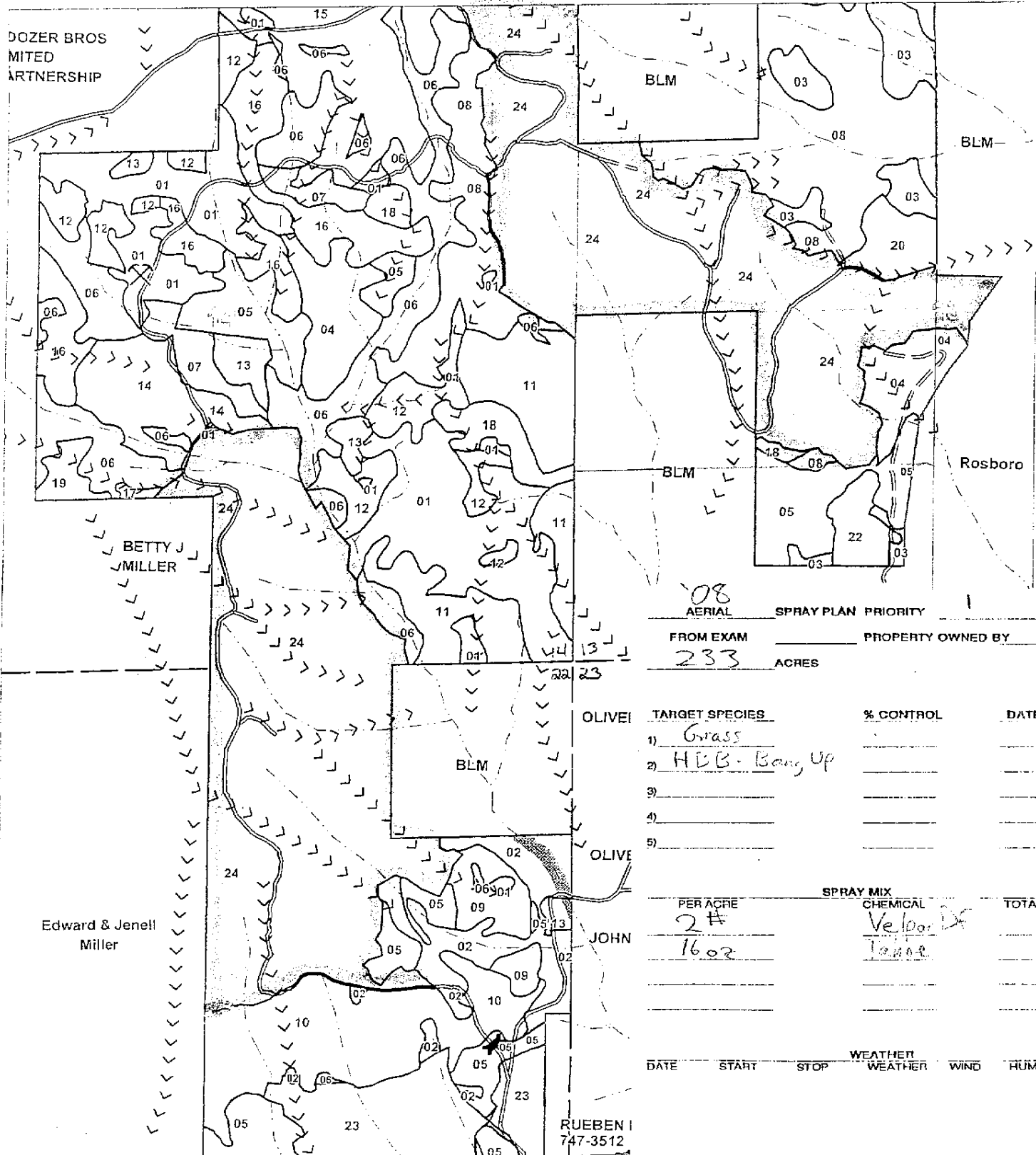
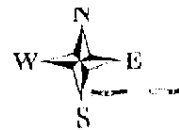

08
 AERIAL SPRAY PLAN PRIORITY
 FROM EXAM PROPERTY OWNED BY
 233 ACRES

OLIVE	TARGET SPECIES	% CONTROL	DATE
1)	Grass		
2)	HBB - Bang Up		
3)			
4)			
5)			

PER ACRE	SPRAY MIX	CHEMICAL	TOTAL
2#		Velbar Df	
16.02		Tangle	

DATE	START	STOP	WEATHER	WEATHER	WIND	HUM	TEMP

RUEBEN I
 747-3512

1 inch = 1000 feet

PILOT/CONTRACTOR _____
 LONE ROCK REPRESENTATIVE _____