

State of Oregon  
Department of Forestry / Department of Revenue  
Notification number: 2008-771-55777 [77124450] Blackberry Backpack Control

Attached is the processed information from the Notification of Operation and/or Application for Permits.

Please review this information and retain for future reference.

- Notice is given to the State Forester that an operation will be conducted on the lands described herein (ORS 527.670).

---

All areas to treat greater than 100' from any fish creeks.

---

I. WHERE TIMBER HARVESTING IS PART OF THE PROPOSED OPERATION:

A. NOTICE TO TIMBER OWNER: Party owning the harvested timber at the point it is first measured is shown in the section marked TIMBER OWNER and is responsible for payment of Oregon timber taxes.

B. NOTICE TO LAND OWNER: Party shown in the section marked LAND OWNER is responsible for reforestation of the site if so required.

District: **South Cascade**  
Office: **Eastern Lane**

County: **Lane**  
WOSTOT:

Received by ODF on October 8, 2008 by fax

---

**\*15 DAY WAITING PERIOD REQUIRED\***

**\*\* Waiver Requested \*\***

---

II. WRITTEN PLANS:

- A WRITTEN PLAN may be required before certain activities can commence on the Operation.

A WRITTEN PLAN may be required for the situations indicated by an  below. A WRITTEN PLAN must be submitted or a WRITTEN WAIVER must be obtained from the State Forester before any portion of the operation may commence.

- Within 100 feet of a large lake or Type F or Type D stream. [OAR 629-605-170(1)(a)]

- Within 300 feet of a wildlife resource site listed in the 1984 ODF/ODFW Cooperative Agreement. [OAR 629-605-170(1)(b)]

- Within 300 feet of any resource identified in the Divisions 645 or 665 of the administrative rules. [OAR 629-605-170(1)(c)]

- Within 300 feet of a state or federally listed threatened or endangered wildlife resource site. [OAR 629-605-170(1)(d)]

\*\*\*\*\* N O T I C E \*\*\*\*\*

The State Forester has determined that the following items requiring your attention are located within or adjacent to your operation area:

- Concerns  - Resources  - Water

See Unit Information on subsequent pages for details.

Operator:

Strata Forestry, Inc.  
100 W. Q Street  
Springfield, OR 97477  
Phone: ( 541 ) 726-0845

Land owner:

Giustina Resources Limited Partne  
P O Box 529  
Eugene, OR 97440  
Phone: ( 541 ) 485-1500

Timber owner:

Phone:

Marvin D. Brown  
State Forester

Lena Tucker  
District Forester

(Subscriber)

Unit: 1 Status: Active  
 Stewardship Forester: Marvin Vetter  
 Start date: 10/09/2008 End date: 12/31/2008

Phone number: (541) 726-3588

Site conditions: No Protected Waters within 100 ft FP = L  
 Slope of 0% to 35%  
 No mass soil movement FPA = L

Acres: 44 Feet: Estimated harvest: MBF  
 Activity: Herbicide Application  
 Methods: Ground  
 Brand name: Garlon Or Escort Carrier: Water  
 Additives: Hasten App rate: None

Sc	Twp	Rge	Government lot	N E				N W				S W				S E				Harv tax	Reg use	
				n e	n w	s w	s e	n e	n w	s w	s e	n e	n w	s w	s e	n e	n w	s w	s e			
22	19S	01W						X	X	X	X											EL1
22	19S	01W						X	X	X	X											EL1

Water Concern Information

Description	Classification	Rule
Dexter Reservoir Trib	N str-sm	
Dexter Reservoir Trib	N str-sm	

# LOST CREEK NORTH BACKPACK BLACKBERRY TREATMENT

## C22 GATEVIEW & CAMP SX

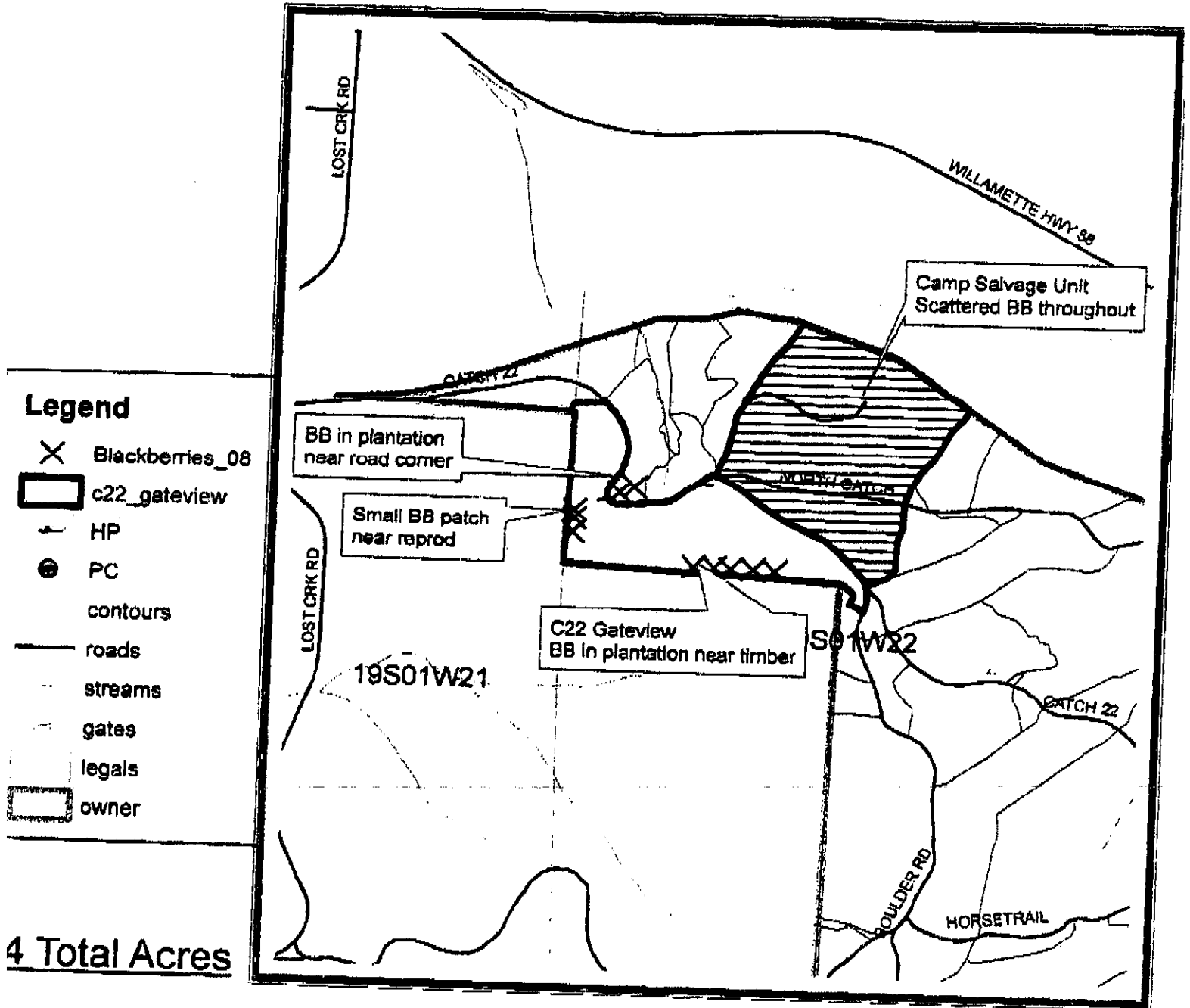

1:12,000

Exhibit A-5

JRS  
October 07, 2008

