

State of Oregon
Department of Forestry / Department of Revenue
Notification number: 2008-781-50172 [78128221]

Attached is the processed information from the Notification of Operation and/or Application for Permits.

Please review this information and retain for future reference.

- Notice is given to the State Forester that an operation will be conducted on the lands described herein (ORS 527.670).

- A permit to operate power driven machinery is issued for the lands described herein (ORS 477.625)

historic site

I. WHERE TIMBER HARVESTING IS PART OF THE PROPOSED OPERATION:

A. NOTICE TO TIMBER OWNER: Party owning the harvested timber at the point it is first measured is shown in the section marked TIMBER OWNER and is responsible for payment of Oregon timber taxes.

B. NOTICE TO LAND OWNER: Party shown in the section marked LAND OWNER is responsible for reforestation of the site if so required.

District: **Western Lane**
Office: **Veneta**

County: **Lane**
WOSTOT:

Received by ODF on February 29, 2008 by mail.

15 DAY WAITING PERIOD REQUIRED

II. WRITTEN PLANS:

- A WRITTEN PLAN may be required before certain activities can commence on the Operation.

A WRITTEN PLAN may be required for the situations indicated by an below. A WRITTEN PLAN must be submitted or a WRITTEN WAIVER must be obtained from the State Forester before any portion of the operation may commence.

- Within 100 feet of a large lake or Type F or Type D stream. [OAR 629-605-170(1)(a)]

- Within 300 feet of a wildlife resource site listed in the 1984 ODF/ODFW Cooperative Agreement. [OAR 629-605-170(1)(b)]

- Within 300 feet of any resource identified in the Divisions 645 or 665 of the administrative rules. [OAR 629-605-170(1)(c)]

- Within 300 feet of a state or federally listed threatened or endangered wildlife resource site. [OAR 629-605-170(1)(d)]

Please contact the Oregon Department of Forestry forester named on the Unit Information sheet for further information on requirements that may be necessary to meet before any activity/operation begins.

Signed by **Scott Ferguson** - representing the Land owner.

******* NOTICE *******

The State Forester has determined that the following items requiring your attention are located within or adjacent to your operation area:

- Concerns - Resources - Water

See Unit Information on subsequent pages for details.

Operator:

Western Helicopter Services, Inc
P.O. Box 369
Newberg, OR 97132
Phone: (503) 538-9469

Land owner:

Linde Kester
Kester Family Trust
80772 Hawley Creek Rd
Cottage Grove, OR 97424
Phone: (541) 942-9264

Timber owner:

Phone:

Marvin D. Brown
State Forester

Dave Lorenz
District Forester

(Subscriber)

Unit: 1 Status: Active
 Stewardship Forester: Robert Johnson
 Start date: 3/17/2008 End date: 3/17/2008

Phone number: (541) 935-2283

Site conditions: Lake or Stream within 100 ft.
 Slope of 0% to 35%
 No mass soil movement

FP = L

FPA = H

Acres: 169 Feet: Estimated harvest: MBF
 Activity: Herbicide Application
 Methods: Aerial
 Brand name: Westar Carrier: None
 Additives: None App rate: None

Sc	Twp	Rge	Government lot	NE				NW				SW				SE				Harv tax	Reg use
				n	n	s	s	n	n	s	s	n	n	s	s	n	n	s	s		
01	20S	05W		X			X									X			X		WT1
12	20S	05W		X																	WT1
06	20S	04W								X	X	X						X			WT1
07	20S	04W			X			X	X												WT1

Water Concern Information

Description	Classification	Rule
Hawley Creek	F str-lg Mand written plan	170a
N Fk Siuslaw	F str-sm Unknown class Mand written plan	170a

Christofferson

Kester Ranch.
Sections 14R 20S, 5W
Sections 617 20S, 4W

OUT

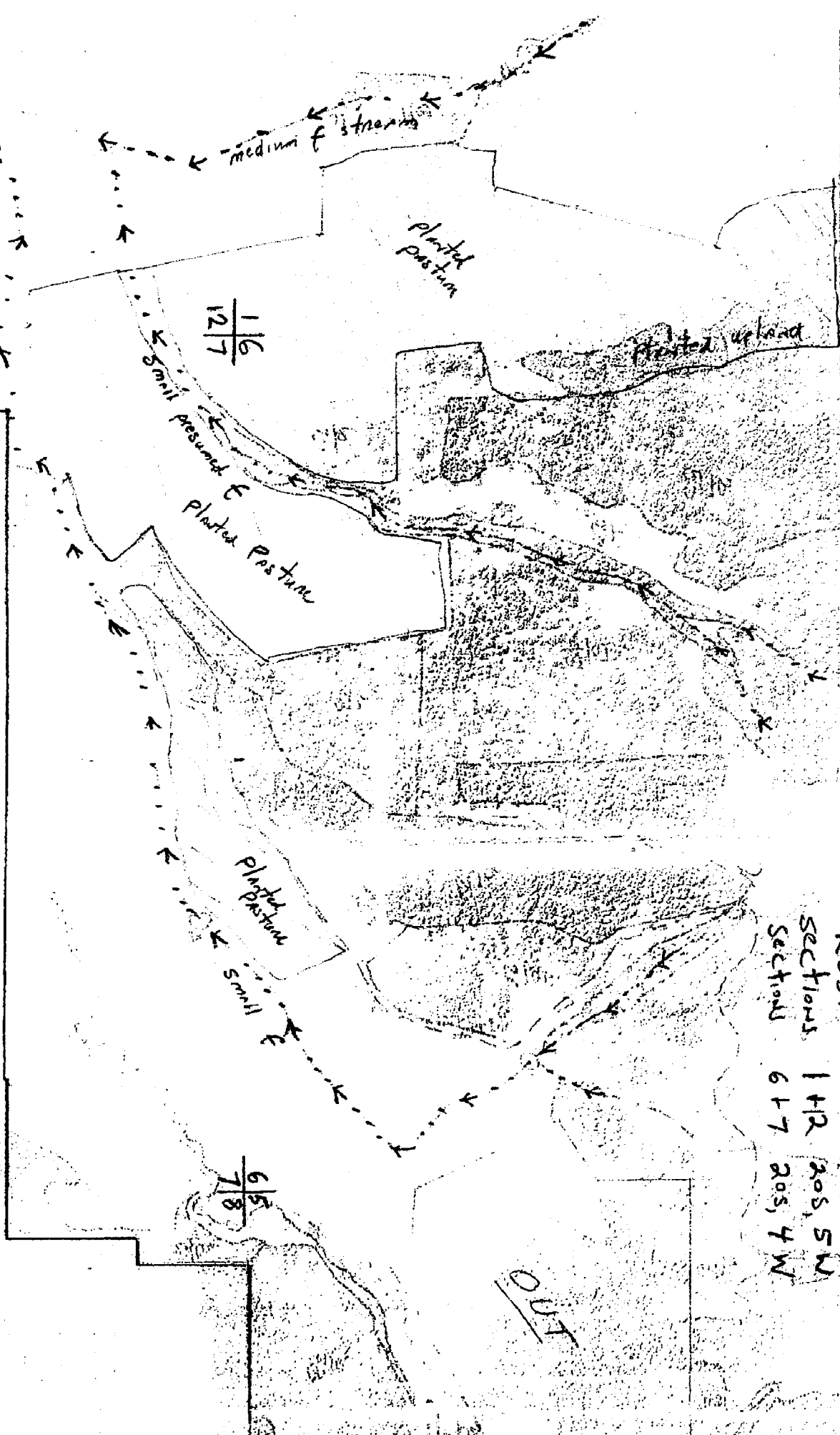

Scale: 1" = ± 800'



Bob Johnson
Or. Department of Forestry
P.O. Box 157
Veneta, OR 97487

February 27, 2008

Written Plan for Aerial Herbicide Application

Protected Resource: Hawley Creek Tributaries, small streams, assumed to have fish.

Location: Kester Ranch, Section 1 & 12 T20S, R5W & Sections 6 & 7 20S, R4W

I'm writing with regard to our plan to apply grass control herbicides on planted pastureland adjacent to the small, assumed fishbearing streams referenced above.

1.5 pounds per acre of Westar herbicide will be applied by helicopter for control of grass according to EPA label requirements.

In the aerial application, all streams will have a flagged, 50 foot buffer that will not be sprayed. The helicopter will fly parallel to the streams when applying alongside buffer strips.

On the day of the application, air temperature, relative humidity and wind velocity and direction will be measured and recorded before start of the operation and hourly until completion. All EPA and ODF requirements for wind, temperature and humidity limits will be followed.

Please let me know if we need to take any other precautions.

Sincerely,

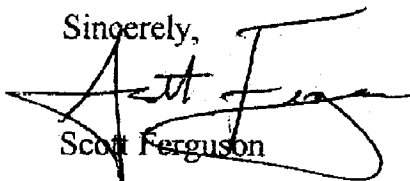

Scott Ferguson