

State of Oregon
Department of Forestry / Department of Revenue
Notification number: 2008-781-50274 [78128323]

Attached is the processed information from the Notification of Operation and/or Application for Permits.

Please review this information and retain for future reference.

- Notice is given to the State Forester that an operation will be conducted on the lands described herein (ORS 527.670).
- A permit to operate power driven machinery is issued for the lands described herein (ORS 477.625)
- A notice is given to the State Forester and the Department of Revenue of the intent to harvest timber (ORS 321.550).

N

I. WHERE TIMBER HARVESTING IS PART OF THE PROPOSED OPERATION:

District: **Western Lane**

Office: **Veneta**

A. NOTICE TO TIMBER OWNER: Party owning the harvested timber at the point it is first measured is shown in the section marked TIMBER OWNER and is responsible for payment of Oregon timber taxes.

County: **Lane**

WOSTOT:

B. NOTICE TO LAND OWNER: Party shown in the section marked LAND OWNER is responsible for reforestation of the site if so required.

Received by ODF on April 4, 2008 at 1230

15 DAY WAITING PERIOD REQUIRED

II. WRITTEN PLANS:

- A WRITTEN PLAN may be required before certain activities can commence on the Operation.

A WRITTEN PLAN may be required for the situations indicated by an below. A WRITTEN PLAN must be submitted or a WRITTEN WAIVER must be obtained from the State Forester before any portion of the operation may commence.

- Within 100 feet of a large lake or Type F or Type D stream. [OAR 629-605-170(1)(a)]

- Within 300 feet of a wildlife resource site listed in the 1984 ODF/ODFW Cooperative Agreement. [OAR 629-605-170(1)(b)]

- Within 300 feet of any resource identified in the Divisions 645 or 665 of the administrative rules. [OAR 629-605-170(1)(c)]

- Within 300 feet of a state or federally listed threatened or endangered wildlife resource site. [OAR 629-605-170(1)(d)]

******* NOTICE *******

The State Forester has determined that the following items requiring your attention are located within or adjacent to your operation area:

- Concerns - Resources - Water

See Unit Information on subsequent pages for details.

Operator:
Daniel Klemp

P O Box 51
Blachly, OR 97412
Phone: (541) 927-6181

Land owner:
Daniel Klemp

P O Box 51
Blachly, OR 97412
Phone: (541) 927-6181

Timber owner:
Daniel Klemp

P O Box 51
Blachly, OR 97412
Phone: (541) 927-6181

Marvin D. Brown Dave Lorenz
State Forester District Forester

Please contact the Oregon Department of Forestry forester named on the Unit Information sheet for further information on requirements that may be necessary to meet before any activity/operation begins.

Signed by **Daniel Klemp** - representing the Land owner.

(Subscriber)

Unit: 1

Status: **Active**

Stewardship Forester: **Paul Clements**

Phone number: **(541) 935-2283**

Start date: **4/21/2008**

End date: **12/31/2008**

Site conditions: **Lake or Stream within 100 ft**
Slope of 0% to 35%
No mass soil movement

FP = H

FPA = H

Acres: **20**

Feet:

Estimated harvest: **200** MBF

Activity: **Clear cut Herbicide Application Treatment of Slashing**

Methods: **Ground, Pressurized Broadcast, Burnin**

Brand name: **Glyphosate 41 Percent, Garlon 4**

Carrier: **None**

Additives: **None**

App rate: **None**

Sc	Twp	Rge	Government lot	NE				NW				SW				SE				Harv tax	Reg use
				n	n	s	s	n	n	s	s	n	n	s	s	n	n	s	s		
				e	w	w	e	e	w	w	e	e	w	w	e	e	w	w	e		
09	16S	07W												X							WT1
08	16S	07W															X		X		WT1
08	16S	07W		X	X																WT1

Special Concerns

Code Description Comment

SH Scenic Highway

Water Concern Information

Description	Classification	Rule
Lake Creek	F str-1g Mand written plan	170a
Lake Creek Tribs	Unknown class	

Check appropriate box(es) & fill in acres, etc.

ACTIVITY CODE

METHODS USED

5 CHANGING LAND USE
to a non-forest use (house
site, agricultural, etc.)
_____ Acres

WARNING: Local government
land use approval may be
required. A land use change
may not exempt the landowner
from all reforestation
requirements.

6 TREATMENT OF
SLASHING
20 Acres

Manual
 Burning
 Mechanical

7 PRE-COMMERCIAL
THINNING
_____ Acres

8 OTHER (any noncommercial
activities, i.e, rockpits, etc.)

Explain on line below

Enter starting and ending dates.

ESTIMATED STARTING DATE: 11-21-08
(Must be 15 days after the appropriate office receives notification)

ESTIMATED ENDING DATE: 12-31-08
(Expires at end of calendar year)

SITE CODES

Check the appropriate Waters, Topography, and Soil site codes.
One of each code must be checked on each unit.

WATERS

- W100 Within 100' of any lake or stream, (a channel that carries flowing surface water during some time of the year)
- W300 Within 300' of any estuary or any wetland greater than 8 acres
- WNA Waters not applicable

TOPOGRAPHY (over the steepest third of operation)

- T1 Slope of 0% to 35% (percent)
- T2 Slope of 36% to 65%
- T3 Slope greater than 65%

SOIL

- S1 No evidence of mass soil movement (slips, landslides, etc.)
- S2 Evidence of old slides, small failures
- S3 Recent or active movement; wet areas

REMARKS: Please describe the intent of the operation, what equipment will be used and any other information that may be relevant to the Forest Practice Forester.

all w/saw
all to landing w/cut
ruck to mill

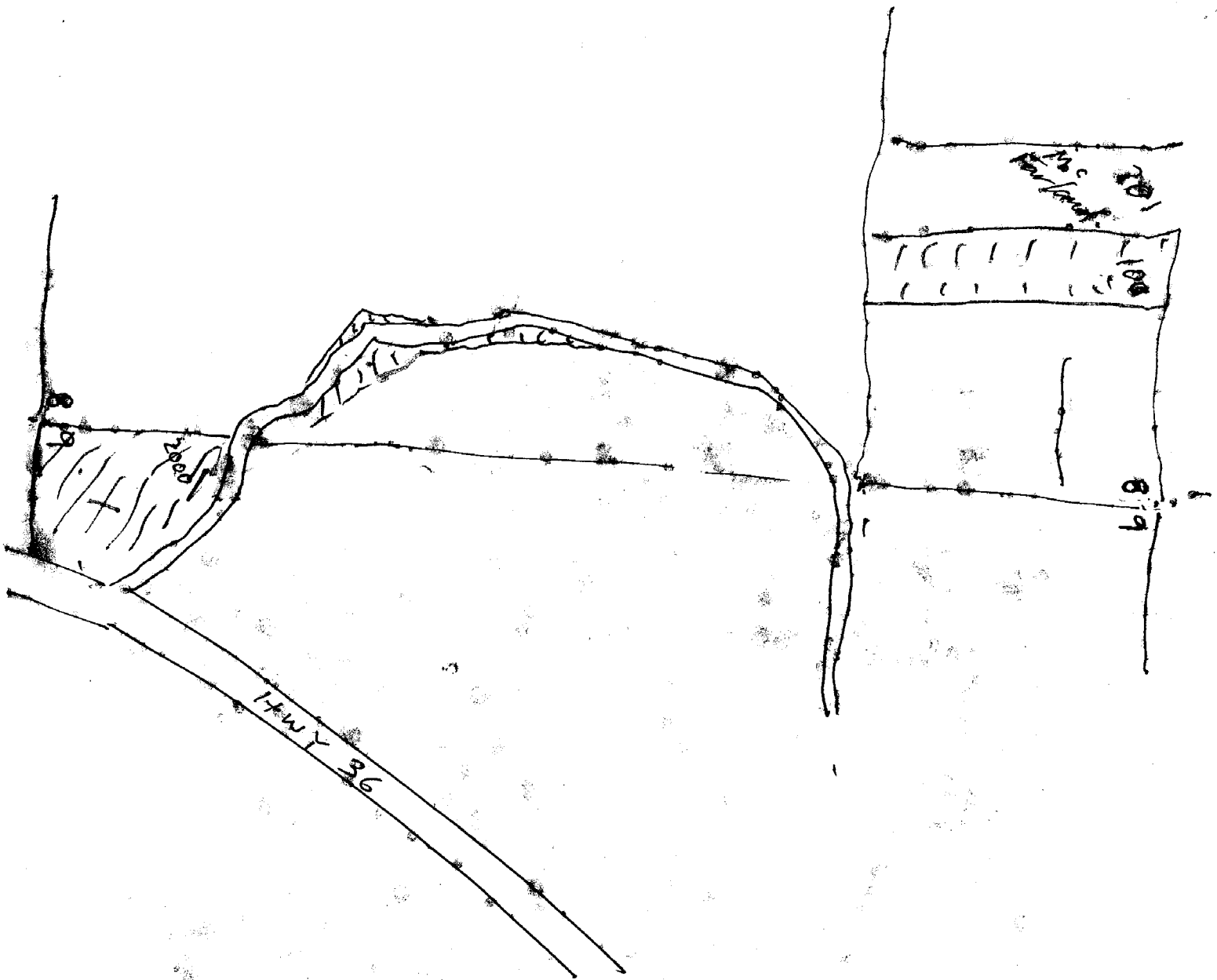

SKETCH
MAP

T 165
R 07W
SEC 9 & 8

Attachment:

D. WEBB?

NOTIFICATION

4/14/08