

State of Oregon
Department of Forestry / Department of Revenue
Notification number: 2008-781-50447 [78128496]

Attached is the processed information from the Notification of Operation and/or Application for Permits.
Please review this information and retain for future reference.

- Notice is given to the State Forester that an operation will be conducted on the lands described herein (ORS 527.670).

- A permit to operate power driven machinery is issued for the lands described herein (ORS 477.625)

S C R N

I. WHERE TIMBER HARVESTING IS PART OF THE PROPOSED OPERATION:

District: **Western Lane**
Office: **Veneta**

County: **Lane**
WOSTOT:

Received by ODF on June 4, 2008 by fax

A. NOTICE TO TIMBER OWNER: Party owning the harvested timber at the point it is first measured is shown in the section marked TIMBER OWNER and is responsible for payment of Oregon timber taxes.

B. NOTICE TO LAND OWNER: Party shown in the section marked LAND OWNER is responsible for reforestation of the site if so required.

15 DAY WAITING PERIOD REQUIRED

**** Waiver Requested ****

II. WRITTEN PLANS:

- A WRITTEN PLAN may be required before certain activities can commence on the Operation.

A WRITTEN PLAN may be required for the situations indicated by an below. A WRITTEN PLAN must be submitted or a WRITTEN WAIVER must be obtained from the State Forester before any portion of the operation may commence.

- Within 100 feet of a large lake or Type F or Type D stream. [OAR 629-605-170(1)(a)]

- Within 300 feet of a wildlife resource site listed in the 1984 ODF/ODFW Cooperative Agreement. [OAR 629-605-170(1)(b)]

- Within 300 feet of any resource identified in the Divisions 645 or 665 of the administrative rules. [OAR 629-605-170(1)(c)]

- Within 300 feet of a state or federally listed threatened or endangered wildlife resource site. [OAR 629-605-170(1)(d)]

Please contact the Oregon Department of Forestry forester named on the Unit Information sheet for further information on requirements that may be necessary to meet before any activity/operation begins.

Signed by **Donald Irons** - representing the Land owner.

***** NOTICE *****

The State Forester has determined that the following items requiring your attention are located within or adjacent to your operation area:

- Concerns - Resources - Water

See Unit Information on subsequent pages for details.

Operator:

Plum Creek Timber Lands LP
P O Box 216
Toledo, OR 97391
Phone: (541) 336-6224

Land owner:

Plum Creek Timber Lands LP
P O Box 216
Toledo, OR 97391
Phone: (541) 336-6224

Timber owner:

Phone:

Marvin D. Brown
State Forester

Dave Lorenz
District Forester

(Subscriber)

Unit: 1

Status: Active

Stewardship Forester: Ole Buch

Phone number: (541) 935-2283

Start date: 6/18/2008

End date: 12/31/2008

Site conditions: Lake or Stream within 100 ft
 Slope of 35% to 65%
 Old slides, small failures

FP = L

FPA = H

Acres: 20000

Feet:

Estimated harvest: MBF

Activity: Others Roadside Broom Veg Cut

Methods: Chainsaw Mechanical

Sc	Twp	Rge	Government lot	N E				N W				S W				S E				Harv tax	Reg use
				n	n	s	s	n	n	s	s	n	n	s	s	n	n	s	s		
			District Wide	e	w	w	e	e	w	w	e	e	w	w	e	e	w	w	e		WT1

Water Concern Information

Description	Classification	Rule
See Maps	F str-lg-med-sm-dom use Dom use str-lg-med-sm N str-lg-med-sm Unknown class S	170a

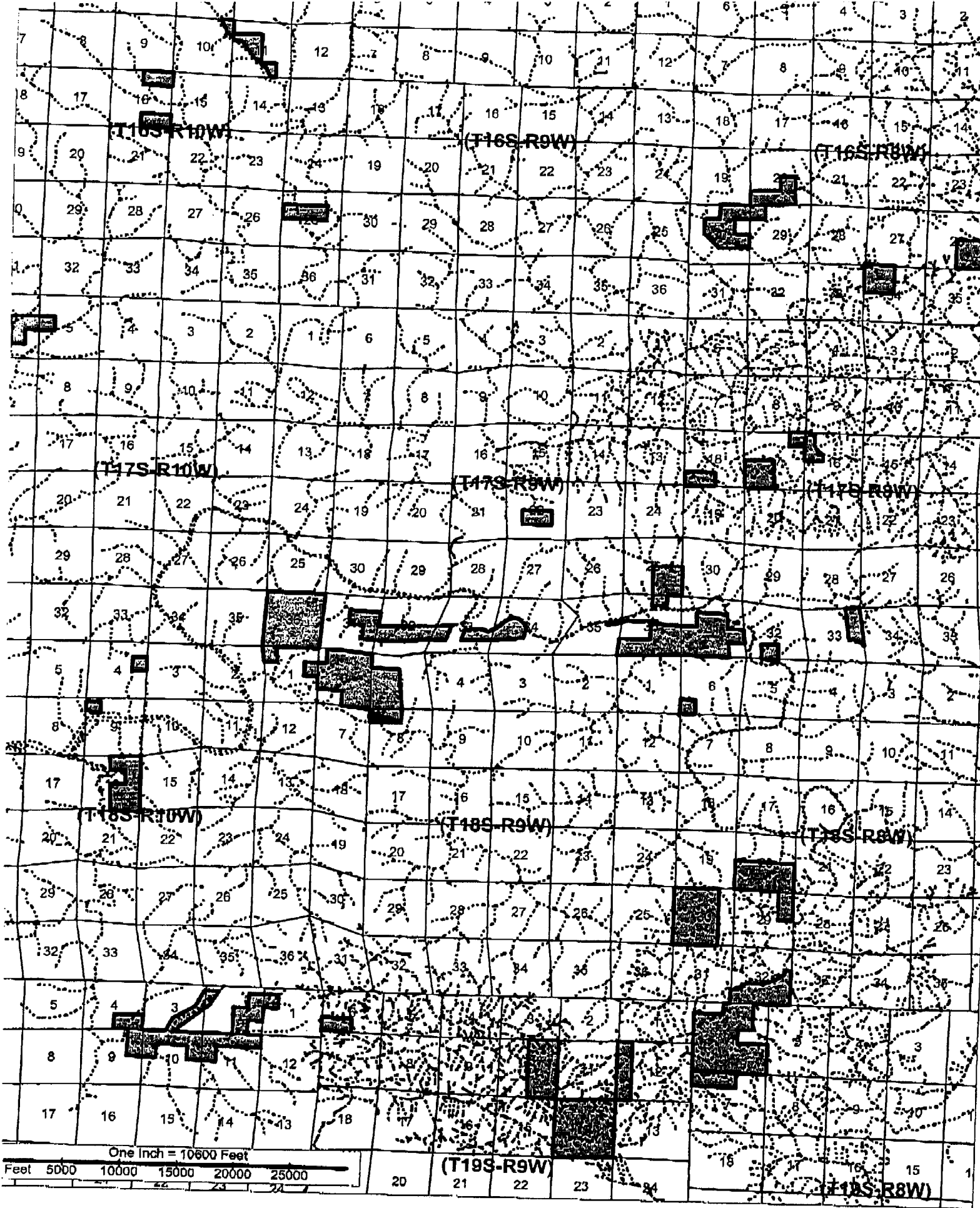

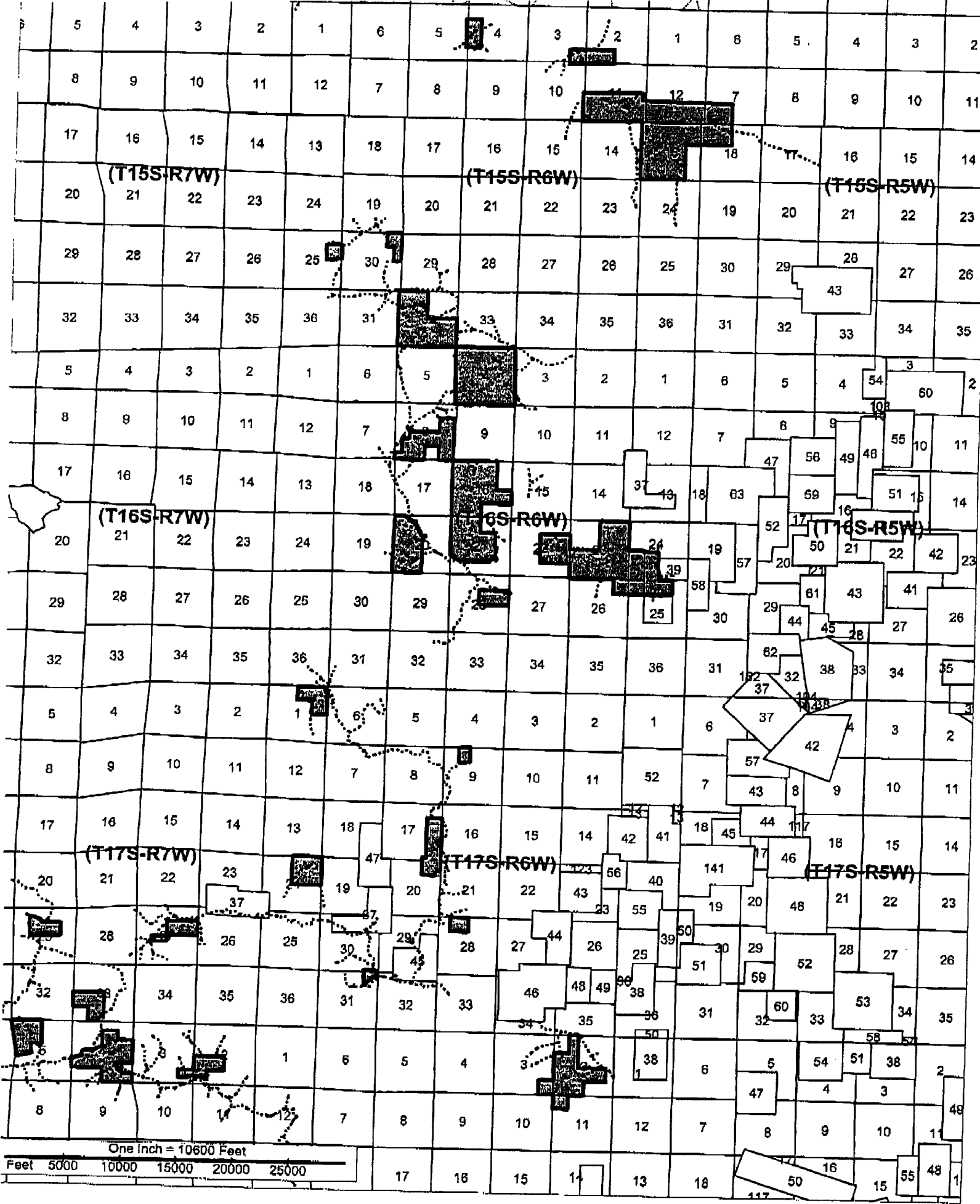

Written Plan

UNIT: West Lane Broom Cutting and Road Brushing

LANDOWNER: Plum Creek

OPERATOR: To be determined.

PLANNED OPERATION: A **Broom cutting and road brushing** operation is scheduled for 2008. Broom is a noxious weed and cutting is just one part of our integrated pest management. Timing of the activity will depend on the contractor, but the operation will be completed by the end of the year. The broom cutting is designed to reduce the spread of broom along roadways and into current and future young plantations. Broom will be targeted along roadways and in young plantations. Broom Cutting and Road Brushing may take place in and along protected stream buffers. Broom is not part of the native ecosystem, it is important to prevent its spread through and along the buffers. The overall buffer will be improved by cutting (removal) of the broom. Other species of shrubs, brush and trees may be cut along the road prisms as a normal roadside brushing operation. A Plum Creek representative will review and explain all portions of this written plan with the operator before the operations begin.

PROTECTED RESOURCES: **Fish and Domestic use streams.** See attached unit maps for protected streams and water systems.

PROTECTION MEASURES: The following measures will be taken to protect all Fish and Domestic streams.

1. Only the cutting of Broom will take place within an established buffer, unless within a road prism, then all vegetation will be brushed as in normal roadside brushing methods.
2. Any large material entering the stream course due to this activity will be removed.

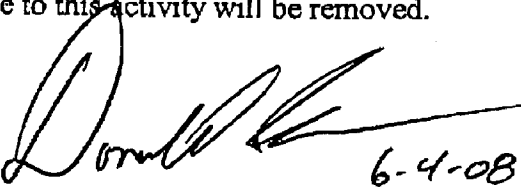
DONALD IRONS
Sr. Resource Forester
Plum Creek Timberlands

6/4/2008
11:17 AM

- CGG Columbia Gorge Scenic management area
- SH Scenic Highway (operation near a scenic highway)
- SW Operation near a state Scenic Waterway
- UGB Operation takes place within an Urban Growth Boundary
- WG Operation takes place in the Willamette Greenway

- BEN Bald Eagle Nesting site
- BEP Bald Eagle Perch and foraging site
- BER Bald Eagle Roosting site
- BIO Biological site of a rare life form or community
- BPS Band-tailed Pigeon mineral, watering, or springs site
- CC Operation will result in a single clear-cut or continuation of contiguous clear-cuts that exceed 120 acres
- CWD Columbia Whitetail Deer
- GBH Great Blue Heron nest site
- GLD Golden eagle nest site
- HRA High Risk Area
- HRS High Risk Site
- MUR Marbled Murrelet nest site
- NSD Northern Spotted Owl site
- OSP Osprey nest site
- RAP Other Raptor nest sites
- SBS Sensitive Bird nesting, roosting & watering site
- T&E Threatened & Endangered species

STREAM NAME and/or CLASS & WATERSHED CODE

WATERS

Check any of the Water codes that you are aware of in the boxes below.

- DWS Domestic Water Supply
- LL Lake greater than 8 acres
- OTHER LAKES less than 8 acres
- OTHER WETLANDS less than 8 acres
- WETLANDS bog, estuary, significant wetland (>8 acres), important springs in e. Oregon

(Continue on to Next Column)

(Continue on to Legal Description)

Rule #: PA: PA/WP: WP: AP: Rule #: PA: PA/WP: WP: AP:

LEGAL DESCRIPTION

Check each 1/16 of every section that applies. Enter information for government lots (if applicable), section, township, and range. If more space is needed use a Legal Description Addendum Sheet.

Govt. Lot # if outside std. section	

All PLUM CREEK Timber Company ownership IN WEST LANE District WIDE AS shown on attached MAPS for the Cutting of Broom & Roadside vegetation.

Enter the Western Oregon Severance Tax Unit No. in this box, if applicable.

Regulated Use Area:

There is a 15 day waiting period in effect until otherwise formed by the Forest Practices Forester. Check this box if a waiver of the 15 day waiting period is requested:

Waiting period waived by:
Date:

Print name of applicant in box below.

x DONALD IRONS

I (applicant) certify that all information I have provided is true & correct.

Signature: *Donald Irons*

Date: 6-4-08

ATTACH MAP AND/OR AERIAL PHOTOS (The notification form is NOT complete unless a map or aerial photo of the operation area is attached. Either one of these must show the operation area, access route, north arrow, scale, etc.)

COMMENTS (any comment written here will print out on copies of the notification)
 PCT-- Thompson 23,26, Bentilla 24, Bentilla 25, Thompson SE 26, Old River Thin 35

Broom Cutting WEST LANE

Subscriber:	Subscriber:	W.R. Subscriber:
Subscriber:	Subscriber:	W.R. Subscriber:
Subscriber:	Subscriber:	W.R. Subscriber:

AAccomp