



State of Oregon
Department of Forestry - Department of Revenue
Notification Number: 2013-781-00026
Timber Sale: Lane Forest-Seneca



Attached is the processed information from the Notification of Operation/Application for Permit signed by Kevin Tuers representing the Land Owner, and received by Department of Forestry on December 31, 2012. Please review this information and retain for future reference.

Notices and Permits

A permit to use fire or operate power driven machinery is issued for the land described herein.

| | |
|---|--|
| SF Comments: | |
| <p align="center">LEGAL NOTICE</p> <p>The following section provides legal notification of the requirement to submit a written plan before certain portions of this Operation may begin. The requirements are indicated below:</p> <p>Based on information provided by the applicant, no Written Plans were required at the time this notice was sent. Written Plans may be required at a future date if new protected resources or other information is discovered.</p> | <p>Notification 15 Day Waiting Period: Not applicable.</p> <p>Operator: Lane Forest Products 2111 Prairie Road Eugene, OR 97402 (541) 345-9085</p> <p>Fire Contact: Kevin Tuers (541) 913-2143</p> <p>Land Owner: Seneca Jones Timber Company Po Box 10265 Eugene, OR 97440 (541) 689-1231</p> <p>Timber Owner:</p> |
| <p>District: Western Lane</p> <p>Office: Veneta Unit</p> <p>County: Lane</p> | |

(Subscriber Copy)

Doug Decker, State Forester
Link Smith, District Forester

Unit Information - Notification: 201378100026

Unit 1 of 1 Start: 01/07/13 End: 03/01/13

Status: Open

Stewardship Forester: Robert Johnson

Site Conditions Waters: Not Applicable.

Soils: Not Applicable.

Slope: Not Applicable.

SF Phone Number:

Priorities: Fire: Low FPA: Low

| Twp | Rge | Sec | NE | | | | NW | | | | SW | | | | SE | | | | Government Lot Number | Tax Lot No. | Reg Use |
|-----|-----|-----|--------------------------|--------------------------|--------------------------|--------------------------|--------------------------|--------------------------|--------------------------|--------------------------|--------------------------|-------------------------------------|-------------------------------------|-------------------------------------|--------------------------|--------------------------|-------------------------------------|-------------------------------------|--------------------------|----------------|------------|
| | | | NE | NW | SW | SE | NE | NW | SW | SE | NE | NW | SW | SE | NE | NW | SW | SE | | | |
| 19S | 04W | 24 | <input type="checkbox"/> | <input type="checkbox"/> | <input type="checkbox"/> | <input type="checkbox"/> | <input type="checkbox"/> | <input type="checkbox"/> | <input type="checkbox"/> | <input type="checkbox"/> | <input type="checkbox"/> | <input checked="" type="checkbox"/> | <input checked="" type="checkbox"/> | <input checked="" type="checkbox"/> | <input type="checkbox"/> | <input type="checkbox"/> | <input checked="" type="checkbox"/> | <input type="checkbox"/> | | | WT-1 |
| 19S | 04W | 23 | <input type="checkbox"/> | <input type="checkbox"/> | <input type="checkbox"/> | <input type="checkbox"/> | <input type="checkbox"/> | <input type="checkbox"/> | <input type="checkbox"/> | <input type="checkbox"/> | <input type="checkbox"/> | <input type="checkbox"/> | <input type="checkbox"/> | <input type="checkbox"/> | <input type="checkbox"/> | <input type="checkbox"/> | <input type="checkbox"/> | <input checked="" type="checkbox"/> | | | WT-1 |

| Activity | Method | Acres | Feet | MBF | Comment |
|------------------------|-------------------------------------|-------|------|-----|-----------------|
| 6 - Treatment of Slash | Mechanical application or operation | 0.00 | 0 | 0 | |
| 8 - Other | Other (explain) | 0.00 | 0 | 0 | Biomass Removal |

Resource Name

Resource Description

No Waters Found.

No Threatened or Endangered Species Found.

No Special Concerns Found.

Subscribers: Forestland Dwellers, Illahe Farm

Exhibit "B" Weiss Units

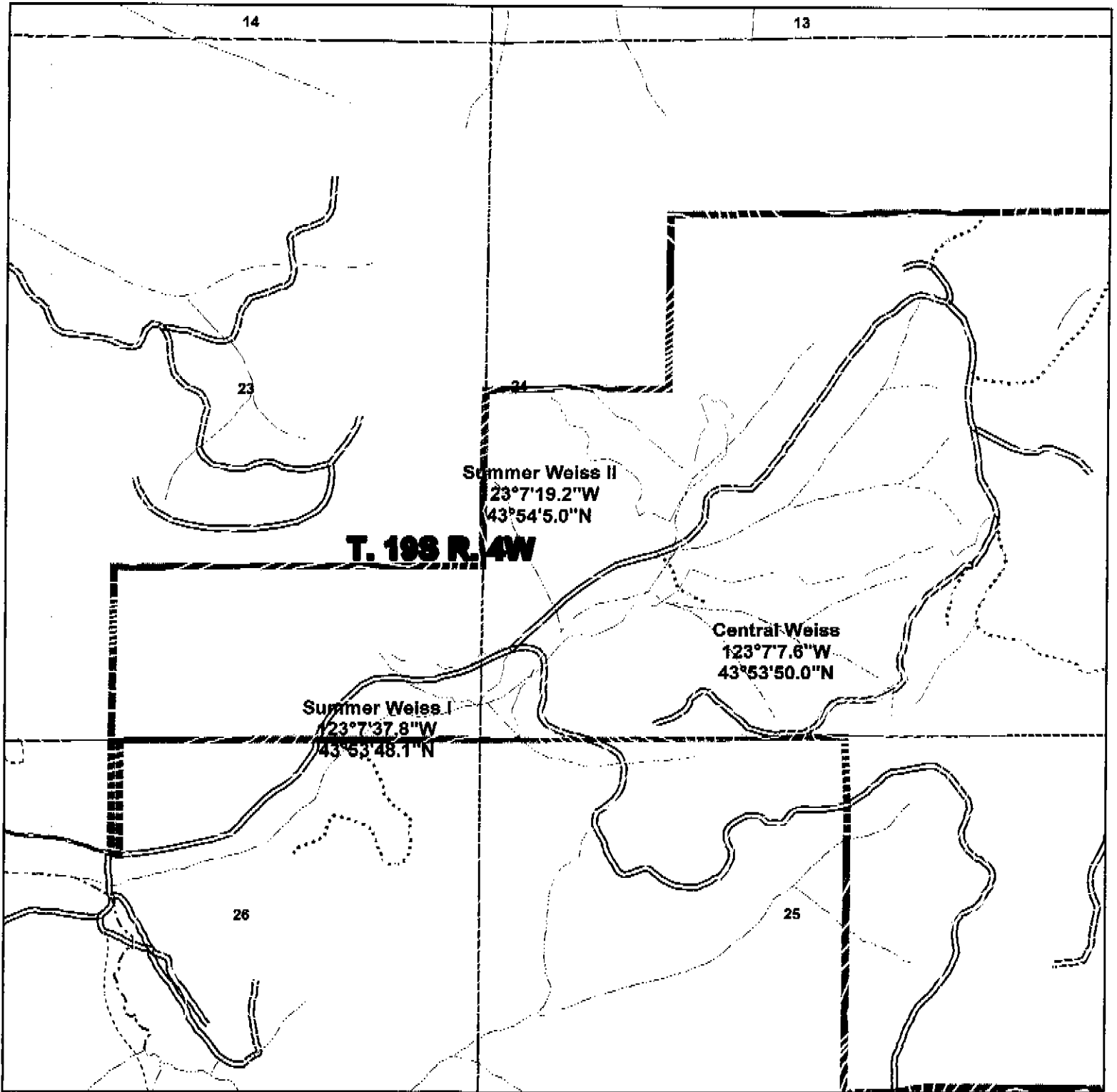

Legend

| | | | | |
|--|--|--|-------------------|--|
| | | | | |
| | | | Road Class | |
| | | | | |
| | | | | |
| | | | | |

1 inch = 1,000 feet
 Contour Interval is 20'

