



**State of Oregon**  
**Department of Forestry - Department of Revenue**  
**Notification Number: 2013-781-00195**  
**Timber Sale: Little Lake Spray**



Attached is the processed information from the Notification of Operation/Application for Permit signed by Jeffery A. Newman representing the Operator, and received by Department of Forestry on February 19, 2013. Please review this information and retain for future reference.

**Notices and Permits**

Notice is given to the State Forester that an operation will be conducted on the lands described herein.

A permit to use fire or operate power driven machinery is issued for the land described herein.

<b>SF Comments:</b>	
<p align="center"><b>LEGAL NOTICE</b></p> <p>The following section provides legal notification of the requirement to submit a written plan before certain portions of this Operation may begin. The requirements are indicated below:</p> <p>Based on information provided by the applicant, no Written Plans were required at the time this notice was sent. Written Plans may be required at a future date if new protected resources or other information is discovered.</p>	<p><b>Notification 15 Day Waiting Period:</b> This Operation is subject to the 15 day Waiting Period.</p> <p><b>Operator:</b> Little Lake Logging and Const. Inc P.O. Box 42 Blachly, OR 97412 (541) 927-3339</p> <p><b>Fire Contact:</b> Jeffery A. Newman (541) 927-3339</p> <p><b>Land Owner:</b> Little Lake Farm Inc P.O. Box 42 Blachly, OR 97412 (541) 927-3339</p> <p><b>Timber Owner:</b> Little Lake Farm Inc P.O. Box 42 Blachly, OR 97412 (541) 927-3339</p>
<p>District: <b>Western Lane</b></p> <p>Office: <b>Veneta Unit</b></p> <p>County: <b>Lane</b></p>	

(Subscriber Copy)

**Doug Decker, State Forester**  
**Link Smith, District Forester**

**Unit Information - Notification: 201378100195**

Unit 1 of 2 Start: 03/20/13 End: 12/31/13

Status: Open

Stewardship Forester: Robin L. Biesecker

**Site Conditions** Waters: Not Applicable.

Soils: No mass soil movement.

Slope: 36% to 65%.

SF Phone Number: (541)935-2283

Priorities: **Fire: Low FPA: Low**

Twp	Rge	Sec	NE				NW				SW				SE				Government Lot Number	Tax Lot No.	Reg Use
			NE	NW	SW	SE	NE	NW	SW	SE	NE	NW	SW	SE	NE	NW	SW	SE			
16S	08W	13	<input type="checkbox"/>	<input type="checkbox"/>	<input type="checkbox"/>	<input type="checkbox"/>	<input type="checkbox"/>	<input type="checkbox"/>	<input type="checkbox"/>	<input type="checkbox"/>	<input type="checkbox"/>	<input type="checkbox"/>	<input type="checkbox"/>	<input type="checkbox"/>	<input checked="" type="checkbox"/>	<input type="checkbox"/>	<input checked="" type="checkbox"/>	<input checked="" type="checkbox"/>			WT-1
16S	07W	18	<input type="checkbox"/>	<input type="checkbox"/>	<input type="checkbox"/>	<input type="checkbox"/>	<input type="checkbox"/>	<input type="checkbox"/>	<input type="checkbox"/>	<input type="checkbox"/>	<input checked="" type="checkbox"/>	<input checked="" type="checkbox"/>	<input type="checkbox"/>	<input type="checkbox"/>	<input type="checkbox"/>	<input type="checkbox"/>	<input type="checkbox"/>	<input type="checkbox"/>			WT-1

Activity	Method	Acres	Feet	MBF	Comment
4a - Herbicide Application	Dozer	30.00	0	0	Brand: Tordon RTU; Common: Triclopyr

Resource Name	Resource Description
Great Blue Heron site	No Waters Found.
	No Special Concerns Found.

Subscribers: Jan Wroncy

# FANS Map



## Legend

- Bald Eagle
- Bird Point Update
- District Birds
- Fish
- No Fish
- Unknown 1
- FPA Polygons Current
- Geo-Regions
- Historic Sites
- Marbled Murrelet
- Peregrine Falcon
- Proposed Areas - 4 SF
- Railroads
- Regulated Use
- Roads
- Roads Names
- Scenic Hwy 300 ft
- Sixteenths
- Spotted Owl Site
- Large
- Medium
- Small
- Unknown
- Taxlots Douglas
- Taxlots Lane 2012
- Interstate Highway
- Municipal Highway
- State Highway
- US Highway
- Urban Growth Bdy
- Lakes
- Western Lane Boundary
- No Wetlands Data
- Wetlands

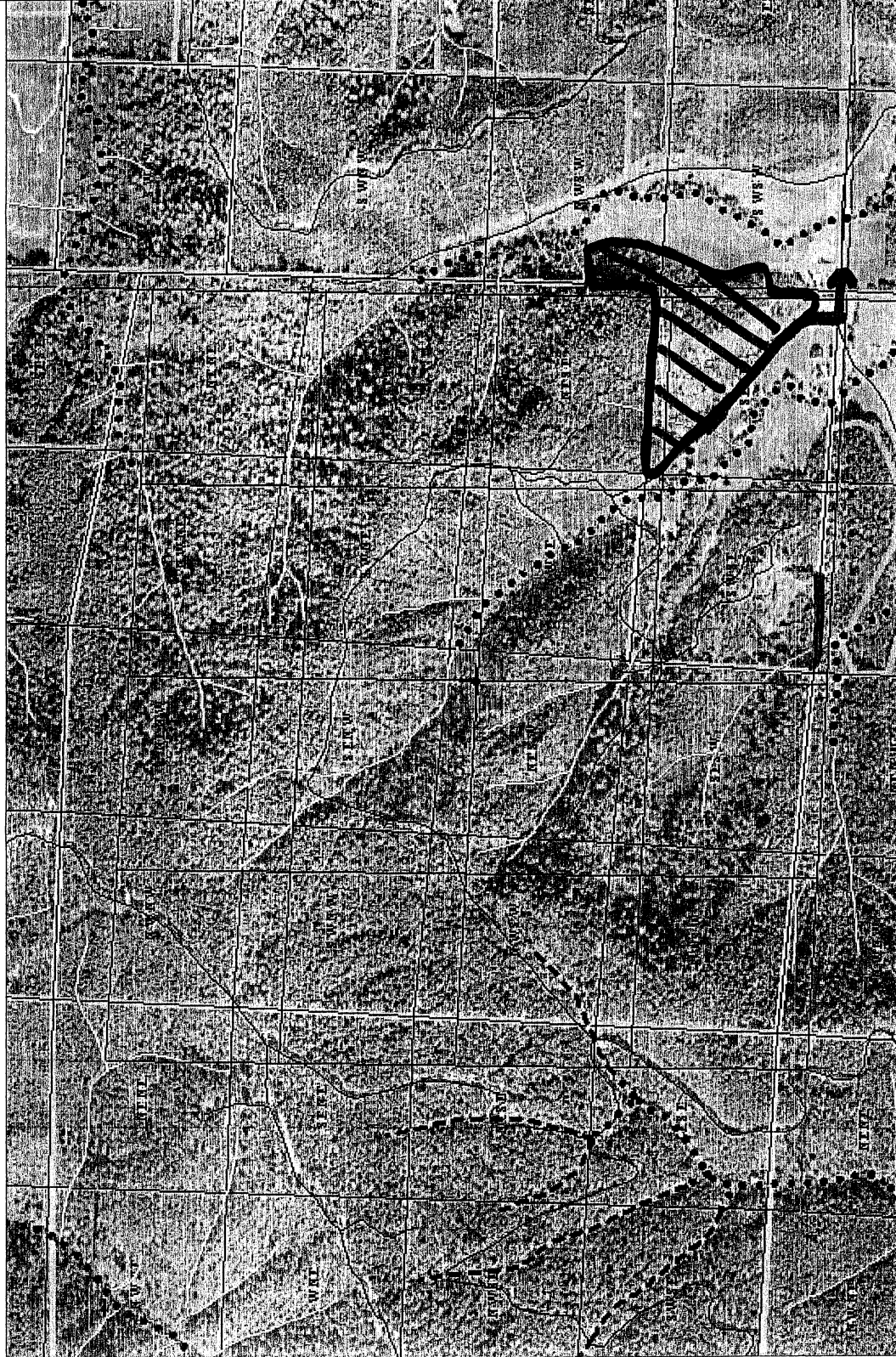

Vicinity Map

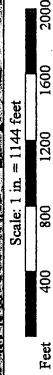
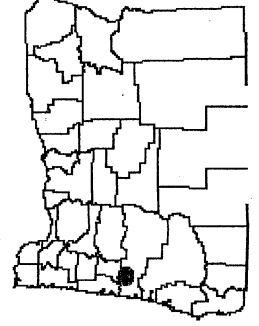

### Location Information 02/19/2013

Legal: T16S R8W S13, NESW  
 Latitude: 44°10'35", (44°10.5898' or 44.1765°)  
 Longitude: -123°36'18", (-123°36.2991' or -123.6050°)  
 15 Miles Northwest of Veneta  
 18 Miles Southwest of Monroe  
 Elevation (approximate): 1800 ft.  
 LandMark: Little Elk Mountain  
 Watershed 5th Field Name and #: LAKE CREEK, 1710020604  
 Quad Name & #: TRIANGLE LAKE, 44123B5  
 County and District: LANE  
 Regulated Use: WT-1