



State of Oregon
Department of Forestry - Department of Revenue
Notification Number: 2013-781-00206
Timber Sale: Siuslaw- Lorane Spring Ground



Attached is the processed information from the Notification of Operation/Application for Permit signed by Tiffany Roddy representing the Land Owner, and received by Department of Forestry on February 26, 2013. Please review this information and retain for future reference.

Notices and Permits

Notice is given to the State Forester that an operation will be conducted on the lands described herein.

SF Comments:	
<p align="center">LEGAL NOTICE</p> <p>The following section provides legal notification of the requirement to submit a written plan before certain portions of this Operation may begin. The requirements are indicated below:</p> <p>Based on information provided by the applicant, no Written Plans were required at the time this notice was sent. Written Plans may be required at a future date if new protected resources or other information is discovered.</p>	<p>Notification 15 Day Waiting Period: This Operation is subject to the 15 day Waiting Period.</p> <p>Operator: Tiffany Roddy Weyerhaeuser Company PO Box 1819 Eugene, OR 97440 (541) 744-4600</p> <p>Fire Contact: Tiffany Roddy (541) 744-4600</p> <p>Land Owner: Tiffany Roddy Weyerhaeuser Company PO Box 1819 Eugene, OR 97440 (541) 744-4600</p> <p>Timber Owner:</p>
District: Western Lane Office: Veneta Unit County: Lane	

(Subscriber Copy)

Doug Decker, State Forester
Link Smith, District Forester

Unit Information - Notification: 201378100206

Unit 1 of 2 Start: 02/26/13 End: 12/31/13

Status: Open

Stewardship Forester: Robert Johnson

Site Conditions Waters: Lake or stream Within 100 feet.

Soils: No mass soil movement.

Slope: 0% to 35%.

SF Phone Number:

Priorities: Fire: Low FPA: High

Twp	Rge	Sec	NE				NW				SW				SE				Government Lot Number	Tax Lot No.	Reg Use
			NE	NW	SW	SE	NE	NW	SW	SE	NE	NW	SW	SE	NE	NW	SW	SE			
20S	05W	14	<input type="checkbox"/>	<input type="checkbox"/>	<input type="checkbox"/>	<input type="checkbox"/>	<input checked="" type="checkbox"/>	<input type="checkbox"/>	<input type="checkbox"/>	<input checked="" type="checkbox"/>	<input checked="" type="checkbox"/>	<input type="checkbox"/>	<input type="checkbox"/>	<input checked="" type="checkbox"/>	<input checked="" type="checkbox"/>	<input checked="" type="checkbox"/>	<input checked="" type="checkbox"/>			WT-1	

Activity	Method	Acres	Feet	MBF	Comment
4a - Herbicide Application	Ground	110.00	0	0	Unit Name: Siuslaw 100; Brand: Oust, Oust XP, Velpar L, Velpar DF, Transline, Garlon 3A, Atrazine 4L, LV6,; Common: , 2,4-D; Additives: , MSO, Non-Ionic Surfactant

Resource Name	Resource Description
Tributaries to Siuslaw River	Tributaries to Siuslaw River: Small Type F Stream(s), Small Unknown
Tributaries to Siuslaw River	Other Wetland Greater than 1/2 Acre
ARChaeological Area	No Threatened or Endangered Species Found.
Subscribers: Forestland Dwellers	Lorane Unit AR 909 21

Unit Information - Notification: 201378100206

Unit 2 of 2 Start: 03/13/13 End: 12/31/13

Status: Open

Stewardship Forester: Robert Johnson

Site Conditions Waters: Lake or stream Within 100 feet.

Soils: No mass soil movement.

Slope: 0% to 35%.

SF Phone Number:

Priorities: Fire: Low FPA: High

Twp	Rge	Sec	NE				NW				SW				SE				Government Lot Number	Tax Lot No.	Reg Use
			NE	NW	SW	SE	NE	NW	SW	SE	NE	NW	SW	SE	NE	NW	SW	SE			
20S	05W	14	<input checked="" type="checkbox"/>	<input checked="" type="checkbox"/>	<input checked="" type="checkbox"/>	<input checked="" type="checkbox"/>	<input checked="" type="checkbox"/>	<input type="checkbox"/>	<input type="checkbox"/>	<input type="checkbox"/>	<input type="checkbox"/>	<input type="checkbox"/>	<input type="checkbox"/>	<input type="checkbox"/>	<input type="checkbox"/>	<input type="checkbox"/>	<input type="checkbox"/>			WT-1	

Activity	Method	Acres	Feet	MBF	Comment
4a - Herbicide Application	Ground	72.00	0	0	Unit Name: Lorane View; Brand: Oust, Oust XP, Velpar L, Velpar DF, Transline, Garlon 3A, Atrazine 4L, LV6, Forestry Garlon XRT; Common: , 2,4-D; Additives: , MSO, Non-Ionic Surfactant

Resource Name	Resource Description
Tributaries to Farman Creek	Tributaries to Farman Creek: Small Unknown
ARChaeological Area	No Threatened or Endangered Species Found.
	Lorane Unit AR 909 21

Subscribers: Forestland Dwellers



South Valley Timberlands
P.O. Box 1819
Eugene, OR 97440-1819
Tel (541) 744-4600
Fax (541) 744-4688

WRITTEN PLAN OF OPERATION FOR GROUND HERBICIDE APPLICATION

Weyerhaeuser Company is planning backpack spot spray applications targeting broadleaf and/or herbaceous vegetation near protected resources. This letter is our submission of a written plan of operation for activities within 100 feet of protected resources. The plat submitted with the ODF notification shows the unit boundaries and resources to be protected. Chemical will not be mixed, handled or staged with 100 feet of protected resources.

No herbicide will be directly applied within 10 feet of the high water mark of any protected resource defined as F or D stream, lakes, significant wetlands and other areas of standing open water greater than one-quarter acre at the time of application. No treatment of existing streamside buffer strips from previous harvest activities will be done. All application will be done in compliance with the Oregon Forest Practices Rules and label instructions.

Landowner will identify the above-protected resources with crew foreman prior to application by means of aerial photos, maps, and/or ground visits to provide operator with adequate information to properly treat the area.

Unit #: 2402 - SIUSLAW 100

Legal Description: 14-205-SW

Stream & Classification: SF TRIB TO SIUSLAW RIVER

Sincerely,



Tiffany Roddy, Forester
South Valley Area

2/26/13

Date Submitted

Operator

Date

Weyerhaeuser Company
 South Valley Western Timberlands
 P. O. Box 1819, Eugene, OR 97440
 (541) 744-4600 (541) 746-2511 [24 hrs.]

Area/Road No. SUSLAW 100

①

Ground Herbicide Application Report

District: South Valley

Season SPRING 2013

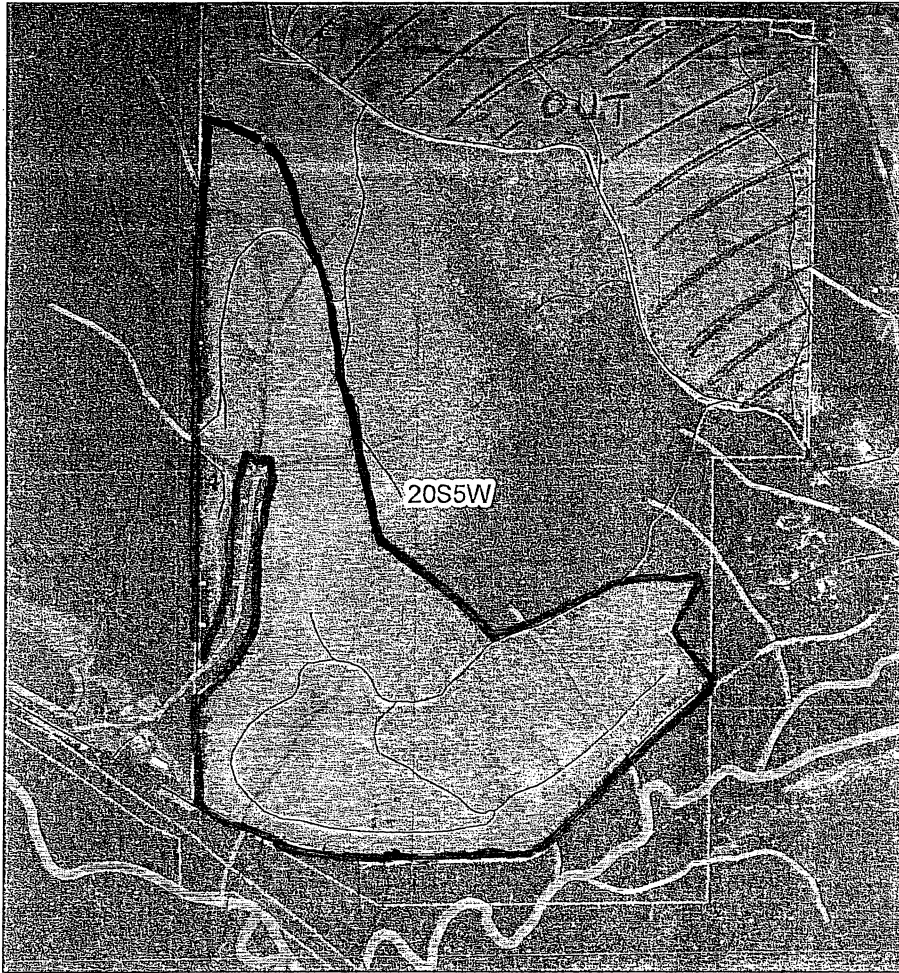

Sec(s)	<u>14</u>		
Twp(s)	<u>20S</u>		
Rge(s)	<u>5W</u>		

Elevation: _____ Scale 1" = 500'

Type of Equipment: BACKPACK
 Application Method: SPOT SPRAY
 Contractor/Co: _____
 Full name of applicator/certification #: _____

Reforestation Unit #: _____
 Estimated Trees/acre _____
 Harvest Completion _____
 Site Preparation Date _____

Meter-Jet@Specifications:
 10 milliliters mix applied per tree
 19 square feet treated (area per tree)

Chemical Supplier (Check One):
 Helena Chemical Wilbur Ellis
 Containers rinsed at least 3x & recycled
 Comments: _____

Date _____ By _____

Note: This record shall be kept for 3 years in accordance with ORS 63.4.1.46.

Unit	Acres	Chemical/Ac		Surfactant-Carrier/Ac		Water G/Acre	Total G/Acre	Site Prep	Release	Target Species
		(Trade Name)								
<u>2402</u>	<u>110</u>									
Actual										

Written plan required? Yes No

Resource to be protected: TRIB TO SUSLAW RIVER, SF

Submitted to: ODF VENETA Date 2/26/13

Operator Signed: _____ Date _____

Date State Notification Submitted: _____

Date Application can begin

Accord Conc./Rodeo # 62719-324, Sulfomet XP # 352-401-85588,

Transline # 62719-259, DMA 4 IVM Amine # 62719-3,

Velpar DF# 352-581, Weedone LV 6 EC # 71368-11,

Additional Requirements

- Neighbor Notification: _____
- Wetland Protection _____
- Open Water/Rainfall: _____
- T/E Protection: _____
- Other: _____

Notes: 15-day waiting period cannot be waived for aerial spray.
 Full name of all applicators and trainees applying pesticide must be recorded. All information must be recorded within 30 days following the pesticide application.

Weyerhaeuser Company
 South Valley Western Timberlands
 P.O. Box 1819, Eugene, OR 97440
 (541) 744-4600 (541) 746-2511 [24 hrs.]

Area/Road No. LORANE VIEW

Ground Herbicide Application Report

District: South Valley

Season SPRING 2013



Sec(s)	<u>14</u>		
Twp(s)	<u>20S</u>		
Rge(s)	<u>5W</u>		

Elevation: _____ Scale 1" = 500'

Type of Equipment: BACKPACK
 Application Method: SPOT SPRAY
 Contractor/Co: _____
 Full name of applicator/certification #: _____

Reforestation Unit #: _____
 Estimated Trees/acre _____
 Harvest Completion _____
 Site Preparation Date _____

Meter-Jet® Specifications:
 10 milliliters mix applied per tree
 19 square feet treated (area per tree)

Chemical Supplier (Check One):
 Helena Chemical Wilbur Ellis
 Containers rinsed at least 3x & recycled
 Comments: _____

Date _____ By _____

Unit	Acres	Chemical/Ac (Trade Name)				Surfactant-Carrier/Ac				Water G/Acre	Total G/Acre	Site Prep	Release	Target Species
		Chemical												
2403	72													
Actual														

Note: This record shall be kept for 3 years in accordance with ORS 634.146.

Written plan required? Yes No

Resource to be protected: _____
 Submitted to: ODF VENETA Date 2/26/13
 Operator Signed: _____ Date _____
 Date State Notification Submitted: _____
~~Date Application can begin~~

Accord Conc./Rodeo # 62719-324, Sulfomet XP # 352-401-85588,
 Transline # 62719-259, DMA 4 IVM Amine # 62719-3,
 Velpar DF # 352-581, Weedone LV 6 EC # 71368-11.

Additional Requirements

Neighbor Notification: _____
 Wetland Protection _____
 Open Water/Rainfall: _____
 T/E Protection: _____
 Other: _____

Notes: 15-day waiting period cannot be waived for aerial spray.
 Full name of all applicators and trainees applying pesticide must be recorded. All information must be recorded within 30 days following the pesticide application.