



State of Oregon
Department of Forestry - Department of Revenue
Notification Number: 2013-781-00210
Timber Sale: West Lane Spring Aerial



Attached is the processed information from the Notification of Operation/Application for Permit signed by Jeff Yost representing the Land Owner, and received by Department of Forestry on February 27, 2013. Please review this information and retain for future reference.

Notices and Permits

Notice is given to the State Forester that an operation will be conducted on the lands described herein.

A permit to use fire or operate power driven machinery is issued for the land described herein.

SF Comments:	
<p align="center">LEGAL NOTICE</p> <p>The following section provides legal notification of the requirement to submit a written plan before certain portions of this Operation may begin. The requirements are indicated below:</p> <p>Based on information provided by the applicant, no Written Plans were required at the time this notice was sent. Written Plans may be required at a future date if new protected resources or other information is discovered.</p>	<p>Notification 15 Day Waiting Period: This Operation is subject to the 15 day Waiting Period.</p> <p>Operator: Jeff Yost Weyerhaeuser Co. PO Box 1819 Eugene, OR 97440 (541) 744-4600</p> <p>Fire Contact: Jeff Yost (541) 744-4600</p> <p>Land Owner: Jeff Yost Weyerhaeuser Co. PO Box 1819 Eugene, OR 97440 (541) 744-4600</p> <p>Timber Owner:</p>
<p>District: Western Lane</p> <p>Office: Veneta Unit</p> <p>County: Lane</p>	

(Subscriber Copy)

Doug Decker, State Forester
Link Smith, District Forester

Unit Information - Notification: 201378100210

Unit 1 of 9 Start: 03/15/13 End: 12/31/13

Status: Open

Stewardship Forester: Robin L. Biesecker

Site Conditions Waters: Lake or stream Within 100 feet.

Soils: No mass soil movement.

Slope: 0% to 35%.

SF Phone Number: (541)935-2283

Priorities: **Fire: Low FPA: High**

Twp	Rge	Sec	NE				NW				SW				SE				Government Lot Number	Tax Lot No.	Reg Use
			NE	NW	SW	SE	NE	NW	SW	SE	NE	NW	SW	SE	NE	NW	SW	SE			
15S	06W	34	<input type="checkbox"/>	<input type="checkbox"/>	<input checked="" type="checkbox"/>	<input checked="" type="checkbox"/>	<input type="checkbox"/>	<input type="checkbox"/>	<input type="checkbox"/>	<input type="checkbox"/>	<input type="checkbox"/>	<input type="checkbox"/>	<input type="checkbox"/>	<input type="checkbox"/>	<input checked="" type="checkbox"/>	<input checked="" type="checkbox"/>	<input type="checkbox"/>	<input type="checkbox"/>			WT-1

Activity	Method	Acres	Feet	MBF	Comment
4a - Herbicide Application	Aerial operation / applications	44.00	0	0	Unit Name: High Pass 34; Brand: Velpar DF, Sulfomet XP, Transline, Rodeo; Common: 2,4-D, Atrazine

Resource Name	Resource Description
Tributaries to Owens Creek	Tributaries to Owens Creek: Small Unknown
	No Threatened or Endangered Species Found.
	No Special Concerns Found.

Subscribers: Jan Wroncy

Unit Information - Notification: 201378100210

Unit 2 of 9 Start: 03/15/13 End: 12/31/13

Status: Open

Stewardship Forester: Robin L. Biesecker

Site Conditions Waters: Lake or stream Within 100 feet.

Soils: No mass soil movement.

Slope: 36% to 65%.

SF Phone Number: (541)935-2283

Priorities: **Fire: Low FPA: High**

Twp	Rge	Sec	NE				NW				SW				SE				Government Lot Number	Tax Lot No.	Reg Use				
			NE	NW	SW	SE	NE	NW	SW	SE	NE	NW	SW	SE	NE	NW	SW	SE							
16S	07W	24	<input type="checkbox"/>	<input type="checkbox"/>	<input type="checkbox"/>	<input type="checkbox"/>	<input type="checkbox"/>	<input type="checkbox"/>	<input type="checkbox"/>	<input type="checkbox"/>	<input type="checkbox"/>	<input type="checkbox"/>	<input type="checkbox"/>	<input checked="" type="checkbox"/>	<input checked="" type="checkbox"/>	<input checked="" type="checkbox"/>	<input checked="" type="checkbox"/>	<input type="checkbox"/>	<input checked="" type="checkbox"/>	<input checked="" type="checkbox"/>	<input type="checkbox"/>				WT-1

Activity	Method	Acres	Feet	MBF	Comment
4a - Herbicide Application	Aerial operation / applications	73.00	0	0	Unit Name: Fiskars; Brand: Velpar DF, Sulfomet XP, Transline, Rodeo; Common: 2,4-D, Atrazine

Resource Name	Resource Description
Tributaries to Long Tom River	Tributaries to Long Tom River: Medium Type F, Small Type F
Tributaries to Long Tom River	Small Non-Fish Stream(s), Small Unknown
	No Threatened or Endangered Species Found.
	No Special Concerns Found.

Subscribers: Jan Wroncy

Unit Information - Notification: 201378100210

Unit 6 of 9 Start: 03/15/13 End: 12/31/13

Status: Open

Stewardship Forester: Robin L. Biesecker

Site Conditions Waters: Lake or stream Within 100 feet.

Soils: No mass soil movement.

Slope: 36% to 65%.

SF Phone Number: (541)935-2283

Priorities: **Fire: Low FPA: High**

Twp	Rge	Sec	NE				NW				SW				SE				Government Lot Number	Tax Lot No.	Reg Use
			NE	NW	SW	SE	NE	NW	SW	SE	NE	NW	SW	SE	NE	NW	SW	SE			
16S	06W	18	<input type="checkbox"/>	<input checked="" type="checkbox"/>	<input type="checkbox"/>	<input type="checkbox"/>	<input checked="" type="checkbox"/>	<input checked="" type="checkbox"/>	<input checked="" type="checkbox"/>	<input checked="" type="checkbox"/>	<input type="checkbox"/>	<input type="checkbox"/>	<input type="checkbox"/>	<input type="checkbox"/>	<input type="checkbox"/>	<input type="checkbox"/>	<input type="checkbox"/>			WT-1	

Activity	Method	Acres	Feet	MBF	Comment
4a - Herbicide Application	Aerial operation / applications	90.00	0	0	Listed as Map and unit #10 in original notification. Unit Name: Micheals Ck; Brand: Velpar DF, Sulfomet XP, Transline, Rodeo; Common: 2,4-D, Atrazine

Resource Name	Resource Description
Tributaries to Long Tom River	Tributaries to Long Tom River: Small Non-Fish Stream(s), Small Unknown
Tributary to Spring Creek	Tributary to Spring Creek: Small Non-Fish Stream(s)
Northern Spotted Owl site	
No Special Concerns Found.	

Subscribers: Jan Wroncy

Unit Information - Notification: 201378100210

Unit 8 of 9 Start: 03/15/13 End: 12/31/13

Status: Open

Stewardship Forester: Robin L. Biesecker

Site Conditions Waters: Lake or stream Within 100 feet.

Soils: No mass soil movement.

Slope: Greater than 65%.

SF Phone Number: (541)935-2283

Priorities: **Fire: Low FPA: High**

Twp	Rge	Sec	NE				NW				SW				SE				Government Lot Number	Tax Lot No.	Reg Use
			NE	NW	SW	SE	NE	NW	SW	SE	NE	NW	SW	SE	NE	NW	SW	SE			
16S	06W	5	<input type="checkbox"/>	<input type="checkbox"/>	<input type="checkbox"/>	<input type="checkbox"/>	<input type="checkbox"/>	<input type="checkbox"/>	<input checked="" type="checkbox"/>	<input type="checkbox"/>	<input type="checkbox"/>	<input checked="" type="checkbox"/>	<input type="checkbox"/>	<input type="checkbox"/>	<input type="checkbox"/>	<input type="checkbox"/>	<input type="checkbox"/>			WT-1	

Activity	Method	Acres	Feet	MBF	Comment
4a - Herbicide Application	Aerial operation / applications	48.00	0	0	Unit Name: Dump Tower; Brand: Velpar DF, Sulfomet XP, Transline, Rodeo; Common: 2,4-D, Atrazine

Resource Name	Resource Description
Tributaries to Long Tom River	Tributaries to Long Tom River: Medium Type F, Small Type F Stream(s)
Tributaries to Long Tom River	Small Unknown
	No Threatened or Endangered Species Found.
	No Special Concerns Found.

Subscribers: Jan Wroncy



85647 Hwy 99 S
Eugene OR 97405-9542
PO Box 1819
Eugene OR 97440-1819
Tel (541) 744 4600
Fax (541) 744 4679

WRITTEN PLAN OF OPERATION FOR AERIAL HERBICIDE APPLICATION

Weyerhaeuser Company is planning aerial broadcast spray applications targeting broadleaf and/or herbaceous vegetation near protected resources. This letter is our submission of a written plan of operation for activities within 100 feet of protected resources. The attached plat shows the unit boundaries and resources to be protected. Chemical will not be mixed, handled or staged with 100 feet of protected resources.

No herbicide will be directly applied within 60 feet of the high water mark of any protected resource defined as F or D stream, lakes, significant wetlands and other areas of standing open water greater than one-quarter acre at the time of application. No treatment of timbered buffers left during harvest within 100 feet of protected resources will be done. All application will be done in compliance with the Oregon Forest Practices Rules and label instructions. The helicopter pilot will have a current map and/or aerial photo showing locations of the unit boundaries and resources requiring protection. Application of herbicide within the 100 ft adjacent to the protected resources will be flown parallel to the stream.

Unit # 1305 (WL#1)

Legal Description: 34-155-6W

Stream & Classification SF WILLAMETTE TRIB

Sincerely,

Jeff Yost, Forester

2-18-12

Operator

Date

FPF

Date

WL # 1

Weyerhaeuser Company
South Valley Western Timberlands
P.O. Box 1819, Eugene, OR 97440
(541) 744-4600 (541) 746-2511 [24 hrs.]

Area/Road No. HIGH PASS 34

Aerial Herbicide Application Report

District: South Valley

Season SPRING 2013

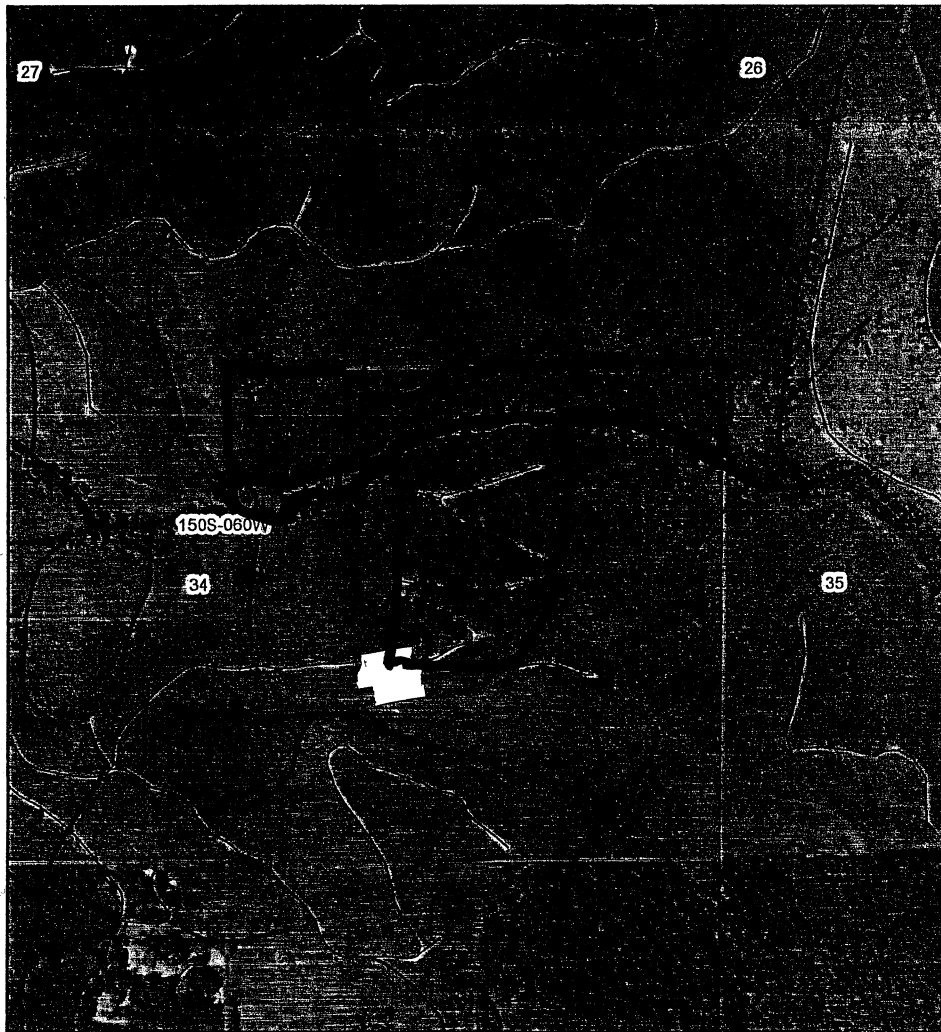

Sec(s)	<u>34</u>		
Twp(s)	<u>153</u>		
Rge(s)	<u>6W</u>		

Elevation: _____ Scale 1" = 1,000'

Unit(s)	Date(s)	Time of Day (Begin/End)
		/
		/
		/

Type of Equipment: HELICOPTER

Application Method: BROADCAST

Contractor/Co.: _____

Full name of applicator/certification #: _____

FAA No.: _____

Boom Type: _____

Nozzle Size: _____

Pressure: _____

Date	Time	Temp °F/F	Wind Dir/Spd	RH%

Reforestation Unit #: _____

Chemical Supplier: Helena Wilbur-Ellis

 Containers rinsed at least 3x & recycled

Comments: _____

Date _____ By _____

Note: This record shall be kept for 3 years in accordance with ORS 634.146.

Unit	Acres	Chemical/Ac (Trade Name)		Surfactant-Carrier/Ac			Water G/Acre	Total G/Acre	Site Prep	Release	Target Species
		Chemical									
<u>1305</u>	<u>44</u>									<u>X</u>	<u>G&F</u>
Actual											

Written plan required? Yes No

Resource to be protected: SF TRILB TO WILLAMETTE

Submitted to: _____ Date: _____

Operator Signed: _____ Date: _____

Date State Notification Submitted: _____

Accord Conc./Rodeo # 62719-324, Sulfomet # 352-401-85588,
Transline # 62719-259, DMA 4 IVM Amine # 62719-3
Weedone LV 6 EC # 71368-11, _____

Additional Requirements

- Neighbor Notification: _____
- Wetland Protection: _____
- Open Water/Rainfall: _____
- T/E Protection: _____
- Other: _____

Notes: 15-day waiting period cannot be waived for aerial spray. Full name of all applicators and trainees applying pesticide must be recorded. All information must be recorded within 30 days following the pesticide application.



85647 Hwy 99 S
Eugene OR 97405-9542
PO Box 1819
Eugene OR 97440-1819
Tel (541) 744 4600
Fax (541) 744 4679

WRITTEN PLAN OF OPERATION FOR AERIAL HERBICIDE APPLICATION

Weyerhaeuser Company is planning aerial broadcast spray applications targeting broadleaf and/or herbaceous vegetation near protected resources. This letter is our submission of a written plan of operation for activities within 100 feet of protected resources. The attached plat shows the unit boundaries and resources to be protected. Chemical will not be mixed, handled or staged with 100 feet of protected resources.

No herbicide will be directly applied within 60 feet of the high water mark of any protected resource defined as F or D stream, lakes, significant wetlands and other areas of standing open water greater than one-quarter acre at the time of application. No treatment of timbered buffers left during harvest within 100 feet of protected resources will be done. All application will be done in compliance with the Oregon Forest Practices Rules and label instructions. The helicopter pilot will have a current map and/or aerial photo showing locations of the unit boundaries and resources requiring protection. Application of herbicide within the 100 ft adjacent to the protected resources will be flown parallel to the stream.

Unit # 1306 (WL#2)
Legal Description: 24-165-7W
Stream & Classification SF UNNAMED

Sincerely,

Jeff Yost, Forester

2-18-13

Operator

Date

FPF

Date

WL # 2

Weyerhaeuser Company
South Valley Western Timberlands
P.O. Box 1819, Eugene, OR 97440
(541) 744-4600 (541) 746-2511 [24 hrs.]

Area/Road No. FISKARS

Aerial Herbicide Application Report

District: South Valley

Season SPRING 2013

Sec(s)	<u>24</u>		
Twp(s)	<u>16S</u>		
Rge(s)	<u>7W</u>		

Elevation: _____ Scale 1" = 1,000'

Unit(s)	Date(s)	Time of Day (Begin/End)
		/
		/
		/

Type of Equipment: HELICOPTER
Application Method: BROADCAST
Contractor/Co.: _____
Full name of applicator/certification #: _____

FAA No.: _____
Boom Type: _____
Nozzle Size: _____
Pressure: _____

Date	Time	Temp °F/°F	Wind Dir/Spd	RH%

Reforestation Unit #: _____
Chemical Supplier: Helena Wilbur-Ellis
____ Containers rinsed at least 3x & recycled
Comments: _____

Date _____ By _____



Note: This record shall be kept for 3 years in accordance with ORS 634.146.

Unit	Acres	Chemical/Ac (Trade Name)				Surfactant-Carrier/Ac				Water G/Acre	Total G/Acre	Site Prep	Release	Target Species
		Chemical												
<u>1306</u>	<u>73</u>												<u>X</u>	<u>GLF</u>
Actual														

Written plan required? Yes No
Resource to be protected: SF
Submitted to: _____ Date: _____
Operator Signed: _____ Date: _____
Date State Notification Submitted: _____

Additional Requirements

Neighbor Notification: _____

Wetland Protection: _____

Open Water/Rainfall: _____

T/E Protection: _____

Other: _____

Notes: 15-day waiting period cannot be waived for aerial spray.
Full name of all applicators and trainees applying pesticide must be recorded. All information must be recorded within 30 days following the pesticide application.

Accord Conc./Rodeo # 62719-324, Sulfomet # 352-401-85588,
Transline # 62719-259, DMA 4 IVM Amine # 62719-3
Weedone LV 6 EC # 71368-11, _____



85647 Hwy 99 S
Eugene OR 97405-9542
PO Box 1819
Eugene OR 97440-1819
Tel (541) 744 4600
Fax (541) 744 4679

WRITTEN PLAN OF OPERATION FOR AERIAL HERBICIDE APPLICATION

Weyerhaeuser Company is planning aerial broadcast spray applications targeting broadleaf and/or herbaceous vegetation near protected resources. This letter is our submission of a written plan of operation for activities within 100 feet of protected resources. The attached plat shows the unit boundaries and resources to be protected. Chemical will not be mixed, handled or staged with 100 feet of protected resources.

No herbicide will be directly applied within 60 feet of the high water mark of any protected resource defined as F or D stream, lakes, significant wetlands and other areas of standing open water greater than one-quarter acre at the time of application. No treatment of timbered buffers left during harvest within 100 feet of protected resources will be done. All application will be done in compliance with the Oregon Forest Practices Rules and label instructions. The helicopter pilot will have a current map and/or aerial photo showing locations of the unit boundaries and resources requiring protection. Application of herbicide within the 100 ft adjacent to the protected resources will be flown parallel to the stream.

Unit # 1314 (DWL #8)

Legal Description: 5-165-6W

Stream & Classification SF+MF TRIB TO LONG TRM

Sincerely,

Jeff Yost, Forester

2-18-13

Operator

Date

FPF

Date

WL # 8

Weyerhaeuser Company
 South Valley Western Timberlands
 P.O. Box 1819, Eugene, OR 97440
 (541) 744-4600 (541) 746-2511 [24 hrs.]

Area/Road No. DUMP TOWER

Aerial Herbicide Application Report

District: South Valley

Season SPRING 2013



Sec(s)	<u>5</u>		
Twps(s)	<u>165</u>		
Rgs(s)	<u>6W</u>		

Elevation: _____ Scale 1" = 1,000'

Unit(s)	Date(s)	Time of Day (Begin/End)
		/
		/
		/

Type of Equipment: HELICOPTER
 Application Method: BROADCAST
 Contractor/Co.: _____
 Full name of applicator/certification #: _____

FAA No.: _____
 Boom Type: _____
 Nozzle Size: _____
 Pressure: _____

Date	Time	Temp °F/°F	Wind Dir/Spd	RH%

Reforestation Unit #: _____
 Chemical Supplier: Helena Wilbur-Ellis
 Containers rinsed at least 3x & recycled
 Comments: _____

Date _____ By _____

Note: This record shall be kept for 3 years in accordance with ORS 63.4.146.

Unit	Acres	Chemical/Ac (Trade Name)		Surfactant-Carrier/Ac		Water G/Acre	Total G/Acre	Site Prep	Release	Target Species
		Chemical								
<u>1314</u>	<u>48</u>								<u>X</u>	<u>GTF</u>
Actual										

Written plan required? Yes No
 Resource to be protected: then SF & MF TRIB
 Submitted to: _____ Date: _____
 Operator Signed: _____ Date: _____
 Date State Notification Submitted: _____

Additional Requirements

Neighbor Notification: _____
 Wetland Protection: _____
 Open Water/Rainfall: _____
 T/E Protection: _____
 Other: _____

Notes: 15-day waiting period cannot be waived for aerial spray.
 Full name of all applicators and trainees applying pesticide must be recorded. All information must be recorded within 30 days following the pesticide application.

Accord Conc./Rodeo # 62719-324, Sulfomet # 352-401-85588,
 Transline # 62719-259, DMA 4 IVM Amine # 62719-3
 Weedone LV 6 EC #71368-11, _____

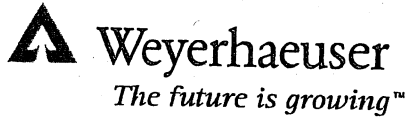

85647 Hwy 99 S
Eugene OR 97405-9542
PO Box 1819
Eugene OR 97440-1819
Tel (541) 744 4600
Fax (541) 744 4679

WRITTEN PLAN OF OPERATION FOR AERIAL HERBICIDE APPLICATION

Weyerhaeuser Company is planning aerial broadcast spray applications targeting broadleaf and/or herbaceous vegetation near protected resources. This letter is our submission of a written plan of operation for activities within 100 feet of protected resources. The attached plat shows the unit boundaries and resources to be protected. Chemical will not be mixed, handled or staged with 100 feet of protected resources.

No herbicide will be directly applied within 60 feet of the high water mark of any protected resource defined as F or D stream, lakes, significant wetlands and other areas of standing open water greater than one-quarter acre at the time of application. No treatment of timbered buffers left during harvest within 100 feet of protected resources will be done. All application will be done in compliance with the Oregon Forest Practices Rules and label instructions. The helicopter pilot will have a current map and/or aerial photo showing locations of the unit boundaries and resources requiring protection. Application of herbicide within the 100 ft adjacent to the protected resources will be flown parallel to the stream.

Unit # 1317 (WL #10)

Legal Description: 18-165-6W

Stream & Classification SF TRIB TO LONG TOM

Sincerely,

Jeff Yost, Forester

2-18-12

Operator

Date

FPF

Date

WL #10

Weyerhaeuser Company
South Valley Western Timberlands
P.O. Box 1819, Eugene, OR 97440
(541) 744-4600 (541) 746-2511 [24 hrs.]

Area/Road No. MICHEALS CR

Aerial Herbicide Application Report

District: South Valley

Season SPRING 2013



Sec(s)	<u>18</u>		
Twp(s)	<u>16S</u>		
Rge(s)	<u>6W</u>		

Elevation: _____ Scale 1" = 1,000'

Unit(s)	Date(s)	Time of Day (Begin/End)
		/
		/
		/

Type of Equipment: HELICOPTER
Application Method: BROADCAST
Contractor/Co.: _____
Full name of applicator/certification #: _____

FAA No.: _____
Boom Type: _____
Nozzle Size: _____
Pressure: _____

Date	Time	Temp °F/°F	Wind Dir/Spd	RH%

Reforestation Unit #: _____
Chemical Supplier: Helena Wilbur-Ellis
Containers rinsed at least 3x & recycled
Comments: _____

Date _____ By _____

Note: This record shall be kept for 3 years in accordance with ORS 634.146.

Unit	Acres	Chemical/Ac (Trade Name)				Surfactant-Carrier/Ac				Water G/Acre	Total G/Acre	Site Prep	Release	Target Species
		Chemical												
<u>1317</u>	<u>90</u>												<u>X</u>	<u>6+P</u>
Actual														

Written plan required? Yes No

Resource to be protected: Man SF
Submitted to: _____ Date: _____
Operator Signed: _____ Date: _____
Date State Notification Submitted: _____

Accord Conc./Rodeo # 62719-324, Sulfomet # 352-401-85588,
Transline # 62719-259, DMA 4 IVMAmine # 62719-3
Weedone LV 6 EC # 71368-11, _____

Additional Requirements

- Neighbor Notification: _____
- Wetland Protection: _____
- Open Water/Rainfall: _____
- T/E Protection: _____
- Other: _____

Notes: 15-day waiting period cannot be waived for aerial spray.
Full name of all applicators and trainees applying pesticide must be recorded. All information must be recorded within 30 days following the pesticide application.