



State of Oregon
Department of Forestry - Department of Revenue
Notification Number: 2013-781-00849
Timber Sale: In-Unit Scotch Broom

Attached is the processed information from the Notification of Operation/Application for Permit signed by Mike L. Emmons representing the Land Owner, and received by Department of Forestry on September 13, 2013. Please review this information and retain for future reference.

Notices and Permits

Notice is given to the State Forester that an operation will be conducted on the lands described herein.

SF Comments: Applicant Remarks: Manual application with CP3 backpack or slip-in truck mounted sprayer.	
<p style="text-align: center;">LEGAL NOTICE</p> <p>The following section provides legal notification of the requirement to submit a written plan before certain portions of this Operation may begin. The requirements are indicated below:</p> <p>Based on information provided by the applicant, no Written Plans were required at the time this notice was sent. Written Plans may be required at a future date if new protected resources or other information is discovered.</p>	<p>Notification 15 Day Waiting Period: This Operation is subject to the 15 day Waiting Period.</p> <p>Operator: Avel Salgado Oregon Forest Management Services 41580 Deerhorn Road Springfield, OR 97478 (541) 520-5941</p> <p>Fire Contact: Ted Reiss (541) 607-7299</p> <p>Land Owner: Mike Emmons Seneca Jones Timber Company P.O. Box 10265 Eugene, OR 97440 (541) 689-1011</p> <p>Timber Owner:</p>
<p>District: Western Lane</p> <p>Office: Veneta Unit</p> <p>County: Lane</p>	

(Subscriber Copy)

Doug Decker, State Forester
Link Smith, District Forester

Unit Information - Notification: 201378100849

Unit 4 of 5 Start: 09/30/13 End: 12/31/13

Status: Open

Stewardship Forester: Brian Peterson

Site Conditions Waters: Lake or stream Within 100 feet.

Soils: No mass soil movement.

Slope: 0% to 35%.

SF Phone Number:

Priorities: Fire: Low FPA: Medium

Twp	Rge	Sec	NE				NW				SW				SE				Government Lot Number	Tax Lot No.	Reg Use
			NE	NW	SW	SE	NE	NW	SW	SE	NE	NW	SW	SE	NE	NW	SW	SE			
19S	04W	23	<input type="checkbox"/>	<input type="checkbox"/>	<input type="checkbox"/>	<input type="checkbox"/>	<input type="checkbox"/>	<input type="checkbox"/>	<input type="checkbox"/>	<input type="checkbox"/>	<input type="checkbox"/>	<input type="checkbox"/>	<input type="checkbox"/>	<input type="checkbox"/>	<input type="checkbox"/>	<input type="checkbox"/>	<input type="checkbox"/>	<input type="checkbox"/>			WT-1
19S	04W	24	<input type="checkbox"/>	<input type="checkbox"/>	<input type="checkbox"/>	<input type="checkbox"/>	<input type="checkbox"/>	<input type="checkbox"/>	<input type="checkbox"/>	<input type="checkbox"/>	<input checked="" type="checkbox"/>	<input checked="" type="checkbox"/>	<input checked="" type="checkbox"/>	<input checked="" type="checkbox"/>	<input type="checkbox"/>	<input checked="" type="checkbox"/>	<input checked="" type="checkbox"/>	<input type="checkbox"/>			WT-1

Activity	Method	Acres	Feet	MBF	Comment
4a - Herbicide Application	Manual application or operation	90.00	0	0	Weiss Units; Brand: Milestone VM, 2,4-D LV6; Common: Glyphosate, Triclopyr; Additives: Methylated Seed Oil; AppRate: 1-2%, 2%, 7 oz; Comments: 10 gal/ac

Resource Name

Tributaries to Camas Swale Creek

Resource Description

Tributaries to Camas Swale Creek: Small Unknown

No Threatened or Endangered Species Found.

No Special Concerns Found.

Subscribers: Forestland Dwellers, Illahe Farm



SENECA JONES TIMBER COMPANY

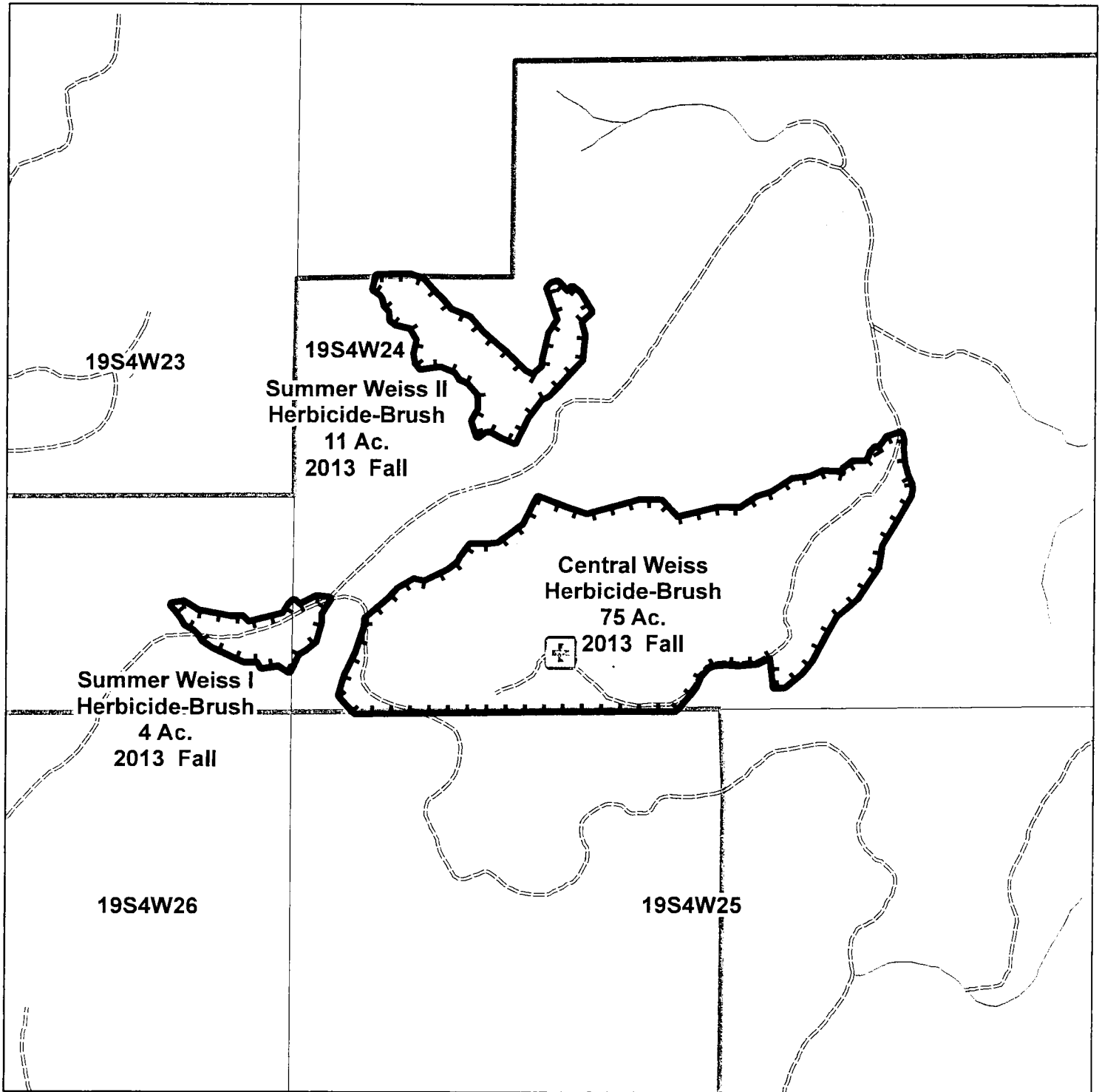

1 inch = 833 feet

Date: 8/21/2013

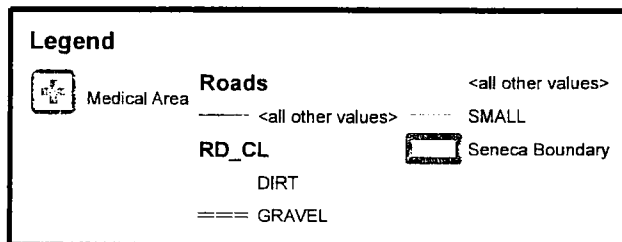

Silviculture Map

MEDICAL AREA

LAT: 123 7' 13.207"W

LONG 43 53' 46.94"N



SENECA JONES TIMBER COMPANY

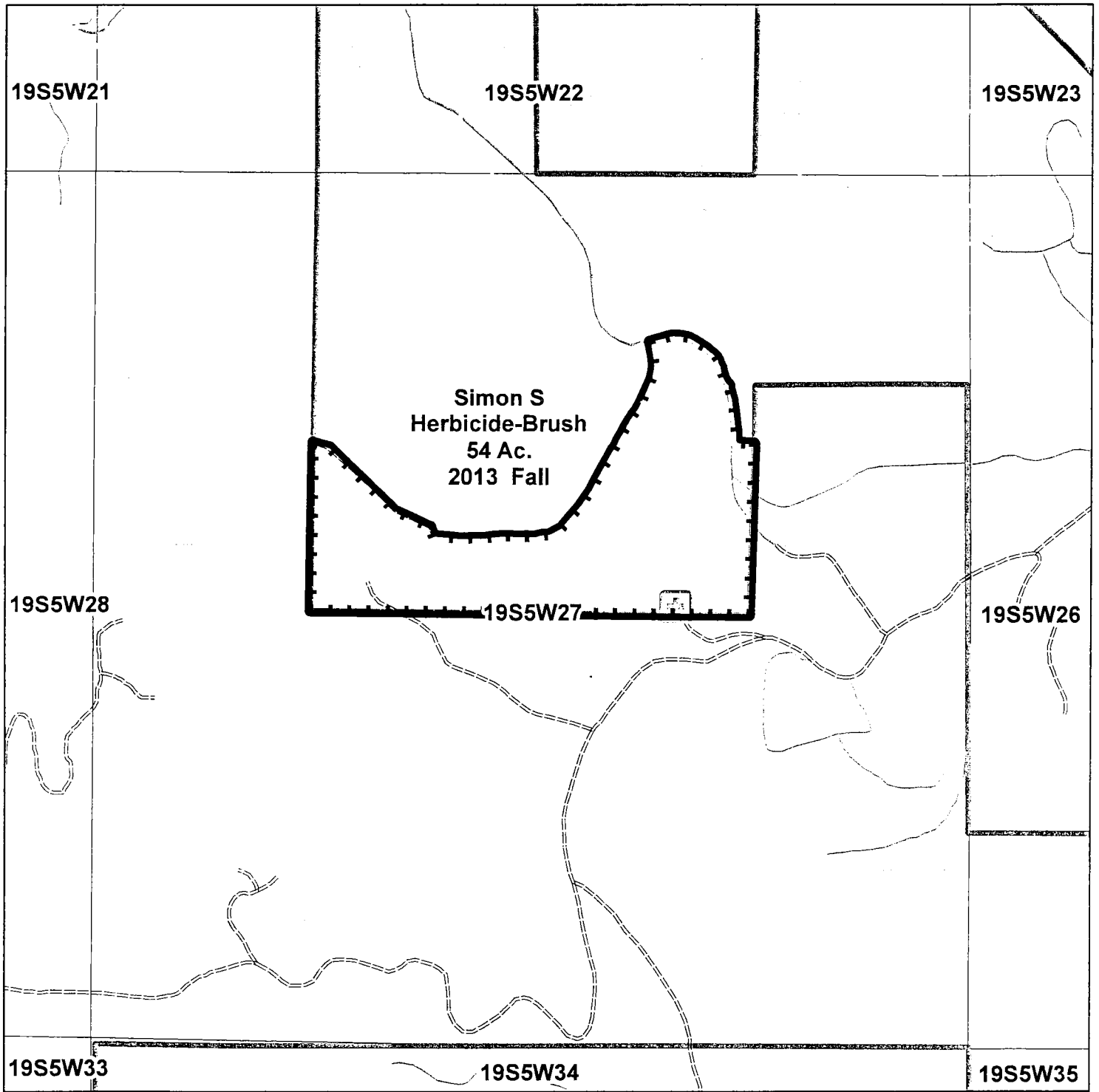

1 inch = 833 feet

Date: 8/28/2013

Legend		
	Medical Area	
Roads		
	<all other values>	
RD_CL		
	DIRT	
	PAVED	
	GRAVEL	
	Seneca Boundary	
		<all other values>
		MEDIUM
		SMALL

Silviculture Map

MEDICAL AREA

LAT: 123 16' 24.702"W

LONG 43 53' 19.929"N