



State of Oregon
Department of Forestry - Department of Revenue
Notification Number: 2015-781-02379
Operation Name: Alsea District Wide Spray

This report is the processed information from the Notification of Operation/Application for Permit to Operate Power Driven Machinery submitted by Gregory Wade Stringham and received by Department of Forestry on 1/26/2015.

You must wait at least 15 days after successful submittal of this notification before starting the activities in the notification (see OAR 629-605-0150(1)). You may contact the Stewardship Forester to request a waiver of the 15-day waiting period. The waiting period remains in effect unless you receive notice from the Stewardship Forester that it is waived.

Notice and Permits

Notice is given to the State Forester that an operation will be conducted on the lands described herein.

A permit to use fire or operate power driven machinery is issued for the land described herein.

Oregon Department of Forestry Contact Information

ODF District: Western Lane
ODF Office: Veneta, Western Lane
Phone: (541) 935-2283
Stewardship Forester: Robin Biesecker
Email: Robin.Biesecker@Oregon.gov

Landowner(s)

Report generated on 2/8/2015 by Oregon Department of Forestry
Forest Activity Electronic Reporting and Notification System (FERNs)

..

Tall Corn Forestry, LLC c/o FIA, c/o MB&G
33 North Central Ave, Suite 418
Medford, Oregon 97501
541-973-1951

Notice to Landowner(s)

Reforestation may be required by the landowner if timber harvesting is part of the proposed operations.

On-site inspections may be conducted by Oregon Department of Forestry employees to ensure compliance with all laws and rules governing fire protection and forest practices on private land.

Land use conversion to non-forest use involves regulations administered by other state and local governments, which may apply to the future use or development of this site.

Notice to Operator(s)

If you are conducting timber harvesting or road construction within 100 feet of overhead utility lines contact the local utility in accordance with ORS 757.805 - Oregon's Overhead Safety Act and OAR 437-007-0230 - Power Line Safeguards. Identification tags are located on each pole.

Call the Oregon Utility Notification Center at 811 at least 2 business days before starting timber harvesting, road construction, or any other activities involving excavation that may affect an underground utility line. The Center will coordinate with the appropriate utility companies to locate underground utility lines that may be affected by your activities.

Fire Emergency Contact

Wade Stringham
541-973-1953

LEGAL NOTICE

The following section provides legal notification of the requirement to submit a written plan

Report generated on 2/8/2015 by Oregon Department of Forestry
Forest Activity Electronic Reporting and Notification System (FERNS)

before certain portions of this Operation may begin.

Based on information provided by the applicant, no Statutory Written Plan is required at the time this notice was sent. A Statutory Written Plan may be required at a future date if new protected resources or other information is discovered.

Non-Statutory Written Plan:

A Non-Statutory Written Plan may be required for resources or conditions in or near this Operation as determined by the Stewardship Forester, OAR 626-605-0170(10).

Unit: Alsea District Wide Spray:

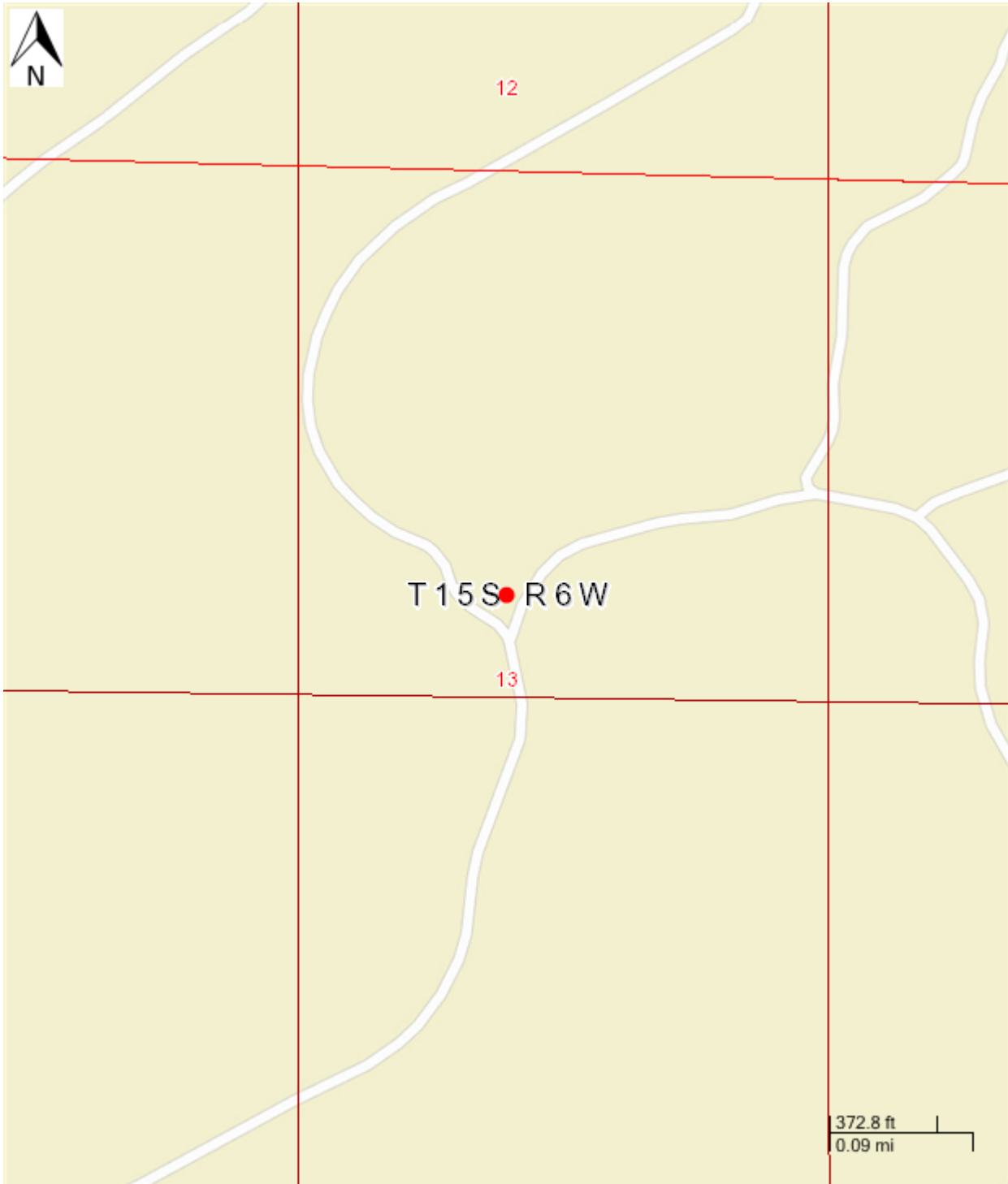

Report generated on 2/8/2015 by Oregon Department of Forestry
Forest Activity Electronic Reporting and Notification System (FERNS)

Unit: Alsea District Wide Spray - Activities

Activity: Herbicide Application (County-wide roadside or spot treatment)

Quantity:

Start: 2/16/2015 End: 12/31/2015

Method(s): Ground - Manual spot application

Chemical(s): 2,4-D with acid (acid) and 2,4-D with amine (amine) and 2,4-D with ester (ester) and 2,4-D & Picloram (amine) and 2,4-D & dicamba (ester) and aminopyralid and Metsulfuron methyl and atrazine and clopyralid and dicamba and fluroxypyr and glyphosate and hexazinone and hexazinone & sulfometuron methyl and imazapyr and imazapyr & metsulfuron methyl and metsulfuron methyl and picloram and pyraflufen ethyl and sulfometuron methyl and sulfometuron methyl & metsulfuron methyl and triclopyr with ester (ester) and triclopyr with amine (amine) and triclopyr with acid (acid) and triclopyr & aminopyralid (amine)

Chemical Carrier(s): Forest Crop Oil (Additive) and Mineral Oil, Alkylphenol polyoxyethylene (contains petroleum distillates) and Petroleum oil, Polyoxyethylene sorbitan fatty acid ester (contains petroleum distillates) and W.E.B. Oil and diesel oil and grain and petroleum oil, emulsifier and water

Chemical Additive(s):

Remarks: District Wide Spray. Roadside and spot spray treatment of vegetation.

Operator:

Tim Sweet
Rye Tree Service Inc
9551 N. Fork Siuslaw Road
Florence, Oregon 97439
5419990295

Site Conditions

Resources that may require a written plan:

Stream within 100 feet of area.

Seep or spring within 100 feet of area.

Map of Operation

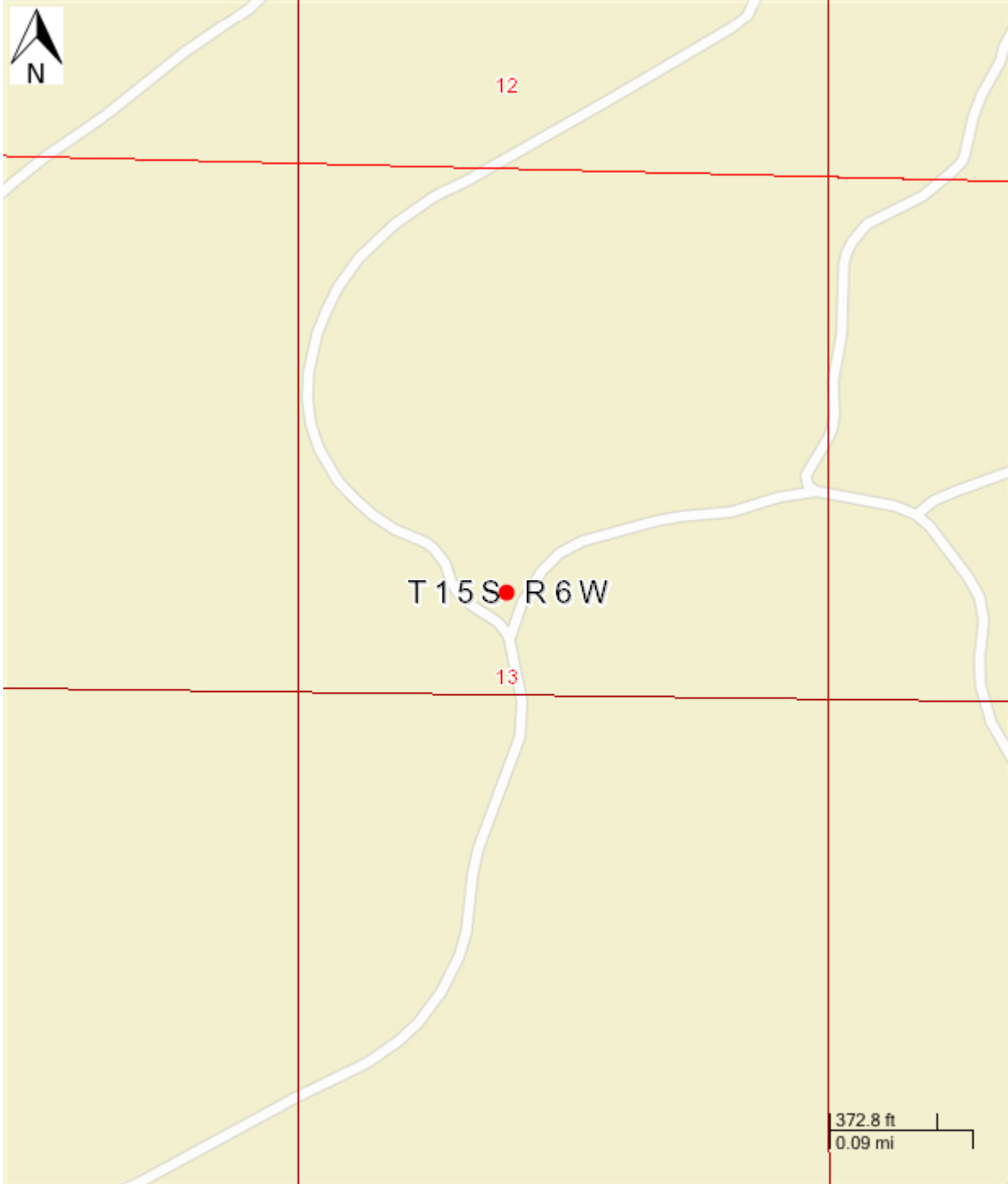

Report generated on 2/8/2015 by Oregon Department of Forestry
Forest Activity Electronic Reporting and Notification System (FERNS)