



**State of Oregon**  
**Department of Forestry - Department of Revenue**  
**Notification Number: 2014-781-05981**  
**Operation Name: Penn Road herbicide**

This report is the processed information from the Notification of Operation/Application for Permit to Operate Power Driven Machinery submitted by Gordon Kempe Culbertson and received by Department of Forestry on 10/21/2014.

You must wait at least 15 days after successful submittal of this notification before starting the activities in the notification (see OAR 629-605-0150(1)). You may contact the Stewardship Forester to request a waiver of the 15-day waiting period. The waiting period remains in effect unless you receive notice from the Stewardship Forester that it is waived.

**Notice and Permits**

**Notice is given to the State Forester that an operation will be conducted on the lands described herein.**

**Oregon Department of Forestry Contact Information**

ODF District: Western Lane  
ODF Office: Veneta, Western Lane  
Phone: (541) 935-2283  
Stewardship Forester: Dan Menk  
Email: DMENK@ODF.STATE.OR.US

**Stewardship Forester Formal Comments**

Report generated on 2/10/2015 by Oregon Department of Forestry  
Forest Activity Electronic Reporting and Notification System (FERNs)

Comment from: Dan Menk 11/4/2014

This is regarding your Statutory Written Plan required by : • ORS 527. 670(3)(a) and OAR 629-605-0170(1)(a) for an operation within 100 feet of a Type F or Type D stream. After reviewing your written plan, I offer you the following comments. • Fully implementing this written plan is likely to achieve the resource protection standards. This operation will be evaluated on the basis of how well required practices are applied and how well required resource protection is achieved.

Comment from: David Kjosness 12/23/2014

Per mailed request from Gordon Culbertson on 12/23/14, this operation is continued into 2015.

### **Landowner(s)**

Gordon Kempe Culbertson  
Whitewater Forests LLC  
39074 Easton Lane  
Springfield, Oregon 97478  
541 285 3288

### **Notice to Landowner(s)**

Reforestation may be required by the landowner if timber harvesting is part of the proposed operations.

On-site inspections may be conducted by Oregon Department of Forestry employees to ensure compliance with all laws and rules governing fire protection and forest practices on private land.

Land use conversion to non-forest use involves regulations administered by other state and local governments, which may apply to the future use or development of this site.

### **Notice to Operator(s)**

If you are conducting timber harvesting or road construction within 100 feet of overhead utility lines contact the local utility in accordance with ORS 757.805 - Oregon's Overhead Safety Act and OAR 437-007-0230 - Power Line Safeguards. Identification tags are located on each pole.

Call the Oregon Utility Notification Center at 811 at least 2 business days before starting timber harvesting, road construction, or any other activities involving excavation that may affect an underground utility line. The Center will coordinate with the appropriate utility companies to locate underground utility lines that may be affected by your activities.

### **Fire Emergency Contact**

Gordon Culbertson  
541 285 3288

### **LEGAL NOTICE**

**The following section provides legal notification of the requirement to submit a written plan before certain portions of this Operation may begin.**

#### **Statutory Written Plan**

A Statutory Written Plan may be required before operation activities begin near the protected resources listed in the following Operation information page(s) or otherwise described to you by the Stewardship Forester, OAR 629-605-0170.

The Statutory Written Plan must describe in detail how the resource(s) will be protected during the operation. There is a waiting period for Statutory Written Plans that is separate from the notification waiting period. Contact the Stewardship Forester listed above for more information on Written Plans and waiting periods.

A portion or all of your operation(s) may be eligible for a waiver of the Statutory Written Plan requirement. Use the Resource Description information provided on the following Operation page(s) in conjunction with Technical Note #10 to determine your eligibility. Go to the following link or contact your Stewardship Forester for more information:

[http://www.oregon.gov/odf/PRIVATE\\_FORESTS/docs/20130816\\_Technote\\_Flowchart\\_Final.pdf](http://www.oregon.gov/odf/PRIVATE_FORESTS/docs/20130816_Technote_Flowchart_Final.pdf)

#### **Non-Statutory Written Plan:**

A Non-Statutory Written Plan may be required for resources or conditions in or near this Operation as determined by the Stewardship Forester, OAR 626-605-0170(10).



**Unit: Penn Road herbicide: 56.6 acres**

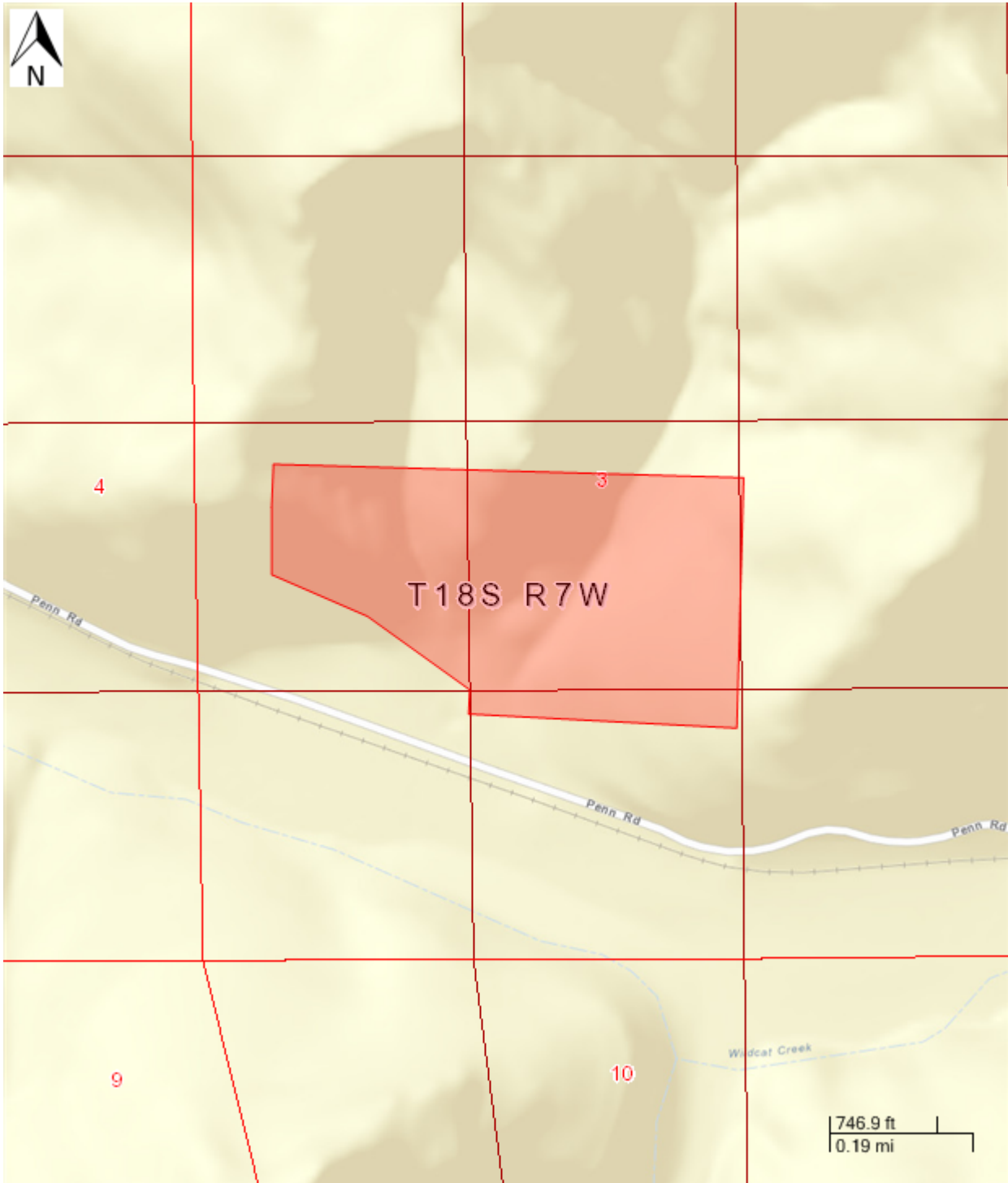

Report generated on 2/10/2015 by Oregon Department of Forestry  
Forest Activity Electronic Reporting and Notification System (FERNs)

**Unit: Penn Road herbicide - Activities**

**Activity: Herbicide Application (Unit)**

Quantity:

Start: 11/15/2014 End: 12/31/2015

Method(s): Ground - Manual spot application,

Chemical(s): Arsenal Applicator's Concentrate

Chemical Carrier(s): water

Chemical Additive(s):

Remarks: Treat lightly scattered hardwoods within 60 acre stand of 15-25 year old Douglas fir. Chemical used will be Arsenol mixed with water per labeled instructions, injected into machete chops on individual targeted stems. The ground slope is flat to moderate and all work will be easily done with hand labor.

**Operator:**

Gordon Kempe Culbertson  
Whitewater Forests LLC  
39074 Easton Lane  
Springfield, Oregon 97478  
541 285 3288

**Unit: Penn Road herbicide - Statutory Written Plan**

A Statutory Written Plan may be required for the resources detected in or near this Unit if activities occur within:

<b>100 Feet of</b>	<b>300 Feet of</b>
: Small Type F Stream	
: Small Type F Stream	

Please consult your Stewardship Forester about streams classified as Unknown.

## **Site Conditions**

### **Resources that may require a written plan:**

Stream within 100 feet of area.

## **Map of Operation**

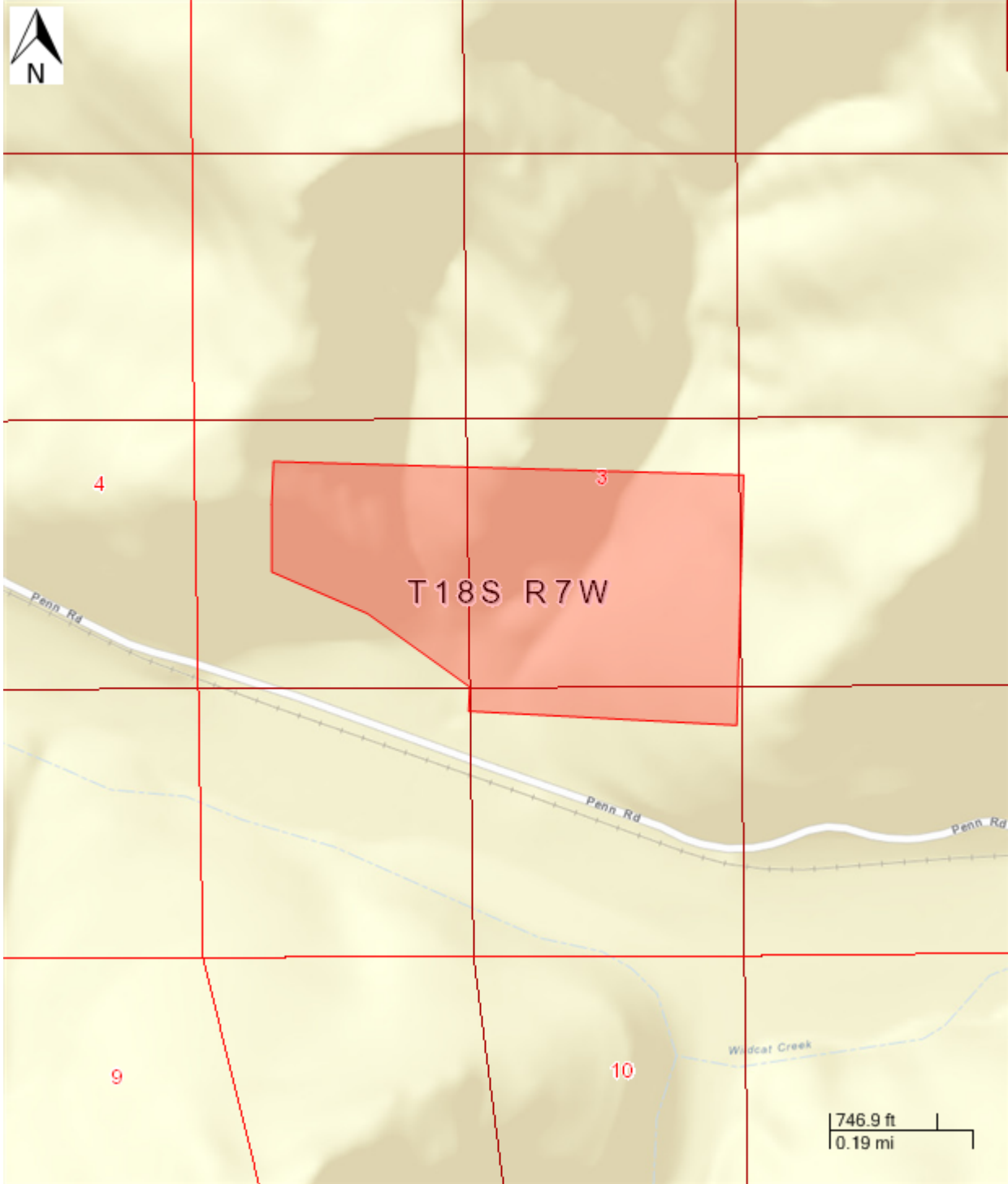

Report generated on 2/10/2015 by Oregon Department of Forestry  
Forest Activity Electronic Reporting and Notification System (FERNs)