

State of Oregon
Department of Forestry / Department of Revenue
Notification number: 2006-771-55628 [77122172] Prather Creek Roadside Spray

Attached is the processed information from the Notification of Operation and/or Application for Permits.
Please review this information and retain for future reference.

- Notice is given to the State Forester that an operation will be conducted on the lands described herein (ORS 527.670).

- A permit to operate power driven machinery is issued for the lands described herein (ORS 477.625)

Use ownership map for operator to determine F & D waters. Notify Water Master 15 days prior to operating.

I. WHERE TIMBER HARVESTING IS PART OF THE PROPOSED OPERATION:

A. NOTICE TO TIMBER OWNER: Party owning the harvested timber at the point it is first measured is shown in the section marked TIMBER OWNER and is responsible for payment of Oregon timber taxes.

B. NOTICE TO LAND OWNER: Party shown in the section marked LAND OWNER is responsible for reforestation of the site if so required.

District: **South Cascade**
Office: **Eastern Lane**

County: **Lane**
WOSTOT:

Received by ODF on **June 20, 2006** by fax

15 DAY WAITING PERIOD REQUIRED

II. WRITTEN PLANS:

- A WRITTEN PLAN may be required before certain activities can commence on the Operation.

A WRITTEN PLAN may be required for the situations indicated by an below. A WRITTEN PLAN must be submitted or a WRITTEN WAIVER must be obtained from the State Forester before any portion of the operation may commence.

- Within 100 feet of a large lake or Type F or Type D stream. [OAR 629-605-170(1)(a)]

- Within 300 feet of a wildlife resource site listed in the 1984 ODF/ODFW Cooperative Agreement. [OAR 629-605-170(1)(b)]

- Within 300 feet of any resource identified in the Divisions 645 or 665 of the administrative rules. [OAR 629-605-170(1)(c)]

- Within 300 feet of a state or federally listed threatened or endangered wildlife resource site. [OAR 629-605-170(1)(d)]

******* NOTICE *******

The State Forester has determined that the following items requiring your attention are located within or adjacent to your operation area:

- Concerns - Resources - Water

See Unit Information on subsequent pages for details.

Operator:

Weyerhaeuser Company-South Valley
85647 Highway 99 South
Eugene, OR 97405

Phone: (541) 744-4600

Land owner:

Weyerhaeuser Company-South Valley
85647 Highway 99 South
Eugene, OR 97405

Phone: (541) 744-4600

Timber owner:

Phone:

Marvin D. Brown
State Forester

Lena Tucker
District Forester

(Subscriber)

Unit: 1

Status: Active

Stewardship Forester: **Marvin Vetter**

Phone number: (541) 726-3588

Start date: 7/05/2006 End date: 12/31/2006

Site conditions: **Lake or Stream within 100 ft**
Slope of 0% to 35%
No mass soil movement

FP = L

FPA = H

Acres: 100 Feet: Estimated harvest: MBF

Activity: **Herbicide Application**

Methods: **Ground**

Brand name: **Accord Conc., 2,4-D LV6, Garlon 4,**

Carrier: **H2O**

Additives: **Moract, Herbimax, Induce**

App rate: **None**

Other information: **Garlon 3A, Escort, Chopper, Arsenal AC**

Sc	Twp	Rge	Government lot	N E				N W				S W				S E				Harv tax	Reg use
				n e	n w	s e	s w	n e	n w	s e	s w	n e	n w	s e	s w	n e	n w	s e	s w		
24	21S	01W		X	X	X	X	X	X	X	X	X	X	X	X	X	X	X	X		EL1
24	21S	01W		X	X	X	X	X	X	X	X	X	X	X	X	X	X	X	X		EL1
25	21S	01W		X	X	X	X	X	X	X	X	X	X	X	X	X	X	X	X		EL1
25	21S	01W		X	X	X	X	X	X	X	X	X	X	X	X	X	X	X	X		EL1
23	21S	01W		X	X	X	X	X	X	X	X	X	X	X	X	X	X	X	X		EL1
23	21S	01W		X	X	X	X	X	X	X	X	X	X	X	X	X	X	X	X		EL1

Water Concern Information

Description	Classification	Rule
Prather Creek	F str-med-sm-dom use WP may be required	
Prather Creek	F str-med-sm-dom use WP may be required	



South Valley Timberlands
P.O. Box 1819
Eugene, OR 97440-1819
541-744-4600 (phone)
541-744-4688 (fax)

WRITTEN PLAN OF OPERATION FOR ROADSIDE HERBICIDE APPLICATION

Weyerhaeuser Company is planning roadside/road surface spray applications targeting broadleaf and/or herbaceous vegetation near protected resources. This letter is our submission of a written plan of operation for activities within 100 feet of protected resources. The maps submitted with the ODF notification shows the Weyerhaeuser Property boundaries. All roads within the ownership on the notification may be sprayed. The known fish and domestic resources to be protected are shown on the maps. Chemical will not be mixed, handled or staged with 100 feet of protected resources.

No herbicide will be directly applied within 10 feet of the high water mark of any protected resource defined as F or D stream, lakes, significant wetlands and other areas of standing open water greater than one-quarter acre at the time of application. All application will be done in compliance with the Oregon Forest Practices Rules and label instructions.

Landowner will identify the above-protected resources with crew foreman prior to application by means of aerial photos, maps and/or ground visits to provide operator with adequate information to properly treat the area.

Sincerely,

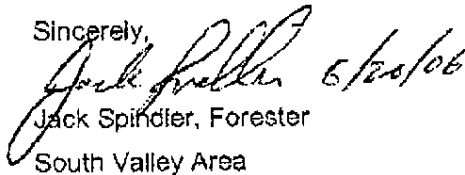
Jack Spindler, Forester
South Valley Area

Operator

Date

2006 South Valley Roadside Spray Project



21S1W

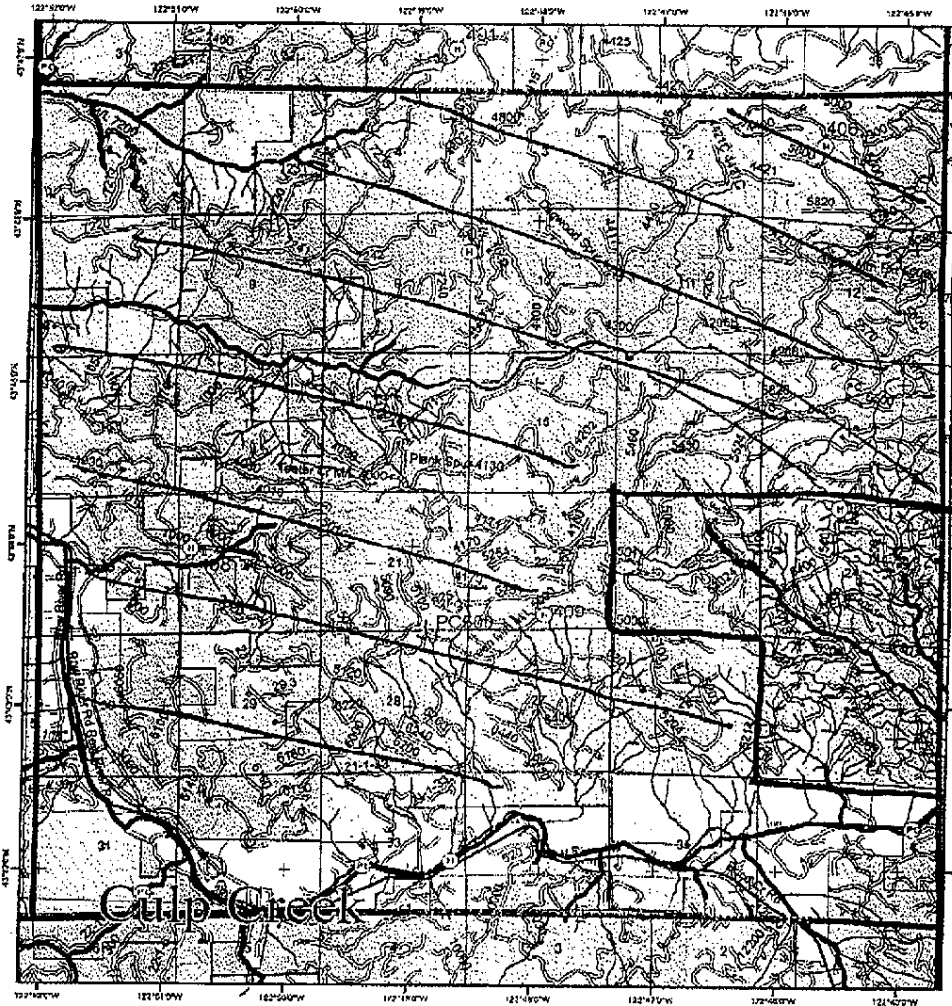
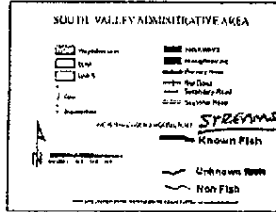

PERMIT AREA

Culp Creek