

State of Oregon
Department of Forestry / Department of Revenue
Notification number: 2006-771-55793 [77122337] Site Prep Spraying

Attached is the processed information from the Notification of Operation and/or Application for Permits.
Please review this information and retain for future reference.

- Notice is given to the State Forester that an operation will be conducted on the lands described herein (ORS 527.670).

Written plan required if working within 100' of King Creek or King Creek trib. Waiver for areas greater than 100' from fish or domestic streams.

I. WHERE TIMBER HARVESTING IS PART OF THE PROPOSED OPERATION:

District: **South Cascade**
Office: **Eastern Lane**

A. NOTICE TO TIMBER OWNER: Party owning the harvested timber at the point it is first measured is shown in the section marked TIMBER OWNER and is responsible for payment of Oregon timber taxes.

County: **Lane**
WOSTOT:

B. NOTICE TO LAND OWNER: Party shown in the section marked LAND OWNER is responsible for reforestation of the site if so required.

Received by ODF on August 2, 2006 by fax

15 DAY WAITING PERIOD WAIVED

II. WRITTEN PLANS:

Waived by Marvin Vetter on 8/15/2006

- A WRITTEN PLAN may be required before certain activities can commence on the Operation.

***** N O T I C E *****

A WRITTEN PLAN may be required for the situations indicated by an below. A WRITTEN PLAN must be submitted or a WRITTEN WAIVER must be obtained from the State Forester before any portion of the operation may commence.

The State Forester has determined that the following items requiring your attention are located within or adjacent to your operation area:

- Within 100 feet of a large lake or Type F or Type D stream.
[OAR 629-605-170(1)(a)]

- Concerns - Resources - Water

See Unit Information on subsequent pages for details.

- Within 300 feet of a wildlife resource site listed in the 1984 ODF/ODFW Cooperative Agreement. [OAR 629-605-170(1)(b)]

Operator:

- Within 300 feet of any resource identified in the Divisions 645 or 665 of the administrative rules. [OAR 629-605-170(1)(c)]

Dole Land Management Inc
28471 Gimpl Hill Road
Eugene, OR 97402

Phone: (541) 484-0509

- Within 300 feet of a state or federally listed threatened or endangered wildlife resource site. [OAR 629-605-170(1)(d)]

Land owner:

Please contact the Oregon Department of Forestry forester named on the Unit Information sheet for further information on requirements that may be necessary to meet before any activity/operation begins.

Rosboro Lumber Company
P.O. Box 20
Springfield, OR 97477

Phone: (541) 746-8411

Signed by James A. Dole - representing the Operator.

Timber owner:

Phone:

(Subscriber)

Marvin D. Brown
State Forester

Lena Tucker
District Forester

Unit: 1

Status: Active

Stewardship Forester: **Tim Meehan**

Phone number: (541) 726-3588

Start date: 8/16/2006

End date: 12/31/2006

Site conditions: **Lake or Stream within 100 ft**
Slope of 0% to 35%
No mass soil movement

FP = L

FPA = L

Acres: 168

Feet:

Estimated harvest: MBF

Activity: **Herbicide Application**

Methods: **Ground**

Brand name: **Accord, Chopper, Oust, Phase**

Carrier: H2O

Additives: **None**

App rate: **48 Oz/Acre, 8 Oz/Acre, 4 Oz/Ac**

Other information: **3 Oz/Acre**

Sc	Twp	Rge	Government lot	N E				N W				S W				S E				Harv tax	Reg use
				n	n	s	s	n	n	s	s	n	n	s	s	n	n	s	s		
				e	w	w	e	e	w	w	e	e	w	w	e	e	w	w	e		
22	16S	05E																			EL1
22	16S	05E																	X		EL1
23	16S	05E										X	X	X		X	X				EL1
23	16S	05E										X	X	X		X	X				EL1
26	16S	05E						X	X												EL1
26	16S	05E						X	X												EL1

Water Concern Information

Description	Classification	Rule
King Creek	F str-lg WP may be required	7A0
King Creek	F str-lg WP may be required	

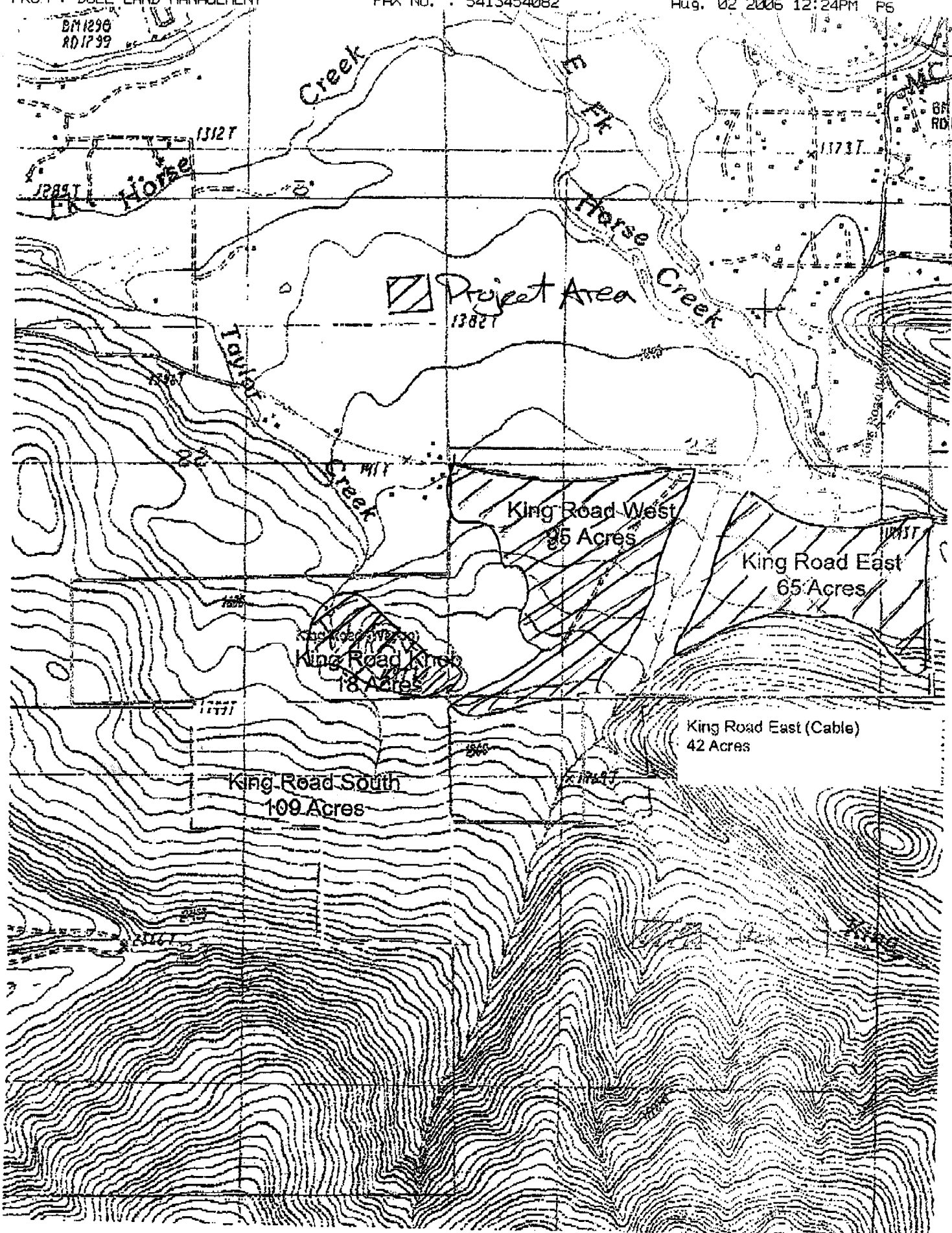

BM 1296
RD 1739

Creek

m

Horse

Project Area

King Road West
25 Acres

King Road East
65 Acres

King Road Knob
18 Acres

King Road East (Cable)
42 Acres

King Road South
109 Acres

1312T

1285T

1173T

1382T

1181T

1277T

1565

12184T