

State of Oregon  
Department of Forestry / Department of Revenue  
Notification number: 2006-771-55836 [77122380] 2006 GR Roadside Spray

Attached is the processed information from the Notification of Operation and/or Application for Permits.  
Please review this information and retain for future reference.

- Notice is given to the State Forester that an operation will be conducted on the lands described herein (ORS 527.670).
- A permit to operate power driven machinery is issued for the lands described herein (ORS 477.625)

Written plan received 8/16/06.

I. WHERE TIMBER HARVESTING IS PART OF THE PROPOSED OPERATION:

A. NOTICE TO TIMBER OWNER: Party owning the harvested timber at the point it is first measured is shown in the section marked TIMBER OWNER and is responsible for payment of Oregon timber taxes.

B. NOTICE TO LAND OWNER: Party shown in the section marked LAND OWNER is responsible for reforestation of the site if so required.

II. WRITTEN PLANS:

- A WRITTEN PLAN may be required before certain activities can commence on the Operation.

A WRITTEN PLAN may be required for the situations indicated by an  below. A WRITTEN PLAN must be submitted or a WRITTEN WAIVER must be obtained from the State Forester before any portion of the operation may commence.

- Within 100 feet of a large lake or Type F or Type D stream. [OAR 629-605-170(1)(a)]
- Within 300 feet of a wildlife resource site listed in the 1984 ODF/ODFW Cooperative Agreement. [OAR 629-605-170(1)(b)]
- Within 300 feet of any resource identified in the Divisions 645 or 665 of the administrative rules. [OAR 629-605-170(1)(c)]
- Within 300 feet of a state or federally listed threatened or endangered wildlife resource site. [OAR 629-605-170(1)(d)]

Please contact the Oregon Department of Forestry forester named on the Unit Information sheet for further information on requirements that may be necessary to meet before any activity/operation begins.

Signed by Jeremy Norby - representing the Land owner.

District: **South Cascade**  
Office: **Eastern Lane**

County: **Lane**  
WOSTOT:

Received by ODF on August 21, 2006 by mail

**\*15 DAY WAITING PERIOD REQUIRED\***

\*\*\*\*\* N O T I C E \*\*\*\*\*

The State Forester has determined that the following items requiring your attention are located within or adjacent to your operation area:

- Concerns  - Resources  - Water

See Unit Information on subsequent pages for details.

Operator:

Strata Forestry, Inc.  
100 W. Q Street  
Springfield, OR 97477  
Phone: ( 541 ) 726-0845

Land owner:

Giustina Resources Limited Partne  
P O Box 529  
Eugene, OR 97440  
Phone: ( 541 ) 485-1500

Timber owner:

Phone:

Marvin D. Brown                      Lena Tucker  
State Forester                      District Forester

(Subscriber)

Unit: 1

Status: Active

Stewardship Forester: Tim Meehan

Phone number: (541) 726-3588

Start date: 8/28/2006

End date: 12/31/2006

Site conditions: Lake or Stream within 100 ft  
 Slope of 0% to 35%  
 No mass soil movement

FP = L

FPA = H

Acres: Feet: 4200

Estimated harvest: MBF

Activity: Herbicide Application

Methods: Ground

Brand name: Garlon 3A, Hasten, Milestone

Carrier: H2O

Additives: None

App rate: None

Sc	Twp	Rge	Government lot	N E				N W				S W				S E				Harv tax	Reg use
				n e	n w	s e	s w	n e	n w	s e	s w	n e	n w	s e	s w	n e	n w	s e	s w		
01	16S	03E		X	X	X	X	X	X	X	X	X	X	X	X	X	X	X		EL1	
01	16S	03E		X	X	X	X	X	X	X	X	X	X	X	X	X	X	X		EL1	
02	16S	03E		X	X	X	X	X	X	X	X	X	X	X	X	X	X	X		EL1	
02	16S	03E		X	X	X	X	X	X	X	X	X	X	X	X	X	X	X		EL1	
03	16S	03E		X	X	X	X	X		X	X	X	X	X	X	X	X	X		EL1	
03	16S	03E		X	X	X	X	X		X	X	X	X	X	X	X	X	X		EL1	
09	16S	03E		X	X	X	X			X	X	X	X	X	X	X	X	X		EL1	
09	16S	03E		X	X	X	X			X	X	X	X	X	X	X	X	X		EL1	
10	16S	03E		X	X	X	X	X	X	X	X	X	X	X	X	X	X	X		EL1	
10	16S	03E		X	X	X	X	X	X	X	X	X	X	X	X	X	X	X		EL1	
11	16S	03E		X	X	X	X	X	X	X	X	X	X							EL1	
11	16S	03E		X	X	X	X	X	X	X	X	X	X							EL1	
14	16S	03E						X												EL1	
14	16S	03E						X												EL1	
15	16S	03E		X	X	X	X	X	X	X	X									EL1	
15	16S	03E		X	X	X	X	X	X	X	X									EL1	
34	15S	03E															X	X		EL1	
34	15S	03E															X	X		EL1	
35	15S	03E								X	X	X	X							EL1	
35	15S	03E								X	X	X	X							EL1	

Water Concern Information

Description	Classification	Rule
South Fork Gate Creek	F str-lg-med N str-sm WP may be required	
South Fork Gate Creek	F str-lg-med N str-sm WP may be required	
South Fork Gate Creek Trib	F str-med-sm WP may be required	
South Fork Gate Creek Trib	F str-med-sm WP may be required	

**Written Plan For Right-of-Way Chemical Application**

Landowner: Giustina Resources LTD. Partnership  
P.O. Bx 529  
Eugene, OR 97440  
541-485-1500

*Rec 8/16/06  
wPends 8/29/06*

Operator: Strata Industries  
100 West Q Street  
Springfield, OR 97477  
541-726-0845

Location:            Section (s)            Township            Range  
                         1,2,10,11,12,15            16S            3E

Situation:            Operations that require notification also require a written plan when the operation is within 100' of a Type F stream.

Giustina Resources is planning to conduct right-of-way herbicide ground applications to control unwanted vegetation.

Plan:                    Leave an unsprayed strip of 10 feet on each side of Type F and any standing open water. Comply with Division 620 of the Oregon Forest Practice Act.

Submitted by:

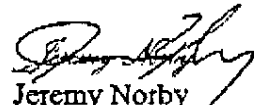
  
Jeremy Norby  
Giustina Resources

Date 8/16/06

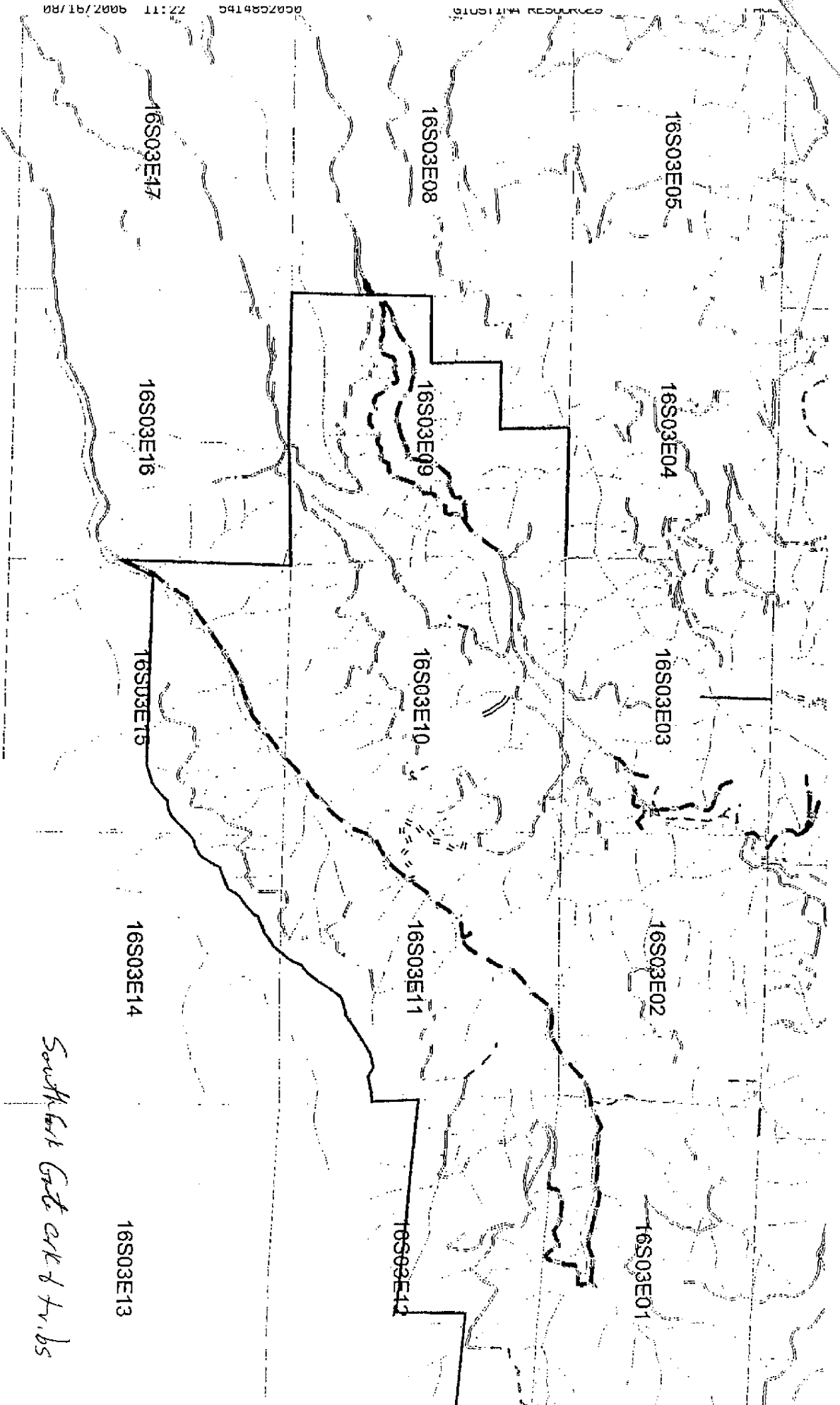

South Fork Gate creek & tribs

2006 ROADSIDE SPRAY

16S03E17

16S03E08

16S03E05

16S03E16

16S03E09

16S03E04

16S03E15

16S03E10

16S03E03

16S03E14

16S03E11

16S03E02

16S03E13

16S03E12

16S03E01

22:11 0002/19/00

00202084195

