

State of Oregon
Department of Forestry / Department of Revenue
Notification number: 2006-781-50986 [78126642]

* REPRINT *
* Edited *

Attached is the processed information from the Notification of Operation and/or Application for Permits.
Please review this information and retain for future reference.

- Notice is given to the State Forester that an operation will be conducted on the lands described herein (ORS 527.670).

I. WHERE TIMBER HARVESTING IS PART OF THE PROPOSED OPERATION:

District: **Western Lane**
Office: **Veneta**

A. NOTICE TO TIMBER OWNER: Party owning the harvested timber at the point it is first measured is shown in the section marked TIMBER OWNER and is responsible for payment of Oregon timber taxes.

County: **Lane**
WOSTOT:

B. NOTICE TO LAND OWNER: Party shown in the section marked LAND OWNER is responsible for reforestation of the site if so required.

Received by ODF on August 11, 2006 at 0951

15 DAY WAITING PERIOD REQUIRED

**** Waiver Requested ****

II. WRITTEN PLANS:

- A WRITTEN PLAN may be required before certain activities can commence on the Operation.

A WRITTEN PLAN may be required for the situations indicated by an below. A WRITTEN PLAN must be submitted or a WRITTEN WAIVER must be obtained from the State Forester before any portion of the operation may commence.

- Within 100 feet of a large lake or Type F or Type D stream. [OAR 629-605-170(1)(a)]

- Within 300 feet of a wildlife resource site listed in the 1984 ODF/ODFW Cooperative Agreement. [OAR 629-605-170(1)(b)]

- Within 300 feet of any resource identified in the Divisions 645 or 665 of the administrative rules. [OAR 629-605-170(1)(c)]

- Within 300 feet of a state or federally listed threatened or endangered wildlife resource site. [OAR 629-605-170(1)(d)]

Please contact the Oregon Department of Forestry forester named on the Unit Information sheet for further information on requirements that may be necessary to meet before any activity/operation begins.

Signed by **Brett Wisely** - representing the Operator.

******* NOTICE *******

The State Forester has determined that the following items requiring your attention are located within or adjacent to your operation area:

- Concerns - Resources - Water

See Unit Information on subsequent pages for details.

Operator:

Skookum Reforestation
P.O. Box 40610
Eugene, OR 97440
Phone: (541) 485-3026

Land owner:

Rosboro Lumber Company, LLC
P. O. Box 20
Springfield, OR 97477
Phone: 746-8411

Timber owner:

None located
Phone: None located

Marvin D. Brown Rick Rogers
State Forester District Forester

(Subscriber)

Unit: 1

Status: Active

Stewardship Forester: Ole Buch

Phone number: (541) 935-2283

Start date: 8/16/2006

End date: 12/31/2006

Site conditions: No Protected Waters within 100 ft
 Slope of 0% to 35%
 No mass soil movement

FP = L

FPA = L

Acres: 130

Feet:

Estimated harvest: MBF

Activity: Herbicide Application

Methods: Ground

Brand name: Triclopyr (Ester); Forest Crop Oil

Carrier: None

Additives: Brush & Basal

App rate: None

Sc	Twp	Rge	Government lot	NE				NW				SW				SE				Harv tax	Reg use
				n	n	s	s	n	n	s	s	n	n	s	s	n	n	s	s		
				e	w	w	e	e	w	w	e	e	w	w	e	e	w	w	e		
25	16S	09W												X							WT1
26	16S	09W																	X		WT1
35	16S	09W		X			X														WT1
36	16S	09W						X	X												WT1

Water Concern Information

Description	Classification	Rule
See Map	Unknown class	

State of Oregon
Department of Forestry / Department of Revenue
Notification number: 2006-781-50986 [78126642]

* REPRINT *
* Edited *

Attached is the processed information from the Notification of Operation and/or Application for Permits.
Please review this information and retain for future reference.

[X] - Notice is given to the State Forester that an operation will be conducted on the lands described herein (ORS 527.670).

I. WHERE TIMBER HARVESTING IS PART OF THE PROPOSED OPERATION:

District: **Western Lane**
Office: **Veneta**

County: **Lane**
WOSTOT:

Received by ODF on August 11, 2006 at 0951

A. NOTICE TO TIMBER OWNER: Party owning the harvested timber at the point it is first measured is shown in the section marked TIMBER OWNER and is responsible for payment of Oregon timber taxes.

B. NOTICE TO LAND OWNER: Party shown in the section marked LAND OWNER is responsible for reforestation of the site if so required.

15 DAY WAITING PERIOD REQUIRED

**** Waiver Requested ****

II. WRITTEN PLANS:

[] - A WRITTEN PLAN may be required before certain activities can commence on the Operation.

A WRITTEN PLAN may be required for the situations indicated by an [X] below. A WRITTEN PLAN must be submitted or a WRITTEN WAIVER must be obtained from the State Forester before any portion of the operation may commence.

[] - Within 100 feet of a large lake or Type F or Type D stream. [OAR 629-605-170(1)(a)]

[] - Within 300 feet of a wildlife resource site listed in the 1984 ODF/ODFW Cooperative Agreement. [OAR 629-605-170(1)(b)]

[] - Within 300 feet of any resource identified in the Divisions 645 or 665 of the administrative rules. [OAR 629-605-170(1)(c)]

[] - Within 300 feet of a state or federally listed threatened or endangered wildlife resource site. [OAR 629-605-170(1)(d)]

Please contact the Oregon Department of Forestry forester named on the Unit Information sheet for further information on requirements that may be necessary to meet before any activity/operation begins.

Signed by **Brett Wisely** - representing the Operator.

******* NOTICE *******

The State Forester has determined that the following items requiring your attention are located within or adjacent to your operation area:

[] - Concerns [] - Resources [X] - Water

See Unit Information on subsequent pages for details.

Operator:

Skookum Reforestation
P.O. Box 40610
Eugene, OR 97440
Phone: (541) 485-3026

Land owner:

Rosboro Lumber Company, LLC
P. O. Box 20
Springfield, OR 97477
Phone: 746-8411

Timber owner:

Phone:

Marvin D. Brown
State Forester

Rick Rogers
District Forester

(Subscriber)

Unit: 1

Status: Active

Stewardship Forester: Ole Buch Phone number: (541) 935-2283
 Start date: 8/16/2006 End date: 12/31/2006

Site conditions: No Protected Waters within 100 ft
 Slope of 0% to 35%
 No mass soil movement

FP = L
 FPA = L

Acres: 130 Feet: Estimated harvest: MBF
 Activity: Herbicide Application
 Methods: Ground
 Brand name: Triclopyr; Forest Crop Oil; Carrier: None
 Additives: Brush & Basal App rate: None

Sc	Twp	Rge	Government lot	N E				N W				S W				S E				Harv tax	Reg use
				n	n	s	s	n	n	s	s	n	n	s	s	n	n	s	s		
25	16S	09W												X							WT1
26	16S	09W																	X		WT1
35	16S	09W		X			X														WT1
36	16S	09W						X	X												WT1

Water Concern Information

Description	Classification	Rule
See Map	Unknown class	

Unit: 2

Status: Active

Stewardship Forester: Ole Buch

Phone number: (541) 935-2283

Start date: 8/16/2006

End date: 12/31/2006

Site conditions: No Protected Waters within 100 ft
 Slope of 0% to 35%
 No mass soil movement

FP = L

FPA = L

Acres: 2880

Feet:

Estimated harvest: MBF

Activity: Herbicide Application

Methods: Ground

Brand name: Triclopyr; Forest Crop Oil;

Carrier: None

Additives: Brush & Basal

App rate: None

Sc	Twp	Rge	Government lot	NE				NW				SW				SE				Harv tax	Reg use
				n	n	s	s	n	n	s	s	n	n	s	s	n	n	s	s		
				e	w	w	e	e	w	w	e	e	w	w	e	e	w	w	e		
06	17S	08W					X	X			X	X	X	X	X	X	X	X	X		WT1
07	17S	08W		X	X	X	X	X	X	X	X	X	X	X	X	X	X	X	X		WT1
08	17S	08W		X	X	X	X	X	X	X	X										WT1
18	17S	08W							X												WT1
01	17S	09W														X		X	X		WT1
11	17S	09W					X		X	X		X	X		X	X	X	X	X		WT1
13	17S	09W		X	X																WT1
14	17S	09W		X	X			X	X												WT1
12	17S	09W		X	X	X	X	X	X	X	X	X	X	X	X	X	X	X	X		WT1

Water Concern Information

Description	Classification	Rule
See Map	Unknown class	

Unit: 3

Status: Active

Stewardship Forester: Ole Buch

Phone number: (541) 935-2283

Start date: 8/16/2006

End date: 12/31/2006

Site conditions: No Protected Waters within 100 ft
 Slope of 0% to 35%
 No mass soil movement

FP = L

FPA = L

Acres: 240

Feet:

Estimated harvest: MBF

Activity: Herbicide Application

Methods: Ground

Brand name: Triclopyr; Forest Crop Oil;

Carrier: None

Additives: Brush & Basal

App rate: None

Sc	Twp	Rge	Government lot	N E				N W				S W				S E				Harv tax	Reg use
				n	n	s	s	n	n	s	s	n	n	s	s	n	n	s	s		
13	17S	09W		e	w	w	e	e	w	w	e	e	w	w	e	e	w	w	e		WT1

Water Concern Information

Description

Classification

Rule

See Map

Unknown class

RMIT

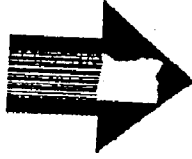

DEPARTMENT OF REVENUE

OREGON DEPARTMENT OF REVENUE

LAND AND TIMBER OWNER

FOR THE PURPOSES GOVERNING FIRE PROTECTION AND FOREST PRACTICES ON PRIVATE LAND.

AS DESCRIBED ON REVERSE (ORS 527.670).

TO HARVEST TIMBER (ORS 321.550).

Area Code & Phone No.

(541) 688-1900

Area Code & Phone No.

(541) 688-1900

RC:

LC

EG:

S:

Area Code & Phone No.

(541) 746-8411

If timber harvested certified under the Western Forestry Act, please check "Part" or "All" please box to the right.

WOSTOT Certificate #

Area Code & Phone No.

Social Security Number

78126642

Notification Number: 06-50986

OP	TD	LD
----	----	----

Geographic Area:

Date Received:

8/11/06

Time: 0957

Initials: JBR

District:

Office:

Correction:

Please describe the intent of the operation, and any other information that may be relevant to the Forest Practices Forester.

APPLICANT REMARKS:

THERE WILL BE NO APPLICATION WITHIN 100' OF TYPE D OR F WATER SOURCES.

PURPOSE: TO ELIMINATE NOXIOUS VEGETATION (SCOTCH BROOM) FROM FOREST PLANTATION.

TO ELIMINATE HARDWOOD VEGETATION FROM COMPETING WITH CONIFER REGENERATION.

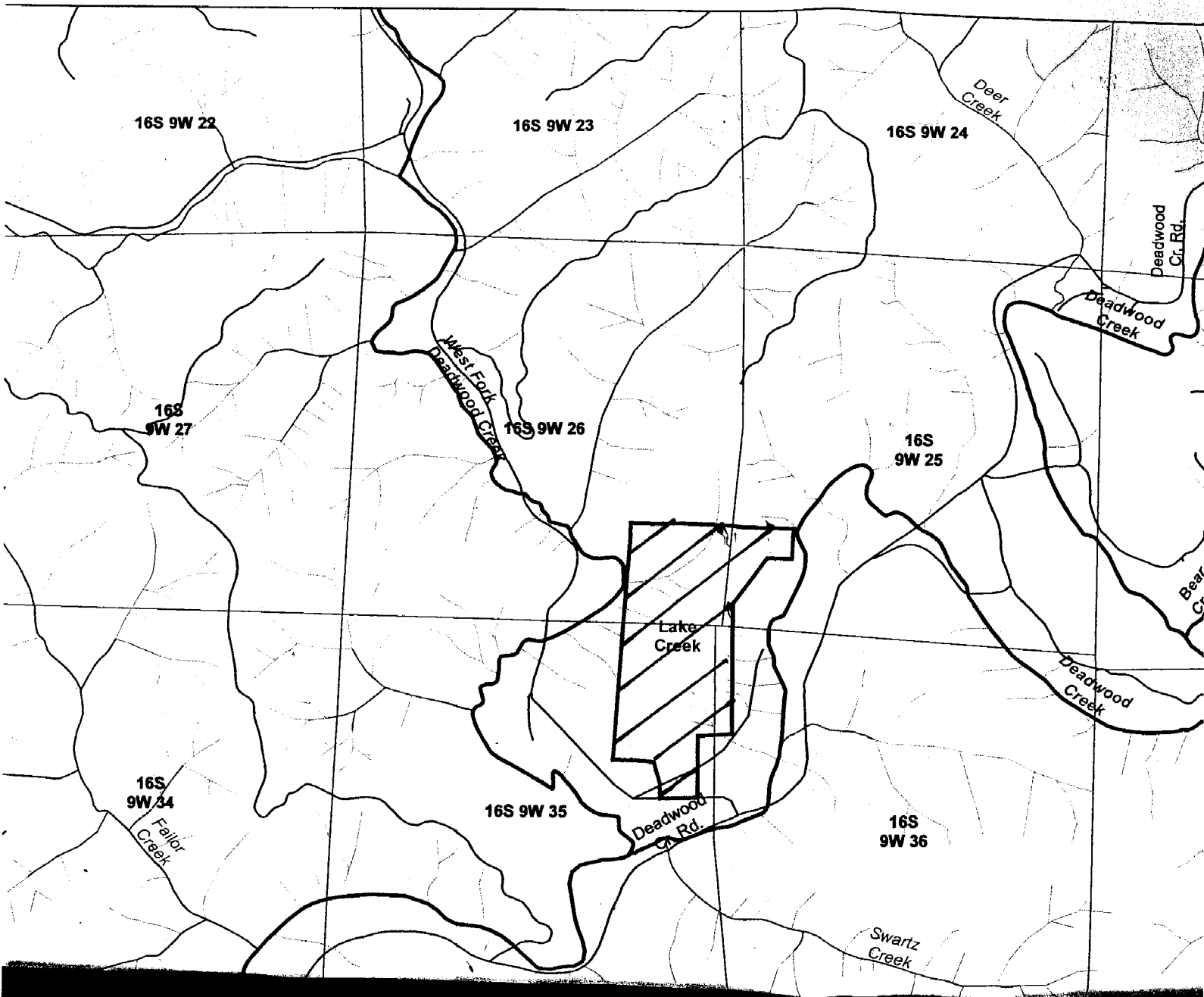

 - UNIT 1

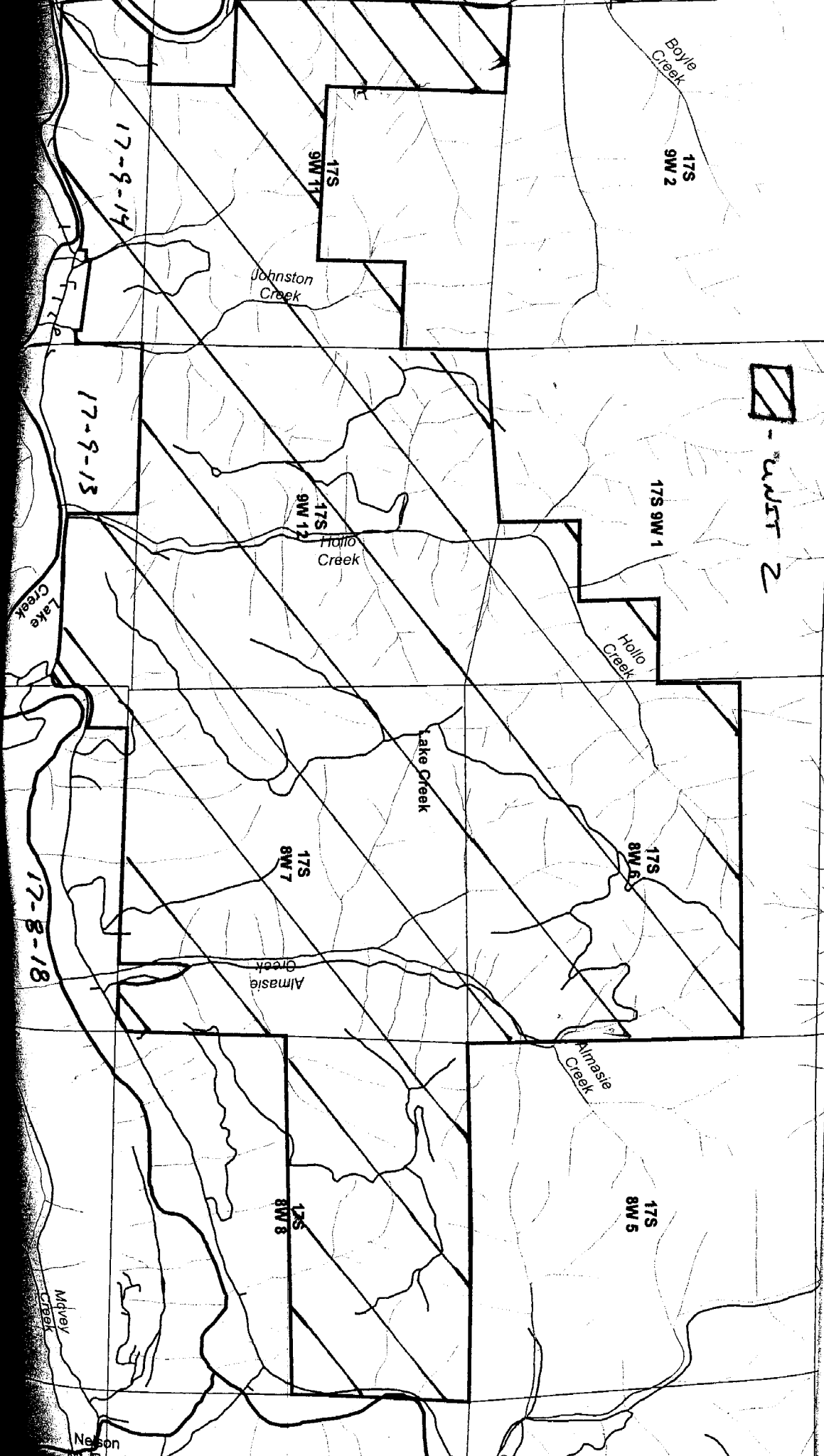

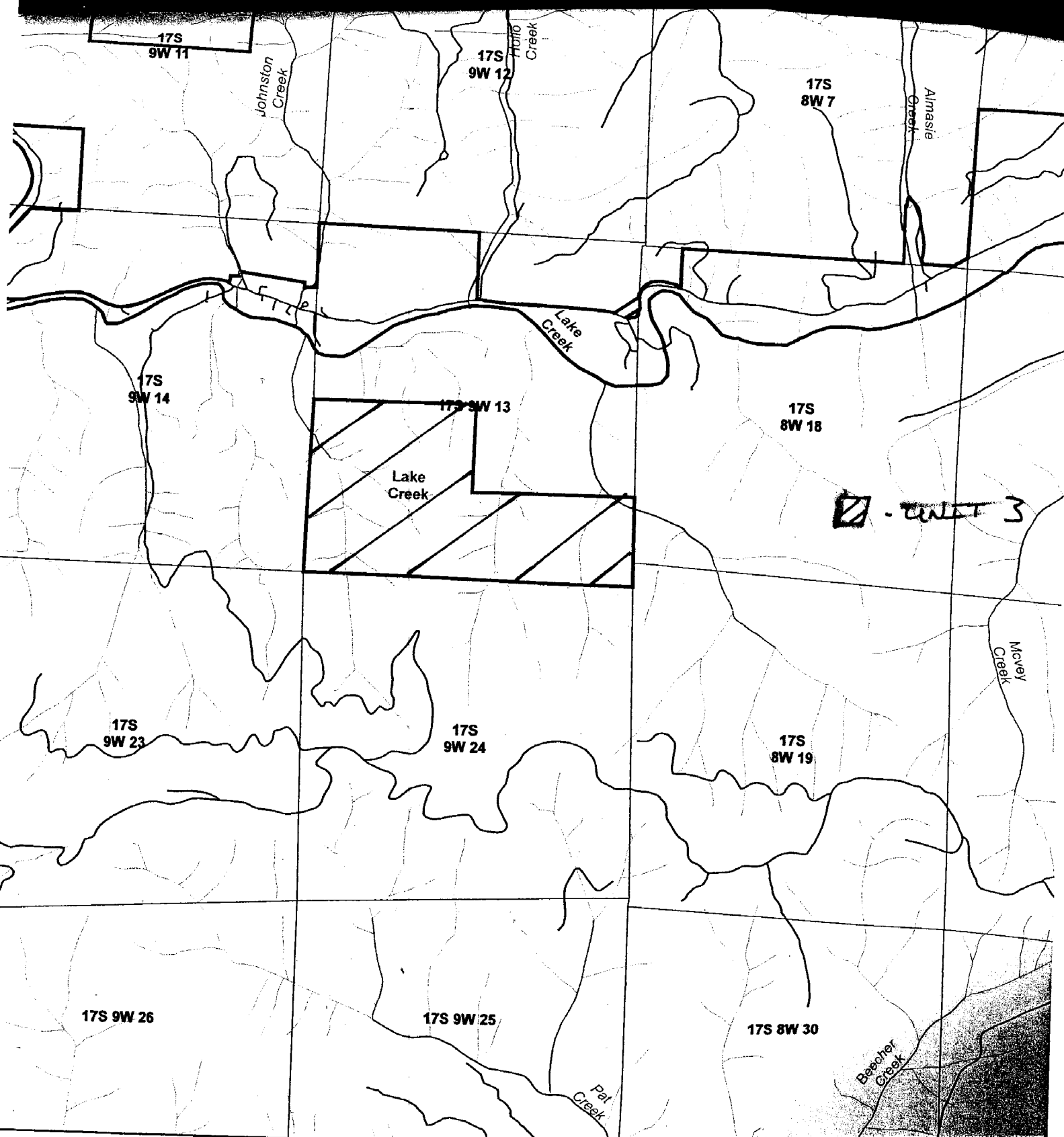

Utilities
 ■ PIPELINES
 ● POWERLINES

Scale 1:24,000

