

State of Oregon  
Department of Forestry / Department of Revenue  
Notification number: 2007-552-30208 [55214948] Aerial App Of Herbicide

Attached is the processed information from the Notification of Operation and/or Application for Permits.  
Please review this information and retain for future reference.

- ☒ - Notice is given to the State Forester that an operation will be conducted on the lands described herein (ORS 527.670).
- ☒ - A permit to operate power driven machinery is issued for the lands described herein (ORS 477.625)
- ☒ - A notice is given to the State Forester and the Department of Revenue of the intent to harvest timber (ORS 321.550).

I. WHERE TIMBER HARVESTING IS PART OF THE PROPOSED OPERATION:

A. NOTICE TO TIMBER OWNER: Party owning the harvested timber at the point it is first measured is shown in the section marked TIMBER OWNER and is responsible for payment of Oregon timber taxes.

B. NOTICE TO LAND OWNER: Party shown in the section marked LAND OWNER is responsible for reforestation of the site if so required.

District: **West Oregon**

Office: **Dallas**

County: **Polk**

WOSTOT:

Received by ODF on March 5, 2007 by mail

**\*15 DAY WAITING PERIOD REQUIRED\***

II. WRITTEN PLANS:

- ☐ - A WRITTEN PLAN may be required before certain activities can commence on the Operation.

A WRITTEN PLAN may be required for the situations indicated by an ☒ below. A WRITTEN PLAN must be submitted or a WRITTEN WAIVER must be obtained from the State Forester before any portion of the operation may commence.

- ☒ - Within 100 feet of a large lake or Type F or Type D stream. [OAR 629-605-170(1)(a)]
- ☐ - Within 300 feet of a wildlife resource site listed in the 1984 ODF/ODFW Cooperative Agreement. [OAR 629-605-170(1)(b)]
- ☐ - Within 300 feet of any resource identified in the Divisions 645 or 665 of the administrative rules. [OAR 629-605-170(1)(c)]
- ☐ - Within 300 feet of a state or federally listed threatened or endangered wildlife resource site. [OAR 629-605-170(1)(d)]

Please contact the Oregon Department of Forestry forester named on the Unit Information sheet for further information on requirements that may be necessary to meet before any activity/operation begins.

Signed by Ron Smith - representing the Land owner.

**\*\*\*\*\* NOTICE \*\*\*\*\***

The State Forester has determined that the following items requiring your attention are located within or adjacent to your operation area:

- ☐ - Concerns ☐ - Resources ☒ - Water

See Unit Information on subsequent pages for details.

Operator:

Farm And Forest Helicopter Service  
P O Box 404  
Napavine, WA 98565

Phone: ( 541 ) 262-3197

Land owner:

Meriwether Northwest Oregon Land  
450 Pacific Ave. North  
Monmouth, OR 97361

Phone: ( 503 ) 838-1610

Timber owner:

Laminora Properties, Inc.  
450 Pacific Ave. North  
Monmouth, OR 97361

Phone: ( 503 ) 838-1610

Marvin D. Brown  
State Forester

Steve Laam  
District Forester

(Subscriber)

## Unit: 1

Status: Active

Stewardship Forester: David Thompson

Phone number: (503) 623-8146

Start date: 3/18/2007 End date: 12/31/2007

Site conditions: Lake or Stream within 100 ft  
 Slope of 35% to 65%  
 Old slides, small failures

FP = H

FPA = H

Acres: 1045

Feet:

Estimated harvest: MBF

Activity: Herbicide Application

Methods: Aerial

Brand name: Sulfometuron/Hexazinone/Atrazine

Carrier: 2,4D/Sulfometuron/Hexazinone

Additives: None

App rate: None

Sc	TwP	Rge	Government lot	n e	n w	E s	E e	n e	n w	N s	N e	n e	n w	S s	S e	n e	n w	S s	S e	Harv tax	Reg use
04	08S	06W												X	X						WO1
05	08S	06W																			WO1
30	07S	06W																	X	X	WO1
31	07S	06W		X	X														X	X	WO1
22	07S	06W												X					X		WO1
27	07S	06W																	X		WO1
35	07S	07W																	X		WO1
02	08S	07W		X	X									X	X						WO1
03	08S	07W												X	X	X	X				WO1
04	08S	07W												X	X	X	X				WO1
10	08S	07W																	X		WO1
34	07S	07W																			WO1
03	08S	06W												X				X	X	X	WO1
04	08S	06W																	X	X	WO1
28	07S	06W																X	X	X	WO1
23	07S	06W												X	X	X	X		X		WO1
24	07S	06W												X	X	X	X		X	X	WO1
26	07S	06W																			WO1
27	07S	06W																			WO1
34	07S	06W		X																	WO1
35	07S	06W																			WO1
34	07S	07W		X	X	X	X														WO1
35	07S	07W																	X		WO1

## Water Concern Information

Description

Classification

Rule

Various Streams

F str-lg-med-sm-dom use Dom use str-lg-med-sm Mand written plan

170a

**Unit: 2**Status: **Active**Stewardship Forester: **Jason Hayzlett**Phone number: **(503) 623-8146**Start date: **3/18/2007**End date: **12/31/2007**Site conditions: **Lake or Stream within 100 ft**

FP = H

**Slope of 35% to 65%****Old slides, small failures**

FPA = H

Acres: **120**

Feet:

Estimated harvest: MBF

Activity: **Herbicide Application**Methods: **Aerial**Brand name: **Sulfometuron/Hexazinone/Atrazine**Carrier: **2,4D/Sulfometuron/Hexazinone**Additives: **None**App rate: **None**

Sc	Twp	Rge	Government lot	N E				N W				S W				S E				Harv tax	Reg use
				n e	n w	s w	s e	n e	n w	s w	s e	n e	n w	s w	s e	n e	n w	s w	s e		
19	07S	06W				X				X	X	X	X				X				
19	07S	06W										X	X	X	X		X	X			WO1 WO1

**Water Concern Information**

Description

Classification

Rule

Various Streams

F str-lg-med-sm-dom use Dom use str-lg-med-sm Mand written plan

170a

March 2, 2007

## Written Plan for Aerial application of Chemicals

*Unit Names:* See Maps

*Legal Descriptions:* See Maps

*Streams:* Tributaries to Mill Creek  
S. Branch Creek and Tributaries  
Ellendale Creek and Tributaries  
Applegate Creek and Tributaries  
Rickreall Creek and Tributaries  
Rockhouse Creek and Tributaries  
Laurel Creek and Tributaries  
Kyle Creek and Tributaries  
Canyon Creek and Tributaries

### Protection Measures:

1. All units will be reconned by air or by aerial photo before application to point out protected resources, unsprayed areas, etc. with contractor.
2. Half boom applications will be used when reasonable and practical.
3. A 60-foot buffer will be maintained on any "D" or "F" streams. Applications will be made only to harvest areas; No direct applications will be made on buffers of vegetation required to be left.
4. Weather conditions will be monitored to avoid risk of application to undesired areas.
5. Unit Name, Legal Description, and acres are listed on attached maps. Protected resources are listed above.
6. Possible Chemicals Used will be: **Chopper** ( Imazapyr 27.6% ) 24 to 48 ounces per acre. EPA # 241-296. **Glyphosate** 1 to 3 quarts per acre. **Tahoe 4E** (Triclopyr 61.6%) EPA # 228-385 1 to 1 ½ quarts per acre. **Oust Extra** ( Sulfometuron methyl 56.25%, Metsulfuron methyl 15% ) EPA# 352-622 4 to 5 ounces per acre. **LV 6 - 2,4D** 16 to 64 ounces per acre. **Transline** ( Clopyralid 40.9% ) EPA # 62719-259 6 to 12 ounces per acre. **Oust** ( Sulfometuron methyl 75% ) EPA# 352-601 3 ounces per acre. **Escort** ( Metsulfuron methyl 60% ) EPA # 352-439 1 ounce per acre. **ATRAZINE 90 WSP** EPA # 19713-76-5905 1 to 4.4 pounds per acre. **VELPAR DF** (HEXAZINONE) EPA # 352-581 1 to 4 pounds per acre. (Generic alternatives may be substituted)



Ron Smith  
Area Forester



RECEIVED 3-2-07 by FAX



# PROJECT ORDER MAP

Henrys

123°28'30"W

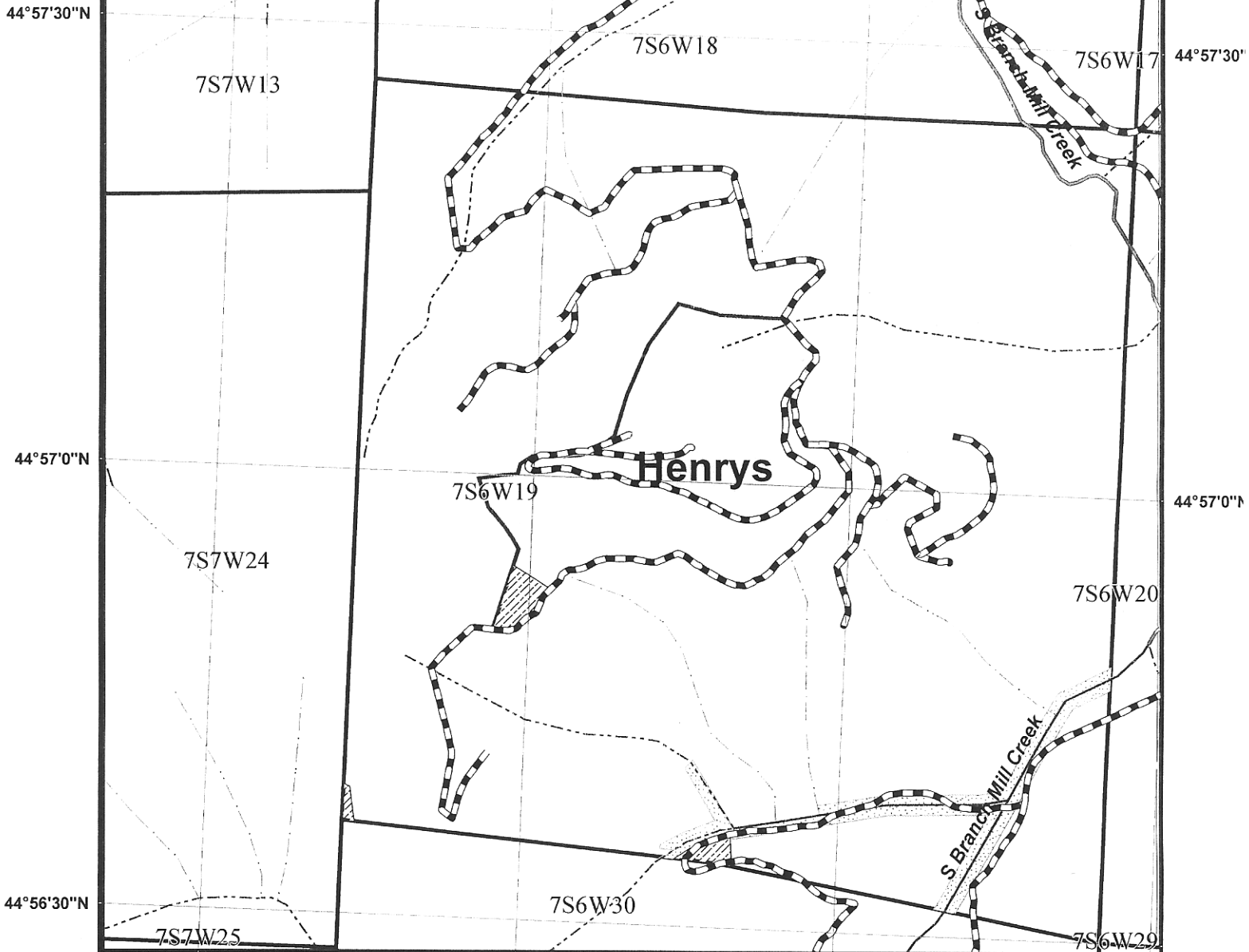
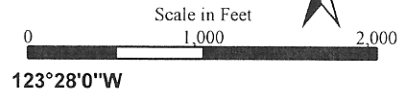

- Road Activities**
- Existing- No Activity
  - New Construction
  - Re-Construction
  - End Haul
  - Rocking Only

- Road Features**
- Culvert
  - Landing
  - Waste Area



Unit Area



Forest Capital

**Streams**

- Large
- Medium
- Small
- Ephemeral
- Contour Line
- Section Line

Leave Areas



Bio Diversity



Leave Tree Requirement (LTR)



Stream Buffer and LTR



Scenic Buffer



Special Site



Stream Buffer

123°28'0"W

Unit ID

5142

Gross Acres:

67

123°27'30"W

Wildlife Tree

Created by: RGS

Mar 02, 2007



# PROJECT ORDER MAP

## BLITZ

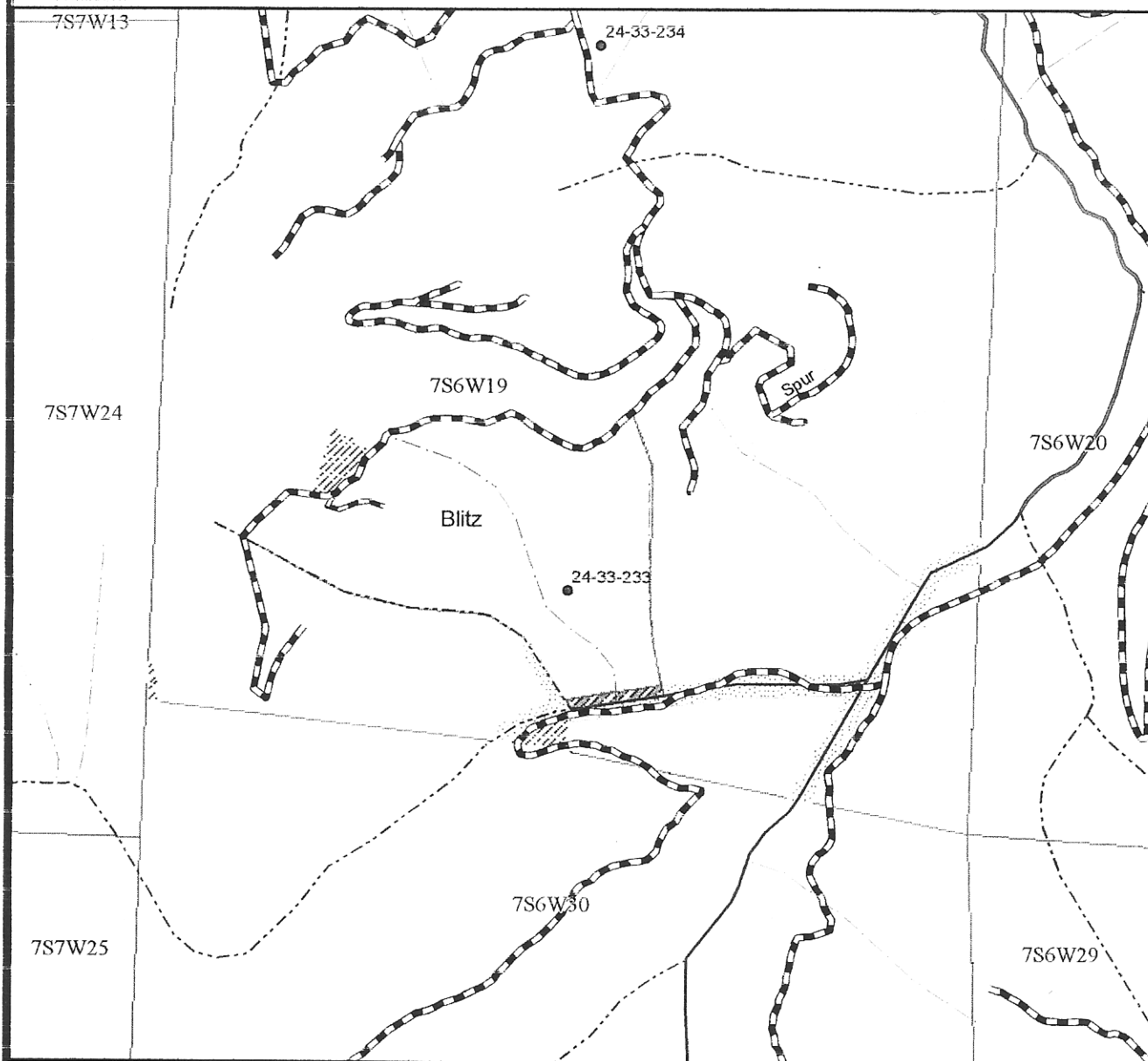
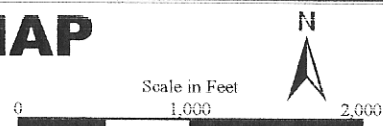

### Road Activities

- Existing- No Activity
- New Construction
- Re-Construction
- End Haul
- Rocking Only

### Road Features

- Culvert
- Landing
- Waste Area



### Unit Area

- Forest Capital

### Streams

- Large
- Medium
- Small
- Ephemeral
- Contour Line
- Section Line

### Leave Areas

- Bio Diversity
- Leave Tree Requirement (LTR)
- Stream Buffer and LTR
- Scenic Buffer
- Special Site
- Stream Buffer

**Unit ID** 5140

**Gross Acres:** 65

• Wildlife Tree

Created by: RGS

12-22-05

Forest Capital, LLC does not warrant the accuracy or completeness of this product. The reader is responsible for correct use and interpretation.



FOREST  
CAPITAL PARTNERS, LLC

# PROJECT ORDER MAP

1930 switcharoo

123°26'30"W

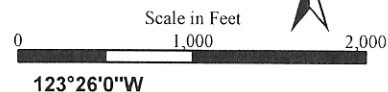

123°26'0"W

44°54'30"N

44°54'30"N

44°54'0"N

44°54'0"N

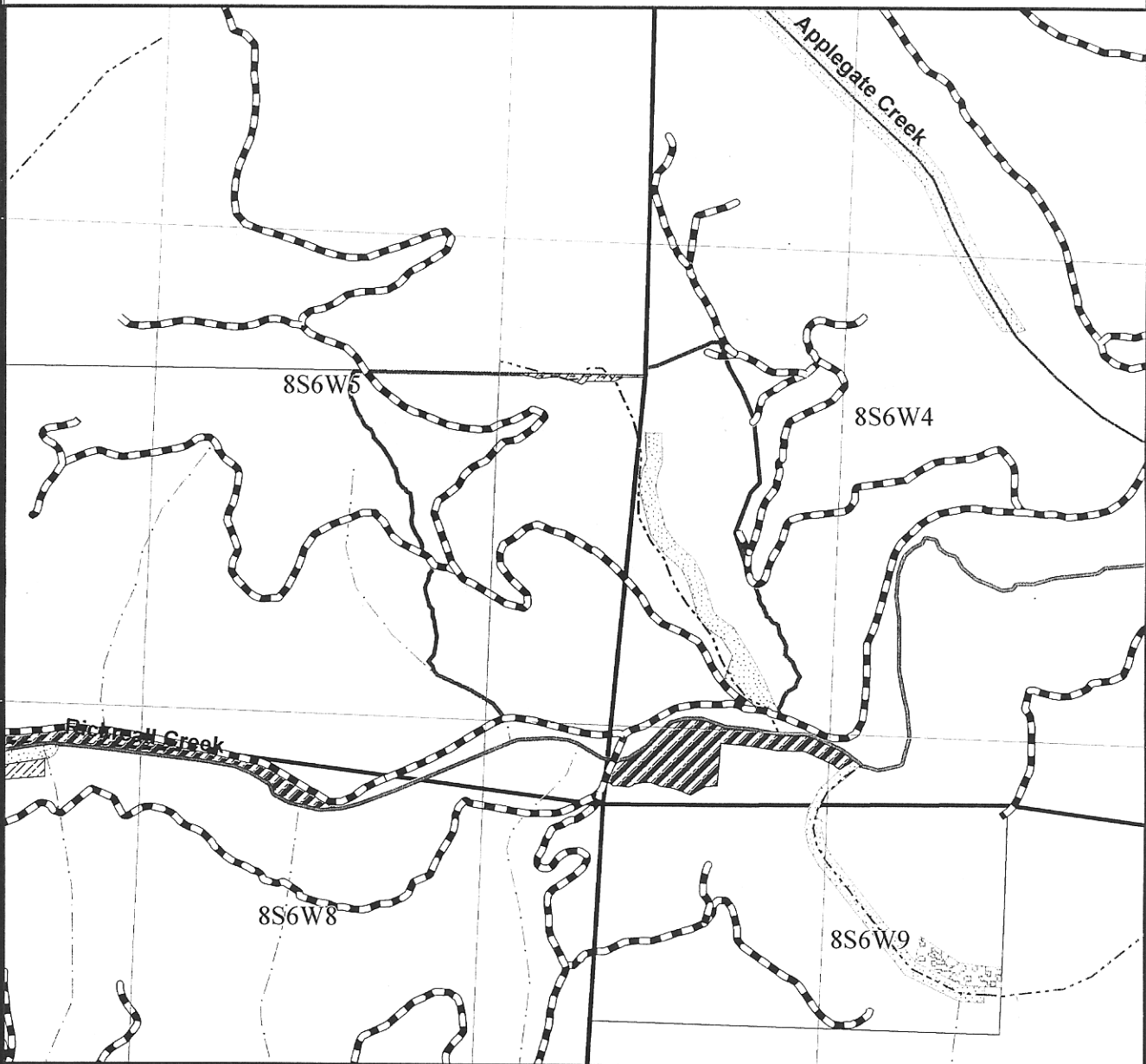

123°27'0"W

- Road Activities**
- Existing- No Activity
  - New Construction
  - Re-Construction
  - End Haul
  - Rocking Only

**Road Features**

- Culvert
- Landing
- Waste Area



Unit Area 123°26'30"W

Forest Capital

**Streams**

- Large
- Medium
- Small
- Ephemeral
- Contour Line
- Section Line

**Leave Areas**

- Bio Diversity
- Leave Tree Requirement (LTR)
- Stream Buffer and LTR
- Scenic Buffer
- Special Site
- Stream Buffer

123°26'0"W

Unit ID 5530

Gross Acres: 110

• Wildlife Tree

Created by: RGS

Mar 02, 2007

Forest Capital, LLC does not warrant the accuracy or completeness of this product. The reader is responsible for correct use and interpretation.



FOREST  
CAPITAL 'W'  
PARTNERS, LLC

# PROJECT ORDER MAP

## Bhang Point

123°28'0"W

123°27'30"W

123°27'0"W

Scale in Feet

1,000

2,000



44°56'0"N

44°56'0"N

44°55'30"N

44°55'30"N

S Branch Mill Creek

7S6W30

7S6W29

7S6W31

7S6W32

Aggregate Creek

123°28'30"W

Road Activities

- Existing- No Activity
- New Construction
- Re-Construction
- End Haul
- Rocking Only

Road Features

- Culvert
- Landing
- Waste Area



123°28'0"W

Forest Capital

Streams

- Large
- Medium
- Small
- Ephemeral
- Contour Line
- Section Line

Leave Areas

- Bio Diversity
- Leave Tree Requirement (LTR)
- Stream Buffer and LTR
- Scenic Buffer
- Special Site
- Stream Buffer

123°27'30"W

Unit ID

5445

Gross Acres:

62

123°27'0"W

• Wildlife Tree

Created by: RGS

Mar 02, 2007

Forest Capital, LLC does not warrant the accuracy or completeness of this product. The reader is responsible for correct use and interpretation.





# PROJECT ORDER MAP

## Biker Bar



Scale in Feet

0 1,000 2,000

123°25'0"W

123°24'30"W

123°24'0"W

44°57'0"N

44°57'0"N

44°56'30"N

44°56'30"

44°56'0"N

44°56'0"N

### Road Activities

- Existing- No Activity
- New Construction
- Re-Construction
- End Haul
- Rocking Only

### Road Features

- Culvert
- Landing
- Waste Area

123°25'0"W



Unit Area

Forest Capital

### Streams

- Large
- Medium
- Small
- Ephemeral
- Contour Line
- Section Line

123°24'30"W

### Leave Areas

- Bio Diversity
- Leave Tree Requirement (LTR)
- Stream Buffer and LTR
- Scenic Buffer
- Special Site
- Stream Buffer

Unit ID

123°24'0"W

5575

Gross Acres:

92

Wildlife Tree

Created by: RGS

Mar 02, 2007

Forest Capital, LLC does not warrant the accuracy or completeness of this product. The reader is responsible for correct use and interpretation.



# PROJECT ORDER MAP

Honker

Scale in Feet

0 1,000 2,000



123°31'0"W

123°30'30"W

123°30'0"W

44°55'0"N

7S7W34

7S7W35

7S7W36

44°55'0"N

44°54'30"N

8S7W3

8S7W2

8S7W1

44°54'30"N

Rickreall Creek

Rockhouse Creek

Road Activities 123°31'0"W

- Existing- No Activity
- New Construction
- Re-Construction
- End Haul
- Rocking Only

Road Features

- Culvert
- Landing
- Waste Area



Unit Area 123°30'30"W

Forest Capital

Streams

- Large
- Medium
- Small
- Ephemeral
- Contour Line
- Section Line

Leave Areas

- Bio Diversity
- Leave Tree Requirement (LTR)
- Stream Buffer and LTR
- Scenic Buffer
- Special Site
- Stream Buffer

123°30'0"W

Unit ID

5517

Gross Acres:

106

• Wildlife Tree

Created by: RGS

Mar 02, 2007

Forest Capital, LLC does not warrant the accuracy or completeness of this product. The reader is responsible for correct use and interpretation.



# PROJECT ORDER MAP

## Kyle Creek

Scale in Feet

0 1,000 2,000



123°32'30"W

123°32'0"W

123°31'30"W

44°54'30"N

44°54'30"

8S7W4

8S7W3

44°54'0"N

44°54'0"N

Rickreall Creek

8S7W9

8S7W10

### Road Activities

- Existing- No Activity
- New Construction
- Re-Construction
- End Haul
- Rocking Only

### Road Features

- Culvert
- Landing
- Waste Area

123°32'30"W



### Unit Area

- Forest Capital

### Streams

- Large
- Medium
- Small
- Ephemeral
- Contour Line
- Section Line

### Leave Areas

- Bio Diversity
- Leave Tree Requirement (LTR)
- Stream Buffer and LTR
- Scenic Buffer
- Special Site
- Stream Buffer

### Unit ID

Gross Acres:

123°31'30"W

5507

107

- Wildlife Tree

Created by: RGS

Mar 02, 2007

Forest Capital, LLC does not warrant the accuracy or completeness of this product. The reader is responsible for correct use and interpretation.



# PROJECT ORDER MAP

## Laurel Creek

123°32'0"W

123°31'30"W

Scale in Feet

0 1,000 2,000



123°31'0"W

7S7W33

7S7W34

7S7W35

44°55'0"N

44°55'0"N

Laurel Creek

44°54'30"N

44°54'30"N

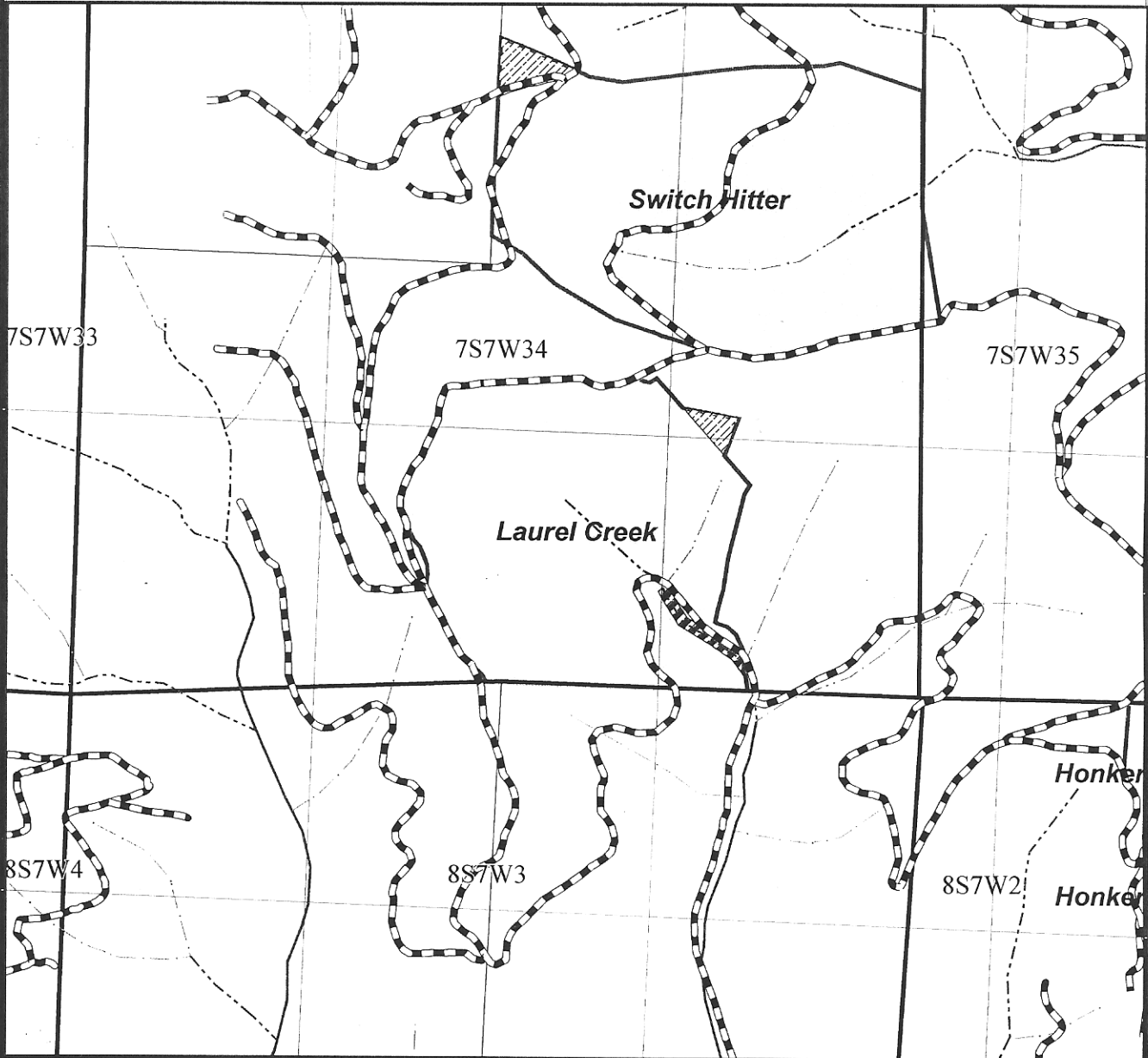

### Road Activities

- Existing- No Activity
- New Construction
- Re-Construction
- End Haul
- Rocking Only

### Road Features

- Culvert
- Landing
- Waste Area



123° Unit Area

Forest Capital

### Streams

- Large
- Medium
- Small
- Ephemeral
- Contour Line
- Section Line

### Leave Areas 123°31'30"W

- Bio Diversity
- Leave Tree Requirement (LTR)
- Stream Buffer and LTR
- Scenic Buffer
- Special Site
- Stream Buffer

Unit ID

Gross Acres:

123°31'0"W

5514

82

• Wildlife Tree

Created by: RGS

Mar 02, 2007

Forest Capital, LLC does not warrant the accuracy or completeness of this product. The reader is responsible for correct use and interpretation.



12 CAPITAL  
PARTNERS, LLC

# PROJECT ORDER MAP

## Little Richard

123°25'30"W

123°25'0"W

123°24'30"W

Scale in Feet  
1,000 2,000



44°54'30"N

44°54'30'

44°54'0"N

44°54'0"N

Applegate Creek

Canyon Creek

Richard Creek

Little Richard

8S6W4

8S6W3

8S6W34

1930 switcharoo

8S6W9

8S6W10

123°26'0"W

123°25'30"W

123°25'0"W

123°24'30"W

### Road Activities

- Existing- No Activity
- New Construction
- Re-Construction
- End Haul
- Rocking Only

### Road Features

- Culvert
- Landing
- Waste Area



Forest Capital

### Streams

- Large
- Medium
- Small
- Ephemeral
- Contour Line
- Section Line

### Leave Areas

- Bio Diversity
- Leave Tree Requirement (LTR)
- Stream Buffer and LTR
- Scenic Buffer
- Special Site
- Stream Buffer

Unit ID

5533

Gross Acres:

75

Wildlife Tree

Created by: RGS

Mar 02, 2007

Forest Capital, LLC does not warrant the accuracy or completeness of this product. The reader is responsible for correct use and interpretation.



# PROJECT ORDER MAP

## Question Mark

Scale in Feet  
0 1,000 2,000



123°26'0"W

123°26'0"W

123°25'30"W

123°25'0"W

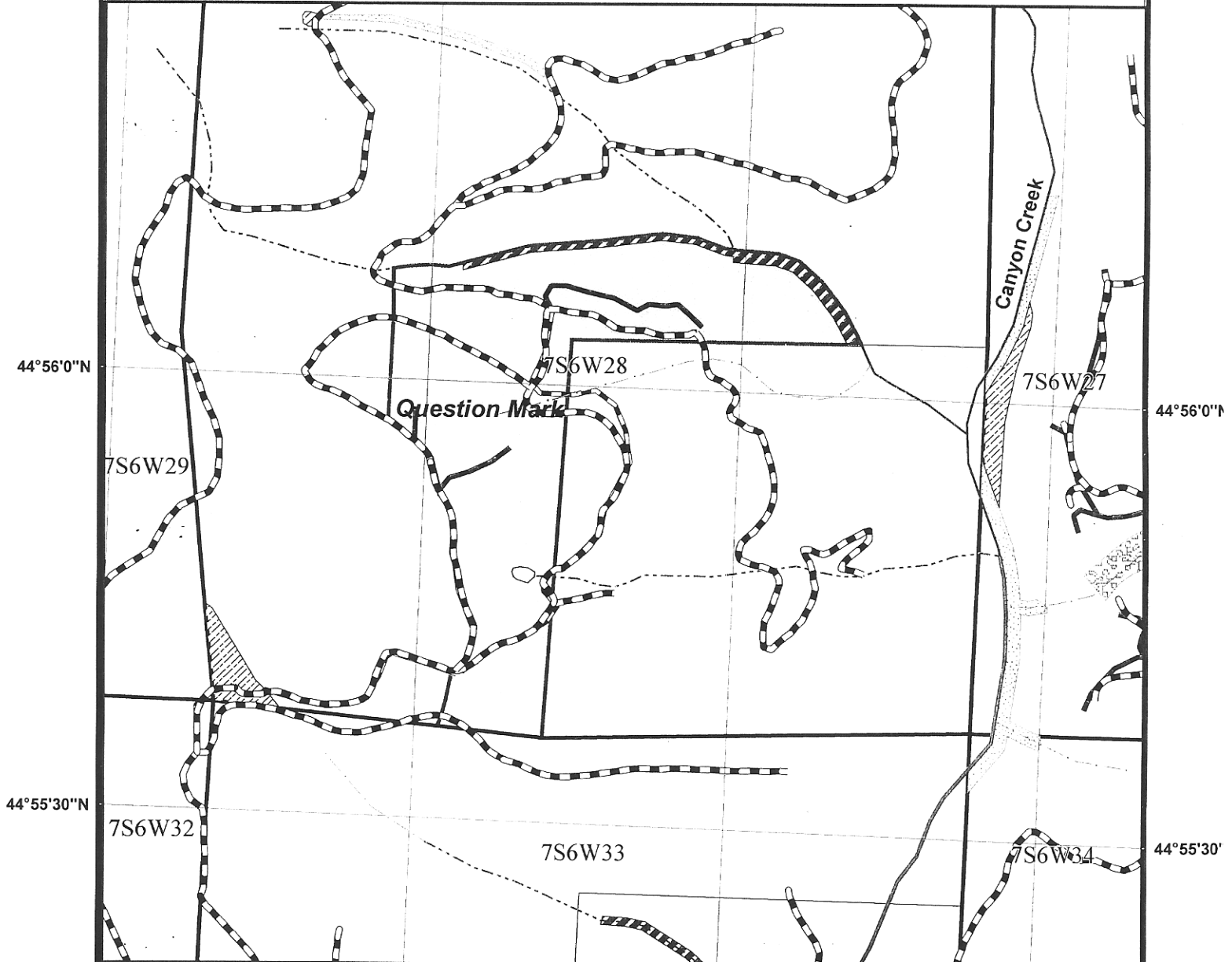

### Road Activities

- Existing- No Activity
- New Construction
- Re-Construction
- End Haul
- Rocking Only

### Road Features

- Culvert
- Landing
- Waste Area



### Q/M Area

- Forest Capital
- Streams
  - Large
  - Medium
  - Small
  - Ephemeral
  - Contour Line
  - Section Line

### Leave Areas

- Bio Diversity
- Leave Tree Requirement (LTR)
- Stream Buffer and LTR
- Scenic Buffer
- Special Site
- Stream Buffer

123°25'30"W

Unit ID

123°25'0"W

5547

Gross Acres:

96

- Wildlife Tree

Created by: RGS

Mar 02, 2007

Forest Capital, LLC does not warrant the accuracy or completeness of this product. The reader is responsible for correct use and interpretation.



# PROJECT ORDER MAP

## Regime Change

123°23'30"W

123°23'0"W

Scale in Feet

1,000

2,000



123°22'30"W

44°57'0"N

44°57'0"N

44°56'30"N

44°56'30"N

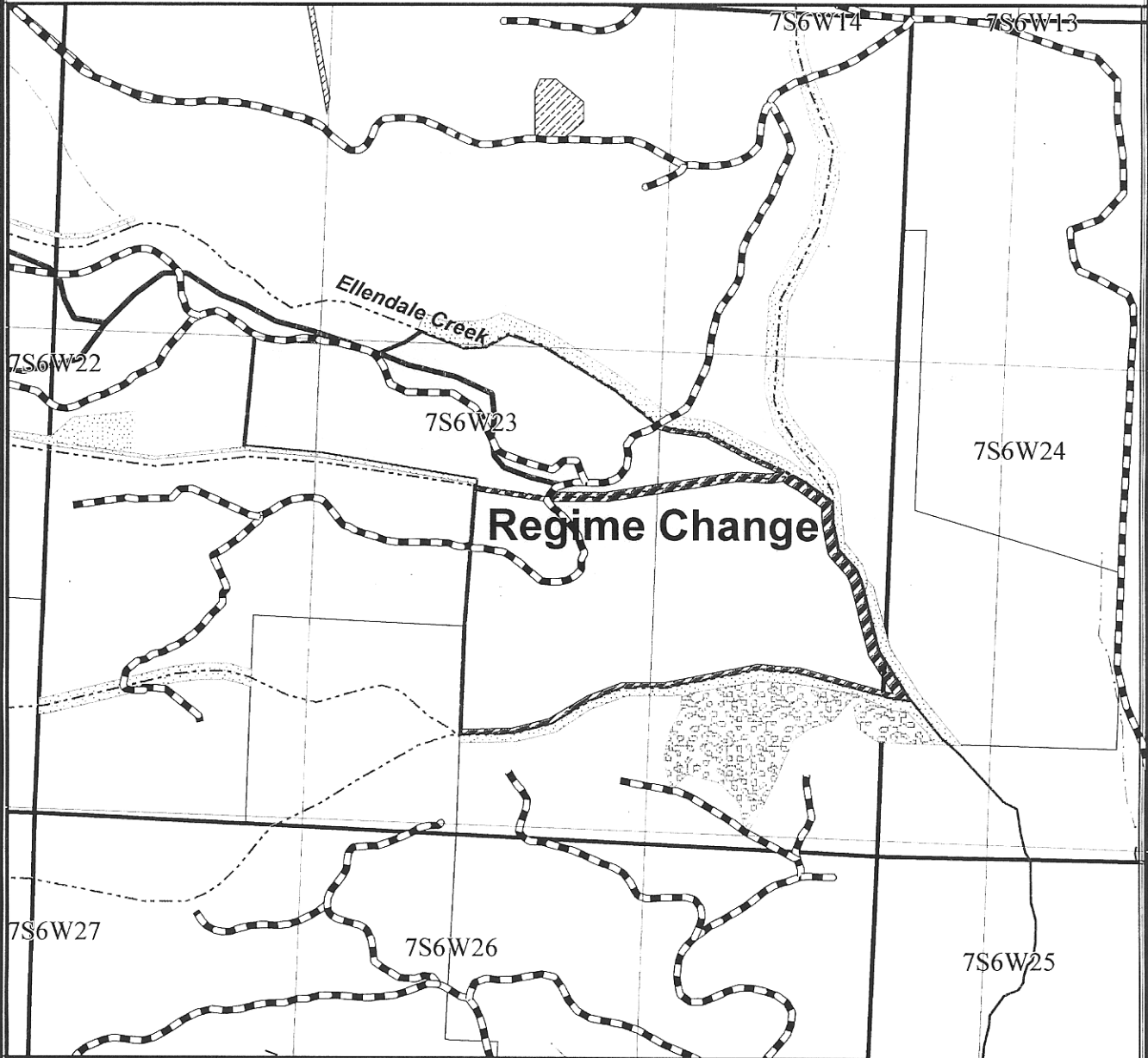

### Road Activities

- Existing- No Activity
- New Construction
- Re-Construction
- End Haul
- Rocking Only

### Road Features

- Culvert
- Landing
- Waste Area

123°23'30"W



Unit Area

Forest Capital

### Streams

- Large
- Medium
- Small
- Ephemeral
- Contour Line
- Section Line

### Leave Areas

- Bio Diversity
- Leave Tree Requirement (LTR)
- Stream Buffer and LTR
- Scenic Buffer
- Special Site
- Stream Buffer

123°23'0"W

### Unit ID

Gross Acres:

Net Acres:

123°22'30"W

6054

125

114

Wildlife Tree

Created by: RGS

Mar 02, 2007

Forest Capital, LLC does not warrant the accuracy or completeness of this product. The reader is responsible for correct use and interpretation.



# PROJECT ORDER MAP

Rock Candy

Scale in Feet

0 1,000 2,000



123°24'0"W

123°23'30"W

123°23'0"W

44°56'0"N

44°56'0"N

7S6W27

7S6W26

44°55'30"N

44°55'30"

Rock Candy

7S6W34

7S6W35

## Road Activities

- Existing- No Activity
- New Construction
- Re-Construction
- End Haul
- Rocking Only

## Road Features

- Culvert
- Landing
- Waste Area

123°24'0"



Unit Area

Forest Capital

## Streams

- Large
- Medium
- Small
- Ephemeral
- Contour Line
- Section Line

123°23'30"W



Leave Areas

Bio Diversity

Leave Tree Requirement (LTR)

Stream Buffer and LTR

Scenic Buffer

Special Site

Stream Buffer

Unit ID

123°23'0"W

5560

Gross Acres:

101

Wildlife Tree

Created by: RGS

Mar 02, 2007

Forest Capital, LLC does not warrant the accuracy or completeness of this product. The reader is responsible for correct use and interpretation.





# PROJECT ORDER MAP

## Switch Hitter

Scale in Feet

0 1,000 2,000



123°32'0"W

123°31'30"W

123°31'0"W

44°55'30"N

44°55'30"

44°55'0"N

44°55'0"N

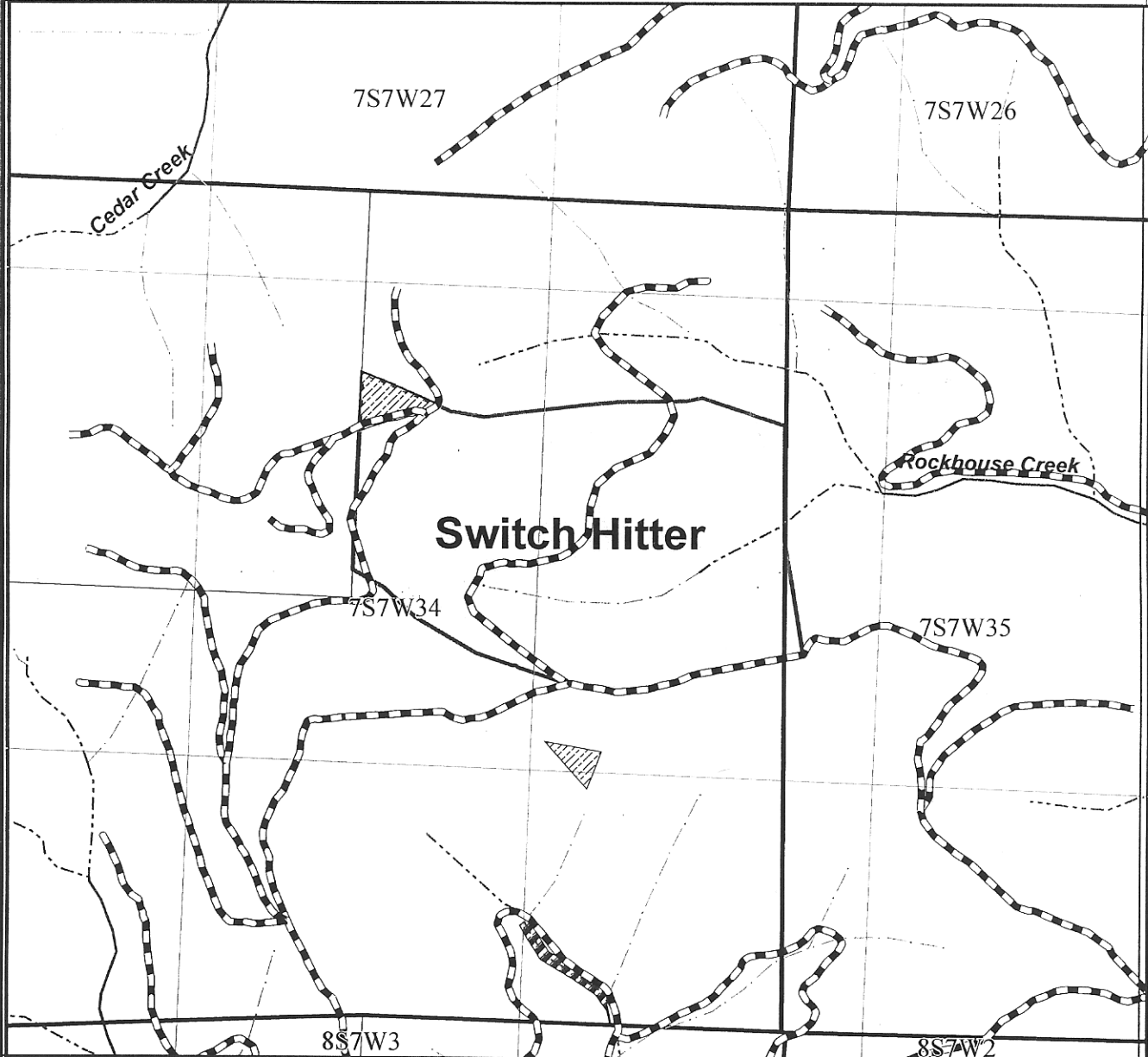

123°32'0"W

123°31'30"W

123°31'0"W

- Road Activities**
- Existing- No Activity
  - New Construction
  - Re-Construction
  - End Haul
  - Rocking Only

**Road Features**

- Culvert
- Landing
- Waste Area



Unit Area



Forest Capital

**Streams**

- Large
- Medium
- Small
- Ephemeral
- Contour Line
- Section Line

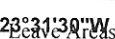

Bio Diversity

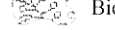

Leave Tree Requirement (LTR)



Stream Buffer and LTR



Scenic Buffer



Special Site



Stream Buffer

- Wildlife Tree

**Unit ID** 5515

**Gross Acres:** 100

Created by: RGS

Mar 02, 2007

Forest Capital, LLC does not warrant the accuracy or completeness of this product. The reader is responsible for correct use and interpretation.