

State of Oregon
Department of Forestry / Department of Revenue
Notification number: 2009-781-50188 [78129157] 09 Scotchbroom Erad Fish Creek

* REPRINT *

Attached is the processed information from the Notification of Operation and/or Application for Permits.
Please review this information and retain for future reference.

- Notice is given to the State Forester that an operation will be conducted on the lands described herein (ORS 527.670).
- A permit to operate power driven machinery is issued for the lands described herein (ORS 477.625)

Roadside spray manual application with CP3 backpack or slip in truck mounted sprayer

I. WHERE TIMBER HARVESTING IS PART OF THE PROPOSED OPERATION:

A. NOTICE TO TIMBER OWNER: Party owning the harvested timber at the point it is first measured is shown in the section marked TIMBER OWNER and is responsible for payment of Oregon timber taxes.

B. NOTICE TO LAND OWNER: Party shown in the section marked LAND OWNER is responsible for reforestation of the site if so required.

II. WRITTEN PLANS:

- A WRITTEN PLAN may be required before certain activities can commence on the Operation.

A WRITTEN PLAN may be required for the situations indicated by an below. A WRITTEN PLAN must be submitted or a WRITTEN WAIVER must be obtained from the State Forester before any portion of the operation may commence.

- Within 100 feet of a large lake or Type F or Type D stream.
[OAR 629-605-170(1)(a)]

- Within 300 feet of a wildlife resource site listed in the 1984 ODF/ODFW Cooperative Agreement. [OAR 629-605-170(1)(b)]

- Within 300 feet of any resource identified in the Divisions 645 or 665 of the administrative rules. [OAR 629-605-170(1)(c)]

- Within 300 feet of a state or federally listed threatened or endangered wildlife resource site. [OAR 629-605-170(1)(d)]

Please contact the Oregon Department of Forestry forester named on the Unit Information sheet for further information on requirements that may be necessary to meet before any activity/operation begins.

Signed by Mike Emmons - representing the Land owner.

District: **Western Lane**
Office: **Veneta**
County: **Lane**
WOSTOT:

Received by ODF on March 23, 2009 by mail

15 DAY WAITING PERIOD REQUIRED

***** N O T I C E *****

The State Forester has determined that the following items requiring your attention are located within or adjacent to your operation area:

- Concerns - Resources - Water

See Unit Information on subsequent pages for details.

Operator:
Mike Emmons
Seneca Jones Timber Co, L P
P O Box 10265
Eugene, OR 97440
Phone: (541) 461-6245

Land owner:
Mike Emmons
Seneca Jones Timber Co, L P
P O Box 10265
Eugene, OR 97440
Phone: (541) 461-6245

Timber owner:

None located
Phone: None located

Marvin D. Brown Dave Lorenz
State Forester District Forester

Unit: 1

Status: Active

Stewardship Forester: Paul Clements

Phone number: (541) 935-2283

Start date: 5/15/2009

End date: 12/31/2009

Site conditions: Lake or Stream within 100 ft
 Slope of 0% to 35%
 No mass soil movement

FP = L

FPA = H

Acres: Feet: 18480

Estimated harvest: MBF

Activity: Herbicide Application

Methods: Ground/Manual

Brand name: 1-2% Forestry Garlon

Carrier: Water

Additives: 2% Methylated Seed Oil

App rate: 10 Gal Per Acre With CP3 Bac

Other information: 7 OZ Milestone VM

Sc	Twp	Rge	Government lot	N E		N W				S W				S E				Harv tax	Reg use
				n	s	n	n	s	s	n	n	s	s	n	n	s	s		
30	16S	07W			X	X		X	X	X	X	X	X		X	X	X		WT1

Special Concerns

Code Description Comment

SH Scenic Highway 36

Water Concern Information

Description	Classification	Rule
Lake Creek	F str-lg Unknown class Mand written plan	170a
Fish Creek	F str-lg Mand written plan	170a



**SENECA JONES
TIMBER COMPANY**

Twp. 16S Rng. 07W Sec 30

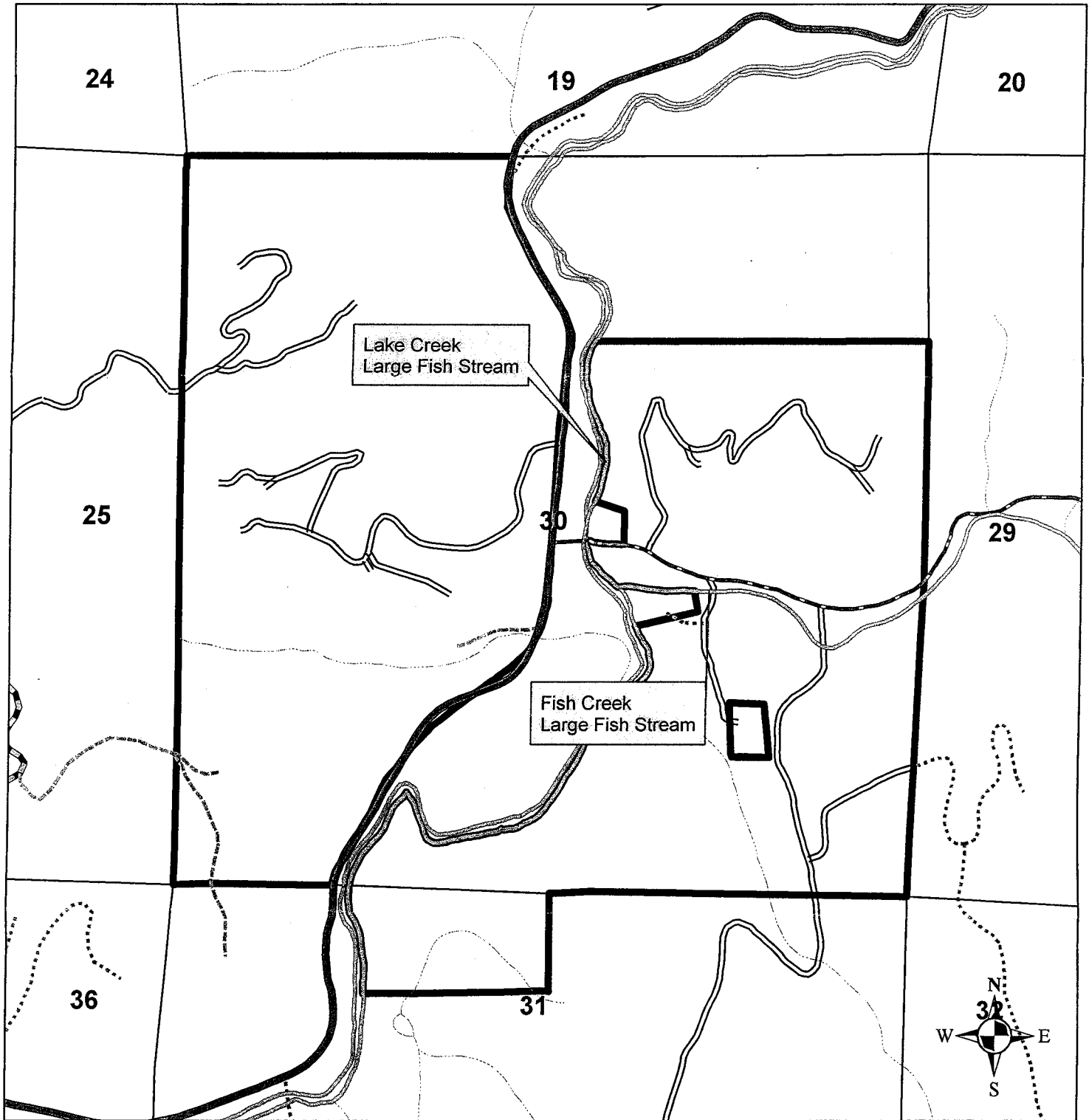

Unit #1

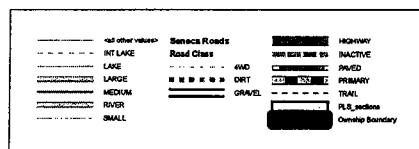

**Fish Creek
3.5 Miles
Roadside Spray**