

State of Oregon
Department of Forestry / Department of Revenue
Notification number: 2009-781-50206 [78129175]

Attached is the processed information from the Notification of Operation and/or Application for Permits.

Please review this information and retain for future reference.

- Notice is given to the State Forester that an operation will be conducted on the lands described herein (ORS 527.670).

- A permit to operate power driven machinery is issued for the lands described herein (ORS 477.625)

Vick Road 09 C

I. WHERE TIMBER HARVESTING IS PART OF THE PROPOSED OPERATION:

A. NOTICE TO TIMBER OWNER: Party owning the harvested timber at the point it is first measured is shown in the section marked TIMBER OWNER and is responsible for payment of Oregon timber taxes.

B. NOTICE TO LAND OWNER: Party shown in the section marked LAND OWNER is responsible for reforestation of the site if so required.

II. WRITTEN PLANS:

- A WRITTEN PLAN may be required before certain activities can commence on the Operation.

A WRITTEN PLAN may be required for the situations indicated by an below. A WRITTEN PLAN must be submitted or a WRITTEN WAIVER must be obtained from the State Forester before any portion of the operation may commence.

- Within 100 feet of a large lake or Type F or Type D stream. [OAR 629-605-170(1)(a)]

- Within 300 feet of a wildlife resource site listed in the 1984 ODF/ODFW Cooperative Agreement. [OAR 629-605-170(1)(b)]

- Within 300 feet of any resource identified in the Divisions 645 or 665 of the administrative rules. [OAR 629-605-170(1)(c)]

- Within 300 feet of a state or federally listed threatened or endangered wildlife resource site. [OAR 629-605-170(1)(d)]

Please contact the Oregon Department of Forestry forester named on the Unit Information sheet for further information on requirements that may be necessary to meet before any activity/operation begins.

Signed by Donald Irons - representing the Land owner.

District: **Western Lane**

Office: **Veneta**

County: **Lane**

WOSTOT:

Received by ODF on April 1, 2009 by fax

15 DAY WAITING PERIOD REQUIRED

******* NOTICE *******

The State Forester has determined that the following items requiring your attention are located within or adjacent to your operation area:

- Concerns - Resources - Water

See Unit Information on subsequent pages for details.

Operator:

Plum Creek Timber Lands LP

P O Box 216

Toledo, OR 97391

Phone: (541) 336-3819

Land owner:

Plum Creek Timber Lands LP

P O Box 216

Toledo, OR 97391

Phone: (541) 336-3819

Timber owner:

Plum Creek Timber Lands LP

P O Box 216

Toledo, OR 97391

Phone: (541) 336-6224

Marvin D. Brown

State Forester

Dave Lorenz

District Forester

(Subscriber)

Unit: 1

Status: Active

Stewardship Forester: Paul Clements

Phone number: (541) 935-2283

Start date: 4/15/2009 End date: 12/31/2009

Site conditions: Lake or Stream within 100 ft
Slope of 0% to 35%
No mass soil movement

FP = L

FPA = H

Acres: 75 Feet: Estimated harvest: MBF

Activity: Herbicide Application

Methods: Aerial Ground Pressurized Broadcast

Brand name: Glyphosate Sulfameturon Methyl MSO

Carrier: None

Additives: None

App rate: None

Other information: Hexazinone Clopyralid Tryclopypyr

Sc	Twp	Rge	Government lot	N E				N W				S W				S E				Harv tax	Reg use
				n	n	s	s	n	n	s	s	n	n	s	s	n	n	s	s		
				e	w	w	e	e	w	w	e	e	w	w	e	e	w	w	e		
20	16S	06W						X	X	X	X	X	X	X	X						WT1

Special Concerns

Code Description Comment

SH Scenic Highway 36

Water Concern Information

Description	Classification	Rule
Long Tom River	F str-lg-med-sm-dom use Unknown class Mand written plan	170a

Written Plan

UNIT: 2009 Spring Spray

LANDOWNER: Plum Creek

OPERATOR: Western Helicopter

PLANNED OPERATION: A spray operation is scheduled for the spring of 2009. The spray is designed to reduce the competing vegetation in the plantation in order to allow the trees to live and grow into a thriving productive stand. The project will be completed using a helicopter and ground crew. Plum Creek will provide a representative to review and explain all portions of this plan to the operator before they begin work.

TARGET VEGETATION: Grass, herbaceous and other competing plant species.

PROTECTED RESOURCES: See attached unit maps for protected streams and water systems.

PROTECTION MEASURES: The following measures will be taken to protect all Fish, Domestic, non-fish, Small, Medium and Large streams as well as significant wetlands:

1. Spray will not be directly applied to any small non-fish streams by helicopter or ground crew. At minimum a 60-foot buffer will be left unsprayed by the helicopter along Fish, Domestic, Medium and Large non-fish streams as well as significant wetlands unless cutting boundaries are farther than 60 feet then the spray boundary will be on the outside of the cutting boundary.
2. At a minimum a 10-foot buffer will be left unsprayed by ground crews along all Fish, Domestic, Medium and Large streams as well as significant wetlands unless cutting boundaries are farther than 60 feet then the spray boundary will be on the outside of the cutting boundary.
3. Spray will not be directly applied to any small non-fish streams by helicopter or ground crew.
4. Operations will not be performed if wind direction or velocity is such that protected resources are in danger of contamination
5. All operations will be performed in accordance with the Oregon Forest Practices Act as they relate to the use and handling of chemicals.

 4-1-09
Donald Irons
Sr. Resource Forester

4/1/2009
9:32 AM

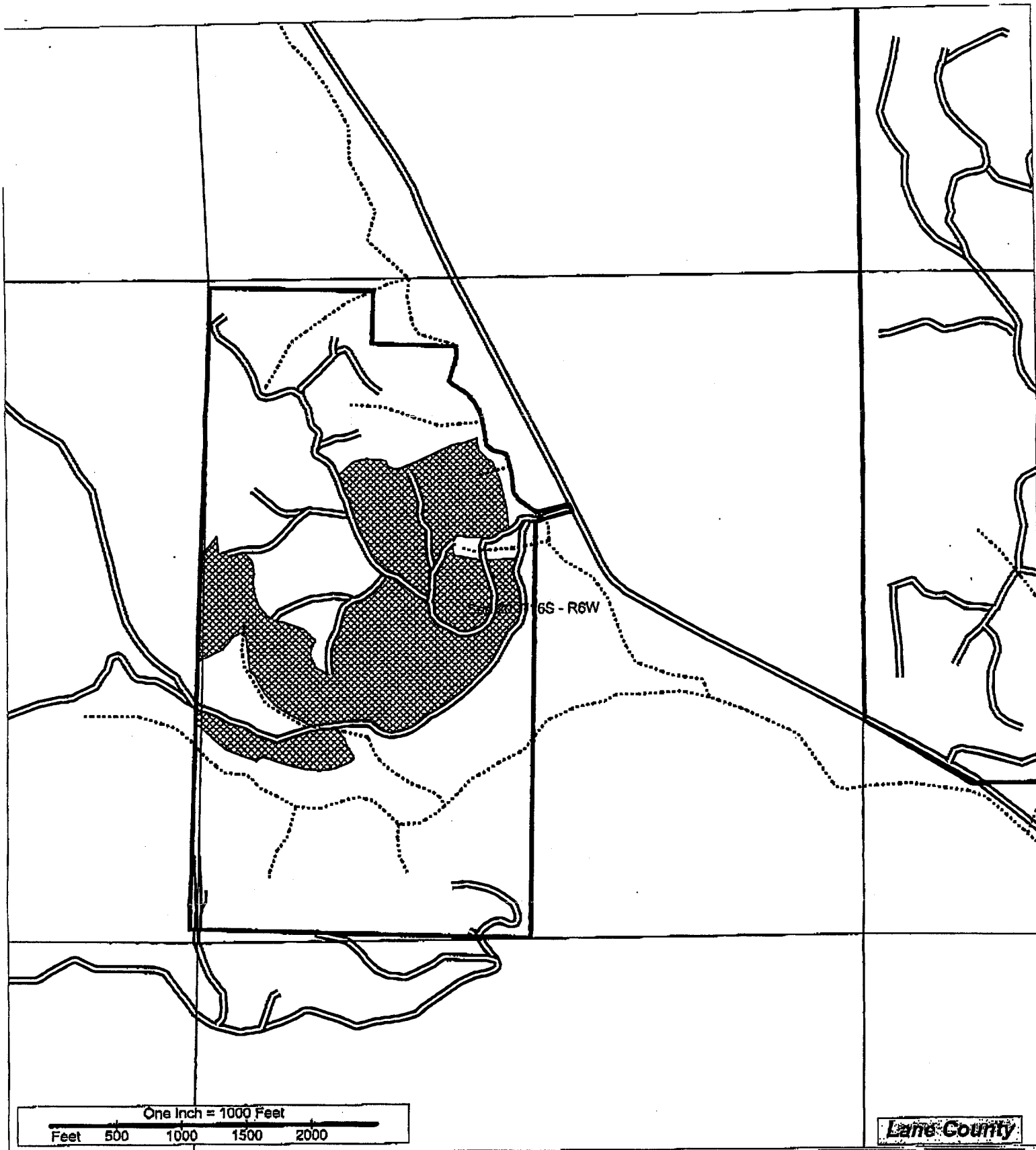

Vick Road
Acres:75
Section:20
Legal: T16S- R6W

- STREAM
- PLUM CREEK
- == ROAD
- ▣ TREATMENT AREA

