



State of Oregon
Department of Forestry - Department of Revenue
Notification Number: 2010-781-00362
Timber Sale: 10 Scotchbroom Eradification FishCr



Attached is the processed information from the Notification of Operation/Application for Permit signed by Mike Emmons representing the Land Owner, and received by Department of Forestry on March 22, 2010. Please review this information and retain for future reference.

Notices and Permits

Notice is given to the State Forester that an operation will be conducted on the lands described herein.

A permit to use fire or operate power driven machinery is issued for the land described herein.

SF Comments: Manual application with CP3 backpack or slip-in truck mounted sprayer.

LEGAL NOTICE

The following section provides legal notification of the requirement to submit a written plan before certain portions of this Operation may begin. The requirements are indicated below:

Based on information provided by the applicant, no Written Plans were required at the time this notice was sent. Written Plans may be required at a future date if new protected resources or other information is discovered.

Notification 15 Day Waiting Period:

This Operation is subject to the 15 day Waiting Period.

Operator:

Mike Emmons
Seneca Jones Timber Company
P.O. Box 10265
Eugene, OR 97440
(541)461-6245

Fire Contact:

Ted Reiss
(541) 607-7299

Land Owner:

Mike Emmons
Seneca Jones Timber Company
P.O. Box 10265
Eugene, OR 97440
(541)461-6245

Timber Owner:

District: Western Lane

Office: Veneta Unit

County: Lane

(Subscriber Copy)

Marvin D. Brown, State Forester
David Lorenz, District Forester

Unit Information - Notification: 201078100362

Unit 1 of 1 Start:05/15/10 End:12/31/10

Status: Active

Stewardship Forester: Paul R. Clements

Site Conditions Waters: Lake or stream Within 100 feet.

Soils: No mass soil movement.

Slope: 0% to 35%.

SF Phone Number: (541)935-2283

Priorities: Fire: Low FPA: High

Twp	Rge	Sec	NE	NW	NE SW	SE	NE	NW	NW SW	SE	NE	NW	SW SW	SE	NE	NW	SE SW	SE	Government Lot Number	Tax Lot No.	Reg Use
16S	07W	30	<input type="checkbox"/>	<input type="checkbox"/>	<input checked="" type="checkbox"/>	<input checked="" type="checkbox"/>	<input type="checkbox"/>	<input checked="" type="checkbox"/>	<input checked="" type="checkbox"/>	<input checked="" type="checkbox"/>	<input checked="" type="checkbox"/>	<input checked="" type="checkbox"/>	<input checked="" type="checkbox"/>	<input type="checkbox"/>	<input checked="" type="checkbox"/>	<input checked="" type="checkbox"/>	<input type="checkbox"/>	<input checked="" type="checkbox"/>			WT 1

Unit Activity Summary : Est. Harvest 0 Acres**0 Feet****0 MBF**

Nonstatutory Written Plan Not Required.

Statutory Written Plan Not Required.

Activity	Method	Acres	Feet	MBF	Comment
4a - Herbicide Application	Gr,Ma	0	0	0	, AppRate: 1-2 percent, Forestry Garlon, , AppRate: 2 percent, Methylated Seed Oil, , AppRate: 7 ounces, Milestone VM, , Carrier: Water, AppRate: 10 gal/ac, , 3.5 miles of roadside spray

Resource Name

Lake Creek

Resource Description

Lake Creek: Large Type F, Small Type F Stream(s), Small Unknown

Fish Creek

Fish Creek: Large Type F Stream(s), Small Unknown

No Threatened or Endangered Species Found.

No Special Concerns Found.

Subscribers:

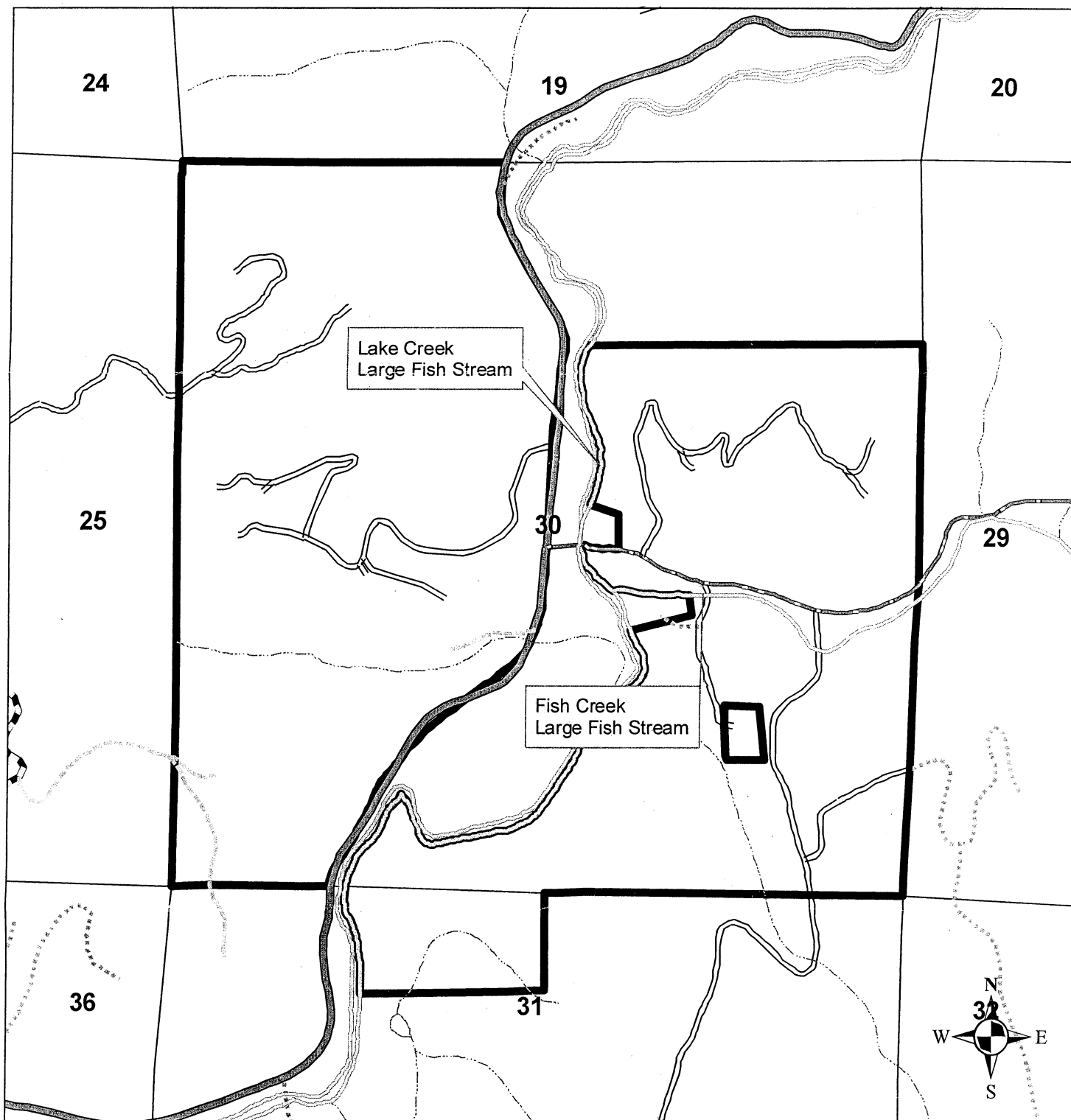
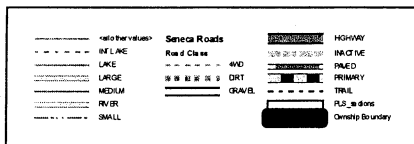
Unit #1

**Fish Creek
3.5 Miles
Roadside Spray**

March 22, 2010

ODF Western Lane Protection District

Re: Written Plan for 2010 operations

Seneca Jones Timber Company herein submits a written plan for operations near a resource protection area. In accordance with the Oregon Forest Practices Act, these operations shall provide equal or better protection for the environment while enhancing effectiveness of forest management operations and achievement of the desired future condition. This written plan is based on the following information:

Type of Operation:	Manual Herbicide Application
Unit:	<u>Fish Creek T16S, R7W, Section 30 3.5 Miles</u>
Reason for Plan:	Operation within 100' of type 'F' class stream

Information:

As seen on the attached map, Fish Creek flows adjacent and parallel to Fish Creek road system. Also a gravel road crosses over Fish Creek. This stream is classed as Large 'F' or fish-bearing stream, in this area. Seneca plans to apply herbicides only in the treatment area shown on the attached map, but no closer than 10 feet. This will allow the buffer to protect the streams from any potential drift or error of application and maintain shade on the watercourse. This release operation will utilize Garlon, and Surfactant Oil herbicides primarily for control of Scotch Broom and Black Berry.

The protection of these stream zones will be ensured by Seneca's continued dedication to the proper application of herbicides through the following practices. Prior to application a Seneca representative will relay the information included in this written plan to the applicator. This information will include a thorough review of the stream zone and the 10' no spray buffer zone as well as property line locations. Applicator will be instructed to utilize a batching area at least 100 feet from any water area. Prior to and during the application period the applicator will take continuous weather measurements to assess risk and continued plan success. These stream zone protection measures are consistent with best management practices and will not affect any of the required components of the riparian management zone.

In closing we believe these measures will benefit both the environment and the operations of Seneca Jones Timber Company. If there are any concerns or more appropriate measures to be considered, please telephone our office at 541.461-6245. Otherwise, we will anticipate your approval of this measure and proceed as indicated during our operations.

Sincerely,

MIKE L. EMMONS

Mike Emmons

Silvicultural Forester