



State of Oregon
Department of Forestry - Department of Revenue
Notification Number: 2011-781-00446
Timber Sale: 2011 Scothbroom Prog. Corwin Tract



Attached is the processed information from the Notification of Operation/Application for Permit signed by Mike L. Emmons representing the Land Owner, and received by Department of Forestry on June 1, 2011. Please review this information and retain for future reference.

Notices and Permits

Notice is given to the State Forester that an operation will be conducted on the lands described herein.

A permit to use fire or operate power driven machinery is issued for the land described herein.

SF Comments: Applicant Remarks: Manual Application with CP3 backpack or slip-in truck mounted sprayer.

LEGAL NOTICE

The following section provides legal notification of the requirement to submit a written plan before certain portions of this Operation may begin. The requirements are indicated below:

Based on information provided by the applicant, no Written Plans were required at the time this notice was sent. Written Plans may be required at a future date if new protected resources or other information is discovered.

Notification 15 Day Waiting Period:

This Operation is subject to the 15 day Waiting Period.

Operator:

Mike Emmons
Seneca Jones Timber Company
P.O. Box 10265
Eugene, OR 97440
(541) 689-1011

Fire Contact:

Ted Reiss
(541) 607-7299

Land Owner:

Mike Emmons
Seneca Jones Timber Company
P.O. Box 10265
Eugene, OR 97440
(541) 689-1011

Timber Owner:

District: Western Lane

Office: Veneta Unit

County: Lane

(Subscriber Copy)

Doug Decker, State Forester
Link Smith, Acting District Forester

Unit Information - Notification: 201178100446

Unit 1 of 1 Start: 06/15/11 End: 12/31/11

Status: Open

Stewardship Forester: Paul R. Clements

Site Conditions Waters: Lake or stream Within 100 feet.

Soils: No mass soil movement.

Slope: 0% to 35%.

SF Phone Number: (541)935-2283

Priorities: Fire: Low FPA: High

Twp	Rge	Sec	NE				NW				SW				SE				Government Lot Number	Tax Lot No.	Reg Use
			NE	NW	SW	SE	NE	NW	SW	SE	NE	NW	SW	SE	NE	NW	SW	SE			
18S	05W	21	<input type="checkbox"/>	<input type="checkbox"/>	<input type="checkbox"/>	<input type="checkbox"/>	<input type="checkbox"/>	<input type="checkbox"/>	<input type="checkbox"/>	<input type="checkbox"/>	<input type="checkbox"/>	<input type="checkbox"/>	<input type="checkbox"/>	<input type="checkbox"/>	<input type="checkbox"/>	<input type="checkbox"/>	<input checked="" type="checkbox"/>	<input checked="" type="checkbox"/>			WT-1
18S	05W	27	<input type="checkbox"/>	<input type="checkbox"/>	<input type="checkbox"/>	<input type="checkbox"/>	<input checked="" type="checkbox"/>	<input checked="" type="checkbox"/>	<input checked="" type="checkbox"/>	<input checked="" type="checkbox"/>	<input checked="" type="checkbox"/>	<input checked="" type="checkbox"/>	<input type="checkbox"/>	<input type="checkbox"/>	<input type="checkbox"/>	<input type="checkbox"/>	<input type="checkbox"/>	<input type="checkbox"/>			WT-1
18S	05W	28	<input checked="" type="checkbox"/>	<input checked="" type="checkbox"/>	<input checked="" type="checkbox"/>	<input checked="" type="checkbox"/>	<input checked="" type="checkbox"/>	<input checked="" type="checkbox"/>	<input checked="" type="checkbox"/>	<input checked="" type="checkbox"/>	<input checked="" type="checkbox"/>	<input checked="" type="checkbox"/>	<input type="checkbox"/>	<input type="checkbox"/>	<input checked="" type="checkbox"/>	<input checked="" type="checkbox"/>	<input checked="" type="checkbox"/>	<input type="checkbox"/>			WT-1
18S	05W	29	<input checked="" type="checkbox"/>	<input type="checkbox"/>	<input checked="" type="checkbox"/>	<input checked="" type="checkbox"/>	<input type="checkbox"/>	<input type="checkbox"/>	<input type="checkbox"/>	<input type="checkbox"/>	<input type="checkbox"/>	<input type="checkbox"/>	<input type="checkbox"/>	<input type="checkbox"/>	<input checked="" type="checkbox"/>	<input type="checkbox"/>	<input type="checkbox"/>	<input type="checkbox"/>			WT-1

Activity	Method	Acres	Feet	MBF	Comment
4a - Herbicide Application	Ground	5.10	0	0	Brand: Milestone VM, LV6; Common: Glyphosate; Additives: Methylated Seed Oil, Syl-Tac; Comments: Forestry Garlon

Resource Name

Tributaries to Coyote Creek

Resource Description

Tributaries to Coyote Creek: Small Unknown
 No Threatened or Endangered Species Found.
 No Special Concerns Found.

Subscribers:

**Seneca Jones
Timber Company**

Twp.18S Rng. 05W Sec 21,27,28,29

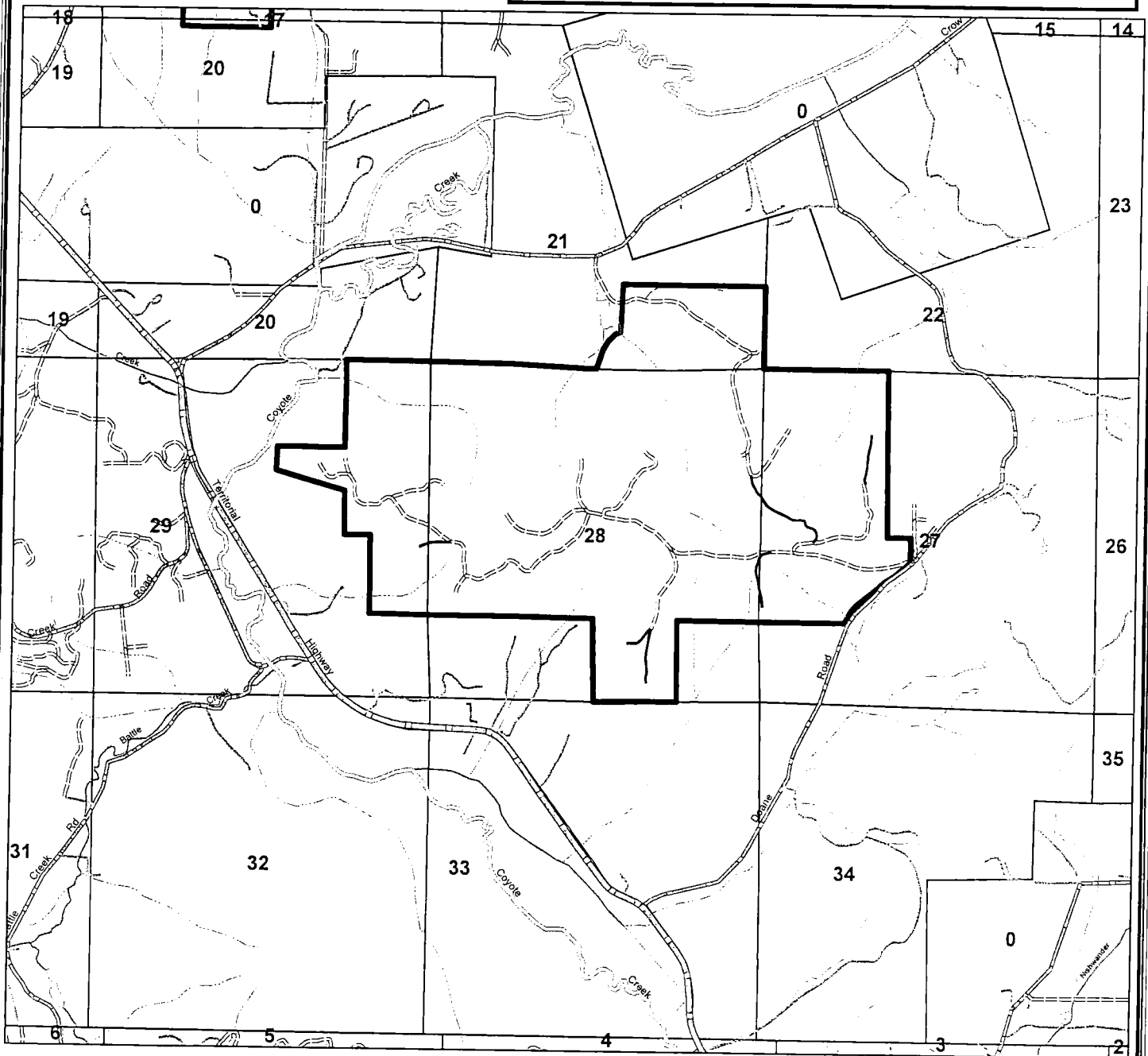

1 inch equals 2,307 feet



OWNERSHIP	<all other values>	ALL OTHER ROADS
INT LAKE	NO CLASS	TRAIL
LAKE	DIRT	GRAVEL
LARGE	DIVIDED	HIGHWAY
MEDIUM	PAVED	
RIVER		
SMALL		

Corwin Tract
5.1 Miles
Roadside Scotch broom

Comments: **Unit #1**