



State of Oregon  
Department of Forestry - Department of Revenue  
Notification Number: 2012-771-00433  
Timber Sale: Finn Rock Road Spray



Attached is the processed information from the Notification of Operation/Application for Permit signed by Toby Eck representing the Land Owner, and received by Department of Forestry on May 29, 2012. Please review this information and retain for future reference.

**Notices and Permits**

Notice is given to the State Forester that an operation will be conducted on the lands described herein.

A permit to use fire or operate power driven machinery is issued for the land described herein.

**SF Comments:** No spraying within 100 feet of type F & D waters.

A written plan is required before operating within 100' of a type F stream. Follow manufactures label instructions.

**LEGAL NOTICE**

The following section provides legal notification of the requirement to submit a written plan before certain portions of this Operation may begin. The requirements are indicated below:

Based on information provided by the applicant, no Written Plans were required at the time this notice was sent. Written Plans may be required at a future date if new protected resources or other information is discovered.

**Notification 15 Day Waiting Period:**

This Operation is subject to the 15 day Waiting Period. A waiver was requested and was denied.

**Operator:**

Rosboro LLC  
P.O. Box 20  
Springfield, OR 97477  
(541) 746-8411

**Fire Contact:**

Toby Eck  
(541) 746-8411

**Land Owner:**

Rosboro LLC  
P.O. Box 20  
Springfield, OR 97477  
(541) 746-8411

**Timber Owner:**

Not Applicable

District: South Cascade

Office: Springfield Unit

County: Lane

(Subscriber Copy)

**Doug Decker, State Forester**  
**Greg Wagenblast, District Forester**

**Unit Information - Notification: 201277100433**  
Unit 1 of 1 Start: 05/01/12 End: 12/31/12  
Status: Open  
Stewardship Forester: Marvin Vetter

**Site Conditions** Waters: Lake or stream Within 100 feet.  
Soils: No mass soil movement.  
Slope: 0% to 35%.  
SF Phone Number: (541)726-3588

Priorities: Fire: Low FPA: High

Twp	Rge	Sec	NE				NW				SW				SE				Government Lot Number	Tax Lot No.	Reg Use
			NE	NW	SW	SE	NE	NW	SW	SE	NE	NW	SW	SE	NE	NW	SW	SE			
16S	04E	29	<input type="checkbox"/>	<input type="checkbox"/>	<input type="checkbox"/>	<input type="checkbox"/>	<input type="checkbox"/>	<input type="checkbox"/>	<input type="checkbox"/>	<input type="checkbox"/>	<input checked="" type="checkbox"/>	<input checked="" type="checkbox"/>	<input checked="" type="checkbox"/>	<input checked="" type="checkbox"/>	<input checked="" type="checkbox"/>	<input checked="" type="checkbox"/>	<input checked="" type="checkbox"/>	<input checked="" type="checkbox"/>			EL-1
16S	04E	31	<input checked="" type="checkbox"/>	<input checked="" type="checkbox"/>	<input checked="" type="checkbox"/>	<input checked="" type="checkbox"/>	<input checked="" type="checkbox"/>	<input checked="" type="checkbox"/>	<input checked="" type="checkbox"/>	<input checked="" type="checkbox"/>	<input checked="" type="checkbox"/>	<input checked="" type="checkbox"/>	<input checked="" type="checkbox"/>	<input checked="" type="checkbox"/>	<input checked="" type="checkbox"/>	<input checked="" type="checkbox"/>	<input checked="" type="checkbox"/>	<input checked="" type="checkbox"/>			EL-1
17S	03E	2	<input type="checkbox"/>	<input type="checkbox"/>	<input type="checkbox"/>	<input type="checkbox"/>	<input type="checkbox"/>	<input type="checkbox"/>	<input type="checkbox"/>	<input type="checkbox"/>	<input type="checkbox"/>	<input type="checkbox"/>	<input type="checkbox"/>	<input type="checkbox"/>	<input checked="" type="checkbox"/>	<input checked="" type="checkbox"/>	<input checked="" type="checkbox"/>	<input checked="" type="checkbox"/>			EL-1
17S	03E	11	<input type="checkbox"/>	<input type="checkbox"/>	<input type="checkbox"/>	<input type="checkbox"/>	<input checked="" type="checkbox"/>	<input type="checkbox"/>	<input checked="" type="checkbox"/>	<input type="checkbox"/>	<input type="checkbox"/>	<input checked="" type="checkbox"/>	<input checked="" type="checkbox"/>	<input type="checkbox"/>	<input type="checkbox"/>	<input type="checkbox"/>	<input type="checkbox"/>	<input type="checkbox"/>			EL-1
17S	04E	5	<input type="checkbox"/>	<input type="checkbox"/>	<input type="checkbox"/>	<input checked="" type="checkbox"/>	<input checked="" type="checkbox"/>	<input checked="" type="checkbox"/>	<input checked="" type="checkbox"/>	<input checked="" type="checkbox"/>	<input checked="" type="checkbox"/>	<input checked="" type="checkbox"/>	<input checked="" type="checkbox"/>	<input checked="" type="checkbox"/>	<input checked="" type="checkbox"/>	<input checked="" type="checkbox"/>	<input checked="" type="checkbox"/>	<input checked="" type="checkbox"/>			EL-1
17S	04E	21	<input checked="" type="checkbox"/>	<input checked="" type="checkbox"/>	<input checked="" type="checkbox"/>	<input checked="" type="checkbox"/>	<input checked="" type="checkbox"/>	<input checked="" type="checkbox"/>	<input checked="" type="checkbox"/>	<input checked="" type="checkbox"/>	<input checked="" type="checkbox"/>	<input checked="" type="checkbox"/>	<input checked="" type="checkbox"/>	<input checked="" type="checkbox"/>	<input checked="" type="checkbox"/>	<input checked="" type="checkbox"/>	<input checked="" type="checkbox"/>	<input checked="" type="checkbox"/>			EL-1

Activity	Method	Acres	Feet	MBF	Comment
4a - Herbicide Application	Ground; Pressurized & Broadcast Application	500.00	0	0	Brand: Garlon 4, Glyphosate Herbicide

#### Resource Name

McKenzie River Trib  
Doris Crk  
McKenzie River  
Ennis Crk  
Quartz Crk  
Sugar Crk

#### Resource Description

McKenzie River Trib: Small Non-Fish Stream(s)  
Doris Crk: Small Non-Fish Stream(s)  
McKenzie River: Large Type F Stream(s)  
Ennis Crk: Large Type F Stream(s)  
Quartz Crk: Large Type F Stream(s)  
Sugar Crk: Medium Type F Stream(s)  
No Threatened or Endangered Species Found.  
No Special Concerns Found.

Subscribers: Forestland Dwellers

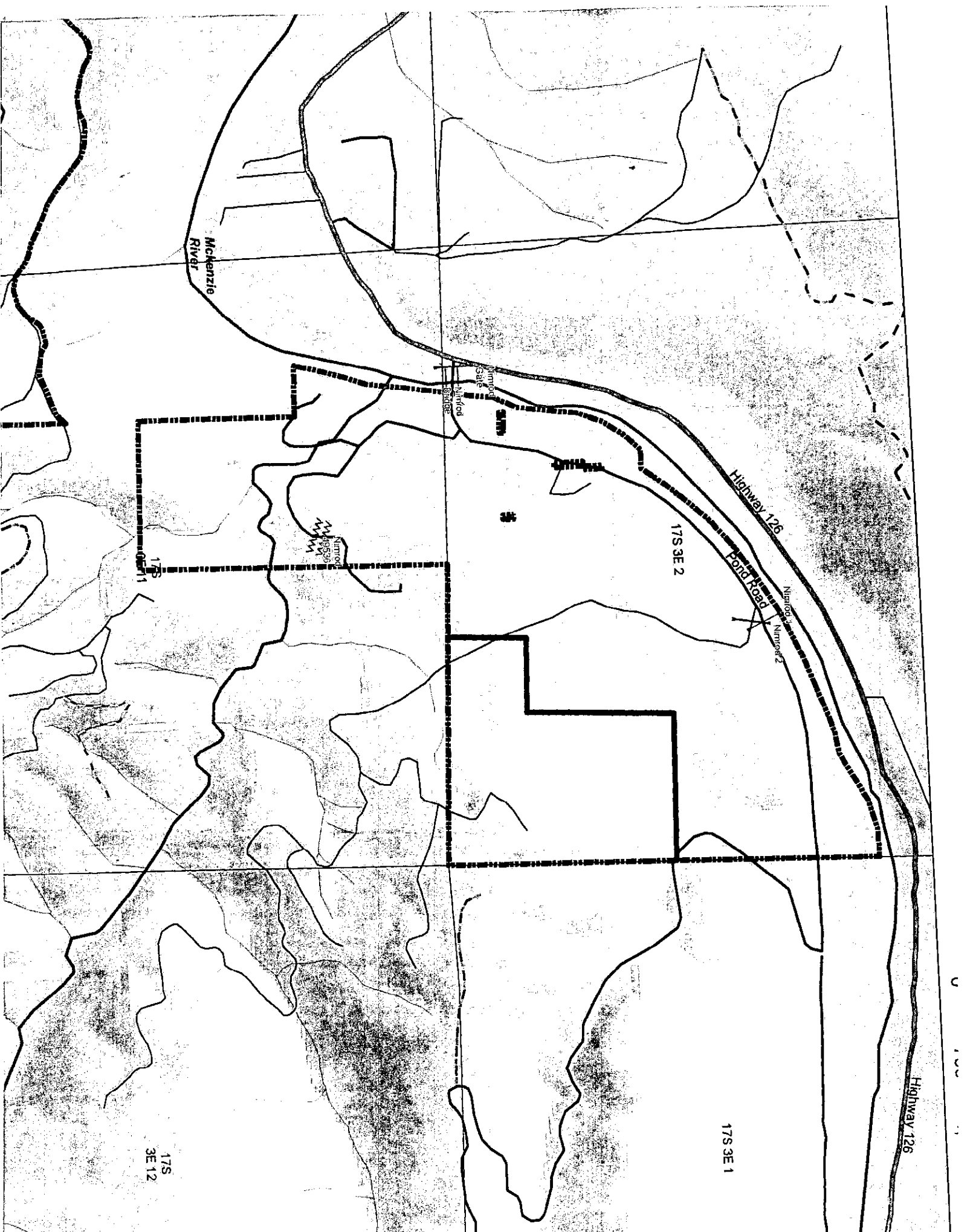

McKenzie  
River

Nimrod  
Gate  
Nimrod  
Gate

Highway 126

Pond Road

Nimrod 2  
Nimrod 2

17S 3E 2

17S  
3E 1

Nimrod  
19530

Highway 126

17S 3E 1

17S  
3E 12