

GIUSTINA LAND & TIMBER CO.

T 19S, R 1E, SEC. 20

1 INCH = 1000 FEET.

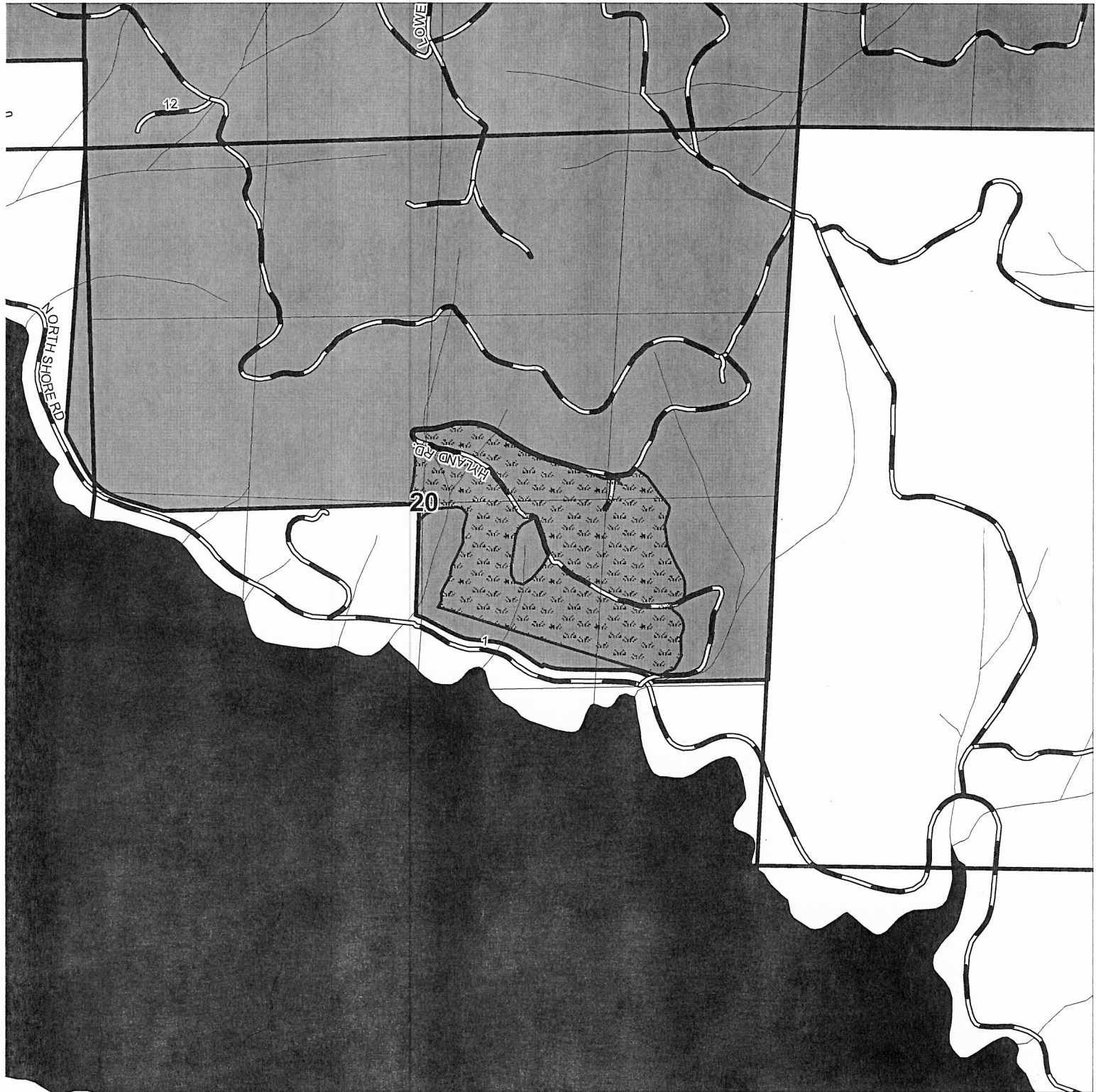

HYLAND SWITCHBACK

UNIT BOUNDARY

53 TOTAL ACRES.

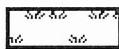

PRINTED: 3/9/2015

EXHIBIT A___ - OPERATIONAL AREA