



**State of Oregon**  
**Department of Forestry - Department of Revenue**  
**Notification Number: 2014-781-08724**  
**Operation Name: Opal Nelson**

This report is the processed information from the Notification of Operation/Application for Permit to Operate Power Driven Machinery submitted by NOAP Veneta and received by Department of Forestry on 12/22/2014.

You must wait at least 15 days after successful submittal of this notification before starting the activities in the notification (see OAR 629-605-0150(1)). You may contact the Stewardship Forester to request a waiver of the 15-day waiting period. The waiting period remains in effect unless you receive notice from the Stewardship Forester that it is waived.

**Notice and Permits**

**Notice is given to the State Forester that an operation will be conducted on the lands described herein.**

**A permit to use fire or operate power driven machinery is issued for the land described herein.**

**Oregon Department of Forestry Contact Information**

ODF District: Western Lane  
ODF Office: Veneta, Western Lane  
Phone: (541) 935-2283  
Stewardship Forester: Brian Peterson  
Email: BPETERSON@ODF.STATE.OR.US

**Stewardship Forester Formal Comments**

Report generated on 2/8/2015 by Oregon Department of Forestry  
Forest Activity Electronic Reporting and Notification System (FERNs)

Comment from: David Kjosness 12/22/2014

Per written request from Mike Jones on 12/22/14, this operation is continued into 2015 and is in effect a 2015 notification.

### **Landowner(s)**

Opal Nelson

2155 Bennett Creek Road  
Cottage Grove, Oregon 97424  
5419425877

### **Notice to Landowner(s)**

Reforestation may be required by the landowner if timber harvesting is part of the proposed operations.

On-site inspections may be conducted by Oregon Department of Forestry employees to ensure compliance with all laws and rules governing fire protection and forest practices on private land.

Land use conversion to non-forest use involves regulations administered by other state and local governments, which may apply to the future use or development of this site.

### **Notice to Operator(s)**

If you are conducting timber harvesting or road construction within 100 feet of overhead utility lines contact the local utility in accordance with ORS 757.805 - Oregon's Overhead Safety Act and OAR 437-007-0230 - Power Line Safeguards. Identification tags are located on each pole.

Call the Oregon Utility Notification Center at 811 at least 2 business days before starting timber harvesting, road construction, or any other activities involving excavation that may affect an underground utility line. The Center will coordinate with the appropriate utility companies to locate underground utility lines that may be affected by your activities.

## **Fire Emergency Contact**

Mike Capanna  
5417404795

## **LEGAL NOTICE**

**The following section provides legal notification of the requirement to submit a written plan before certain portions of this Operation may begin.**

### **Statutory Written Plan**

A Statutory Written Plan may be required before operation activities begin near the protected resources listed in the following Operation information page(s) or otherwise described to you by the Stewardship Forester, OAR 629-605-0170.

The Statutory Written Plan must describe in detail how the resource(s) will be protected during the operation. There is a waiting period for Statutory Written Plans that is separate from the notification waiting period. Contact the Stewardship Forester listed above for more information on Written Plans and waiting periods.

A portion or all of your operation(s) may be eligible for a waiver of the Statutory Written Plan requirement. Use the Resource Description information provided on the following Operation page(s) in conjunction with Technical Note #10 to determine your eligibility. Go to the following link or contact your Stewardship Forester for more information:

[http://www.oregon.gov/odf/PRIVATE\\_FORESTS/docs/20130816\\_Technote\\_Flowchart\\_Final.pdf](http://www.oregon.gov/odf/PRIVATE_FORESTS/docs/20130816_Technote_Flowchart_Final.pdf)

### **Non-Statutory Written Plan:**

A Non-Statutory Written Plan may be required for resources or conditions in or near this Operation as determined by the Stewardship Forester, OAR 626-605-0170(10).



**Unit: Opal Nelson: 41.3 acres**

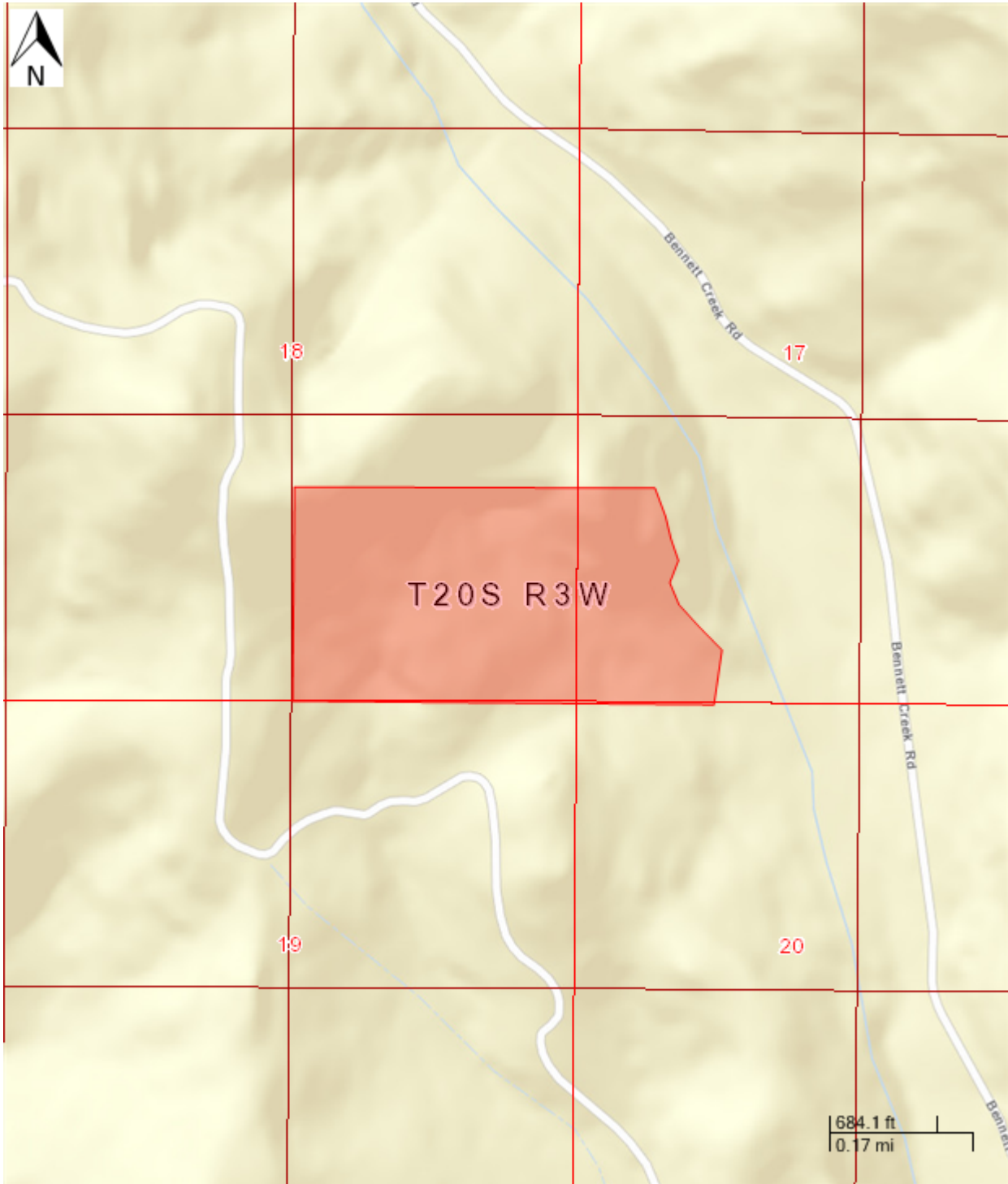

Report generated on 2/8/2015 by Oregon Department of Forestry  
Forest Activity Electronic Reporting and Notification System (FERNs)

**Unit: Opal Nelson - Activities**

**Activity: Herbicide Application (Unit)**

Quantity:

Start: 12/23/2014 End: 12/31/2015

Method(s): Ground - Manual spot application,

Chemical(s): glyphosate and Sulfomet Extra

Chemical Carrier(s): water

Chemical Additive(s):

Remarks: Sprayed at a rate of 10 gal/acre.

**Operator:**

Mike Capanna  
L & B Reforestation Inc  
PO Box 1599  
Philomath, Oregon 97370  
5419292840

**Unit: Opal Nelson - Statutory Written Plan**

A Statutory Written Plan may be required for the resources detected in or near this Unit if activities occur within:

<b>100 Feet of</b>	<b>300 Feet of</b>
: Small Type F Stream	

Please consult your Stewardship Forester about streams classified as Unknown.

## **Site Conditions**

### **Additional regulations may apply:**

Slope of steepest 1/3 area: 35.00 %.

## **Map of Operation**

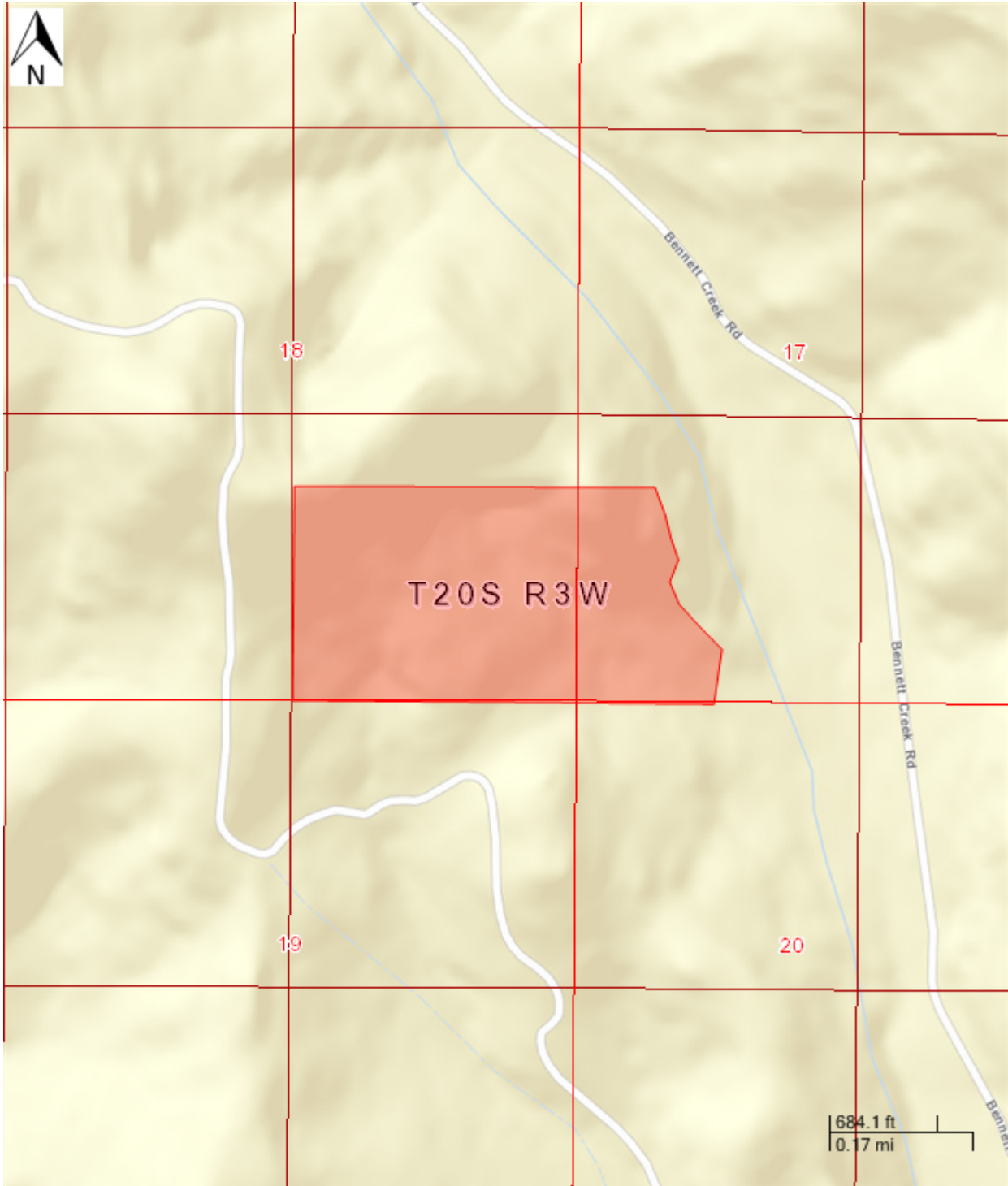

Report generated on 2/8/2015 by Oregon Department of Forestry  
Forest Activity Electronic Reporting and Notification System (FERNs)